

Received

FEB 12 2024

OWRD

ALLOCATION OF CONSERVED WATER APPLICATION TOWNSHIP 36S. & 37S. RANGE 2E, W.M.

JACKSON COUNTY, OREGON

Property Address:
4001 S F Little Butte CR RD
Eagle Point, OR

Assessor Map 362E33

CONSERVED WATER

C-17190 1869 100% to State
0.10 CFS / 36.3 AF
C-76175 1895 100% to State
0.064 CFS / 23.23 AF
C-83471 1918 100% to State
0.005 CFS / 3.35 AF

Base Map: Jackson County GIS mapping
adjusted to and oriented to survey
map 9709 (file 80-152 MP) over 7/7/2022
Google aerial photo & Oregon Map
aerial photo for assumed best fit

This map is not intended to provide
legal dimensions or locations of
property ownership lines

Scale
1" = 1320'

Location of water rights based on more recent
land surveys, aerial photos, decree/permit maps and
significant meandering of S.F. Little Butte Creek

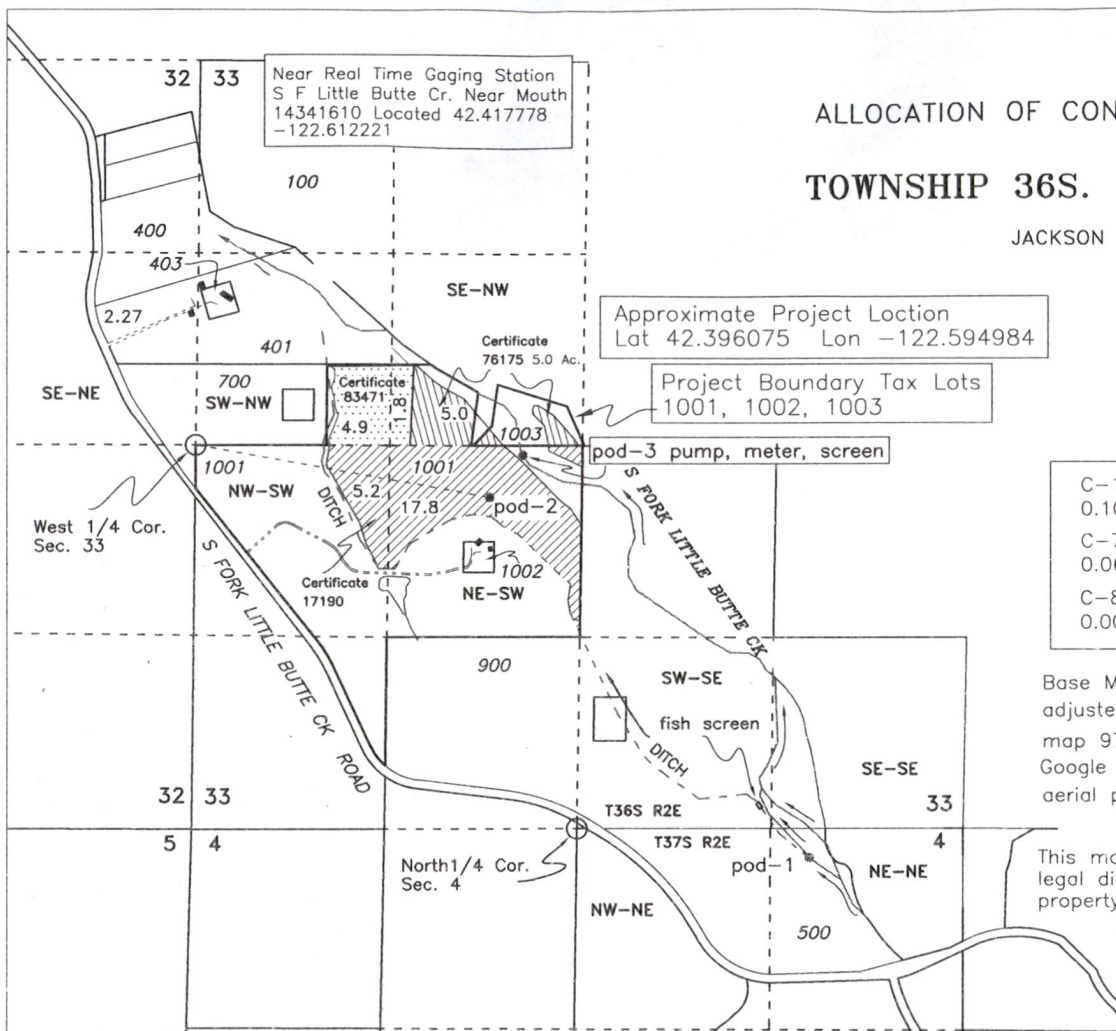

POD-1 (76175, 17190) NE/NE Section 4, 200 feet South & 1590 feet East from the North 1/4 Corner Section 4

POD-2 (83471) NE/SW, Section 33, South 79 Degrees 45 Minutes East, 2045 Feet from the West 1/4 Corner Section 33
Moving less than 500 feet to POD 3 to follow meandering stream [OAR 690-380-0010(d) ORS-540.510(6)]

POD-3 (Proposed) NE/SW, Section 33, 75 feet South & 2240 feet East from the West 1/4 Corner Section 33

Proposed Instream reach for Conserved Water - POD-1 to Mouth of the South Fork of Little Butte Creek



Certificate 76175 - 5.0 Acres Irrigation
1895 POD 1 to 3



Certificate 17190 - 23.0 Acres Irrigation
1869 (Clarified Location) POD 1 to 3

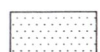

Certificate 83471 - 6.7 Acres Irrigation
1918 (Clarified Location) POD 2 to 3
(POD-1 used as POD-2 not at creek
due to creek meander)

• Buildings

SUPERIOR WATER RIGHT CONSULTING LLC.
245 GLENOAK LANE
GRANTS PASS, OR 97526
PHONE (541) 761-1057
normthewaterguy@charter.net

PREPARED FOR:

Elizabeth M. Sarthou, Trustee
P.O. BOX 191
Eagle Point, OR 97524-0191

2/7/2024 ned