

Document Path: Y:\0968 - Harper Farms - OWR - Consultation\Source - Figures\App - W.R. Transfer - Certificate 48157.aprx - mapsheet

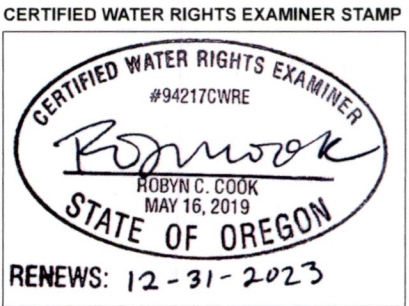

- LEGEND**
- Proposed Point of Appropriation (POA)
  - ⊙ Authorized Point of Appropriation (POA)
  - Conveyance
  - Peppermint Distillery
  - ▨ Place of Use (POU), to be Transferred
    - ▨ Authorized POU, Irrigation
    - ▨ Authorized POU, Supplemental Irrigation
  - ▨ Place of Use (POU), to Remain
    - ▨ Authorized POU, Irrigation
  - ⊞ Tax Lot
  - ⊞ Government Lot (GL)
  - ⊞ Donation Land Claim (DLC)
  - Railroad
  - ~ Watercourse
  - Waterbody

**Application for a Permanent Water Right Transfer for Certificate 48157 Harper Farms, Inc. Taylor Place Property**

**RECEIVED**  
**SEP 19 2022**  
**OWRD**

**Place of Use/Point of Appropriation Map**  
 Township 16 South, Range 4 West (W.M.)

**DISCLAIMER**  
 This map was prepared for the purpose of identifying the location of a water right only and it is not intended to provide legal dimensions or location of property ownership lines.

**LOCATION DESCRIPTIONS**  
**Well 1 (LANE 7845)** Located 96 feet South and 174 feet West from NW corner, Brice DLC 50, Township 16 South, Range 4 West (W.M.)  
**Well 2 (LANE 7876)** Located 716 feet South and 90 feet East from NW corner, Brice DLC 50, Township 16 South, Range 4 West (W.M.)  
**Well 3 (LANE 748)** Located 1369 feet South and 31 feet East from NW corner, Brice DLC 50, Township 16 South, Range 4 West (W.M.)  
**Well 4 (LANE 7875)** Located 1660 feet South and 905 feet East from NW corner, Brice DLC 50, Township 16 South, Range 4 West (W.M.)

**Well 5 (LANE 70681)** Located 1961 feet South and 1188 feet East from NW corner, Brice DLC 50, Township 16 South, Range 4 West (W.M.)  
**Well 6 (LANE 7844)** Located 528 feet North and 2579 feet East from SW corner, Section 9, Township 16 South, Range 4 West (W.M.)  
**Well 7 (LANE 8479)** Located 528 feet North and 2591 feet East from SW corner, Section 9, Township 16 South, Range 4 West (W.M.)  
**Well 8 (LANE 2125)** Located 1370 feet North and 870 feet East from SW corner, Section 9, Township 16 South, Range 4 West (W.M.)

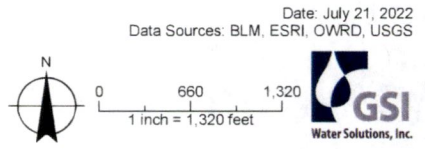

**RECEIVED**

**SEP 19 2022**

**OWRD**

## **Attachment B**

Application Map

---

Application for a Permanent Water Right Transfer - Certificate 48157

Harper Farms, Inc.