

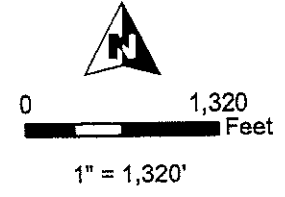

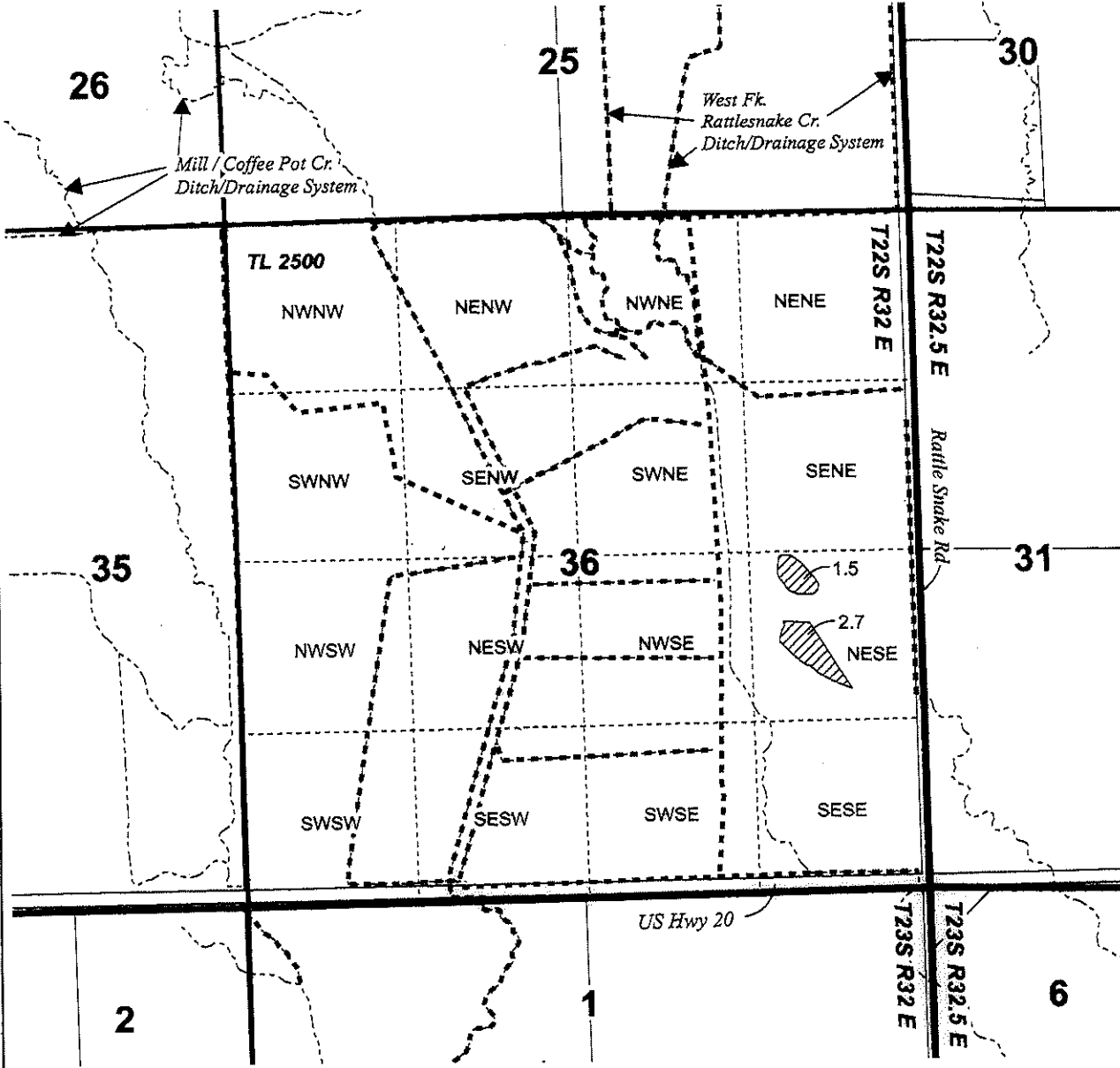

**T22S R32E, WM,  
HARNEY COUNTY, OR**



- Ditch
- Creek / Natural Drainage
-  POU IR / 1886 Priority
-  Township
-  Section
- Quarter Quarter
-  Tax Lot

PREPARED  
AUG 17 2023

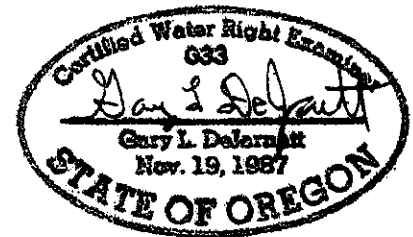

RENEWAL DATE 12/31/2023

**CLAIM OF BENEFICIAL USE MAP  
HARNEY HAY & CATTLE LLC**

T-14032 (C-14576 Portion, Source: West Fork Rattlesnake Creek 1886 Priority)

This map is not intended to provide legal dimensions or locations of property ownership lines.

Project #23014

Date: 7/11/2023

**WATER RIGHT SERVICES, LLC**  
PO BOX 1830, BEND, OR 97709  
**WWW.OREGONWATER.US** CCB # 197121  
johnshort@usa.com 541-389-2837