

Section 15, T41S, R11E, WM (Klamath County)

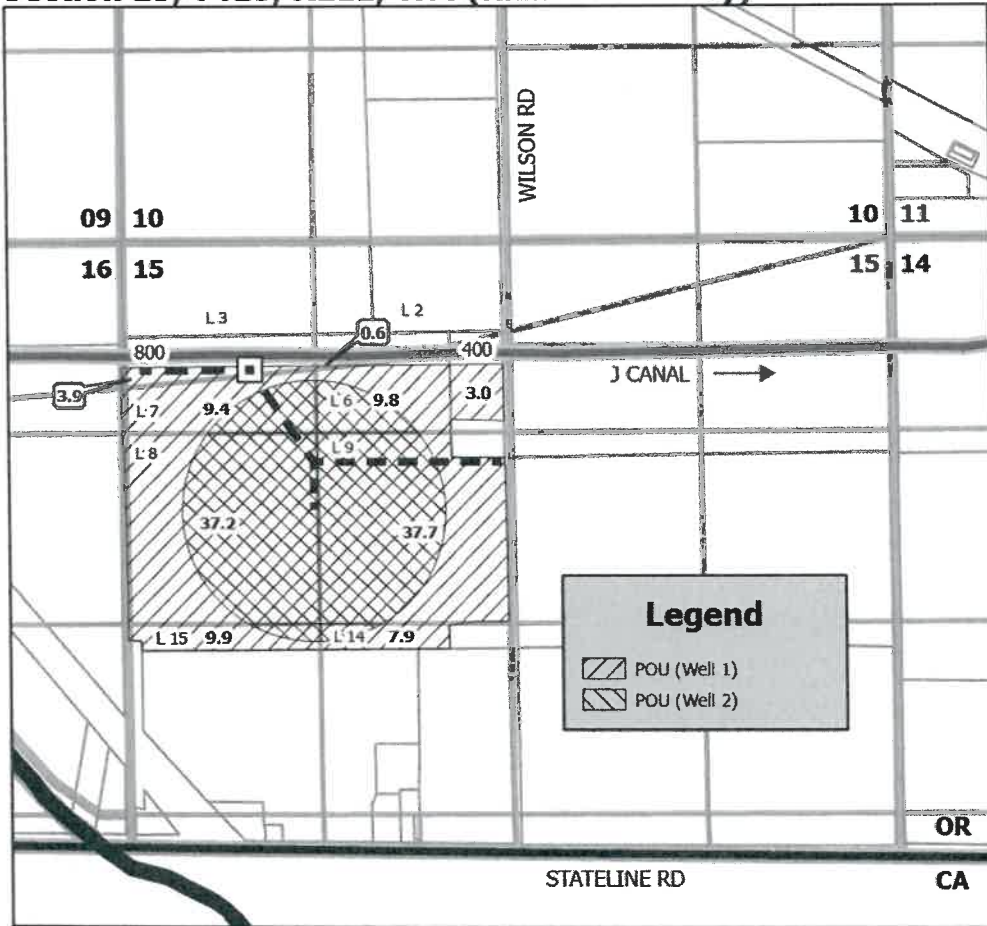

Points of Appropriation

POA 1. WELL 1
 Well Tag L-29475
 Well Log KLAM 53043
 SW NE, Section 7, T41S, R11E, WM
 1360 ft S and 1860 ft W
 from NE Corner of Section 7

POA 2. WELL 2
 Well Tag N/A
 Well Log KLAM 10518
 SW NW, Section 29, T40S, R10E, WM
 1420 ft S and 20 ft E
 from NW Corner of Section 29

Place of Use

SECTION 15	WELL 1	WELL 2
NE NW (L2)	0.6	
NE NW (L6)	9.8	3.8
NE NW (TL400)	3.0	
NW NW (L3)	3.9	
NW NW (L7)	9.4	4.2
SW NW (L8)	37.2	24.3
SE NW (L9)	37.7	22.65
NE SW (L14)	7.9	0.8
NW SW (L15)	9.9	0.9
TOTAL	119.4	56.65

WELL 1: SW NE, SECTION 7, T41S, R11E, WM

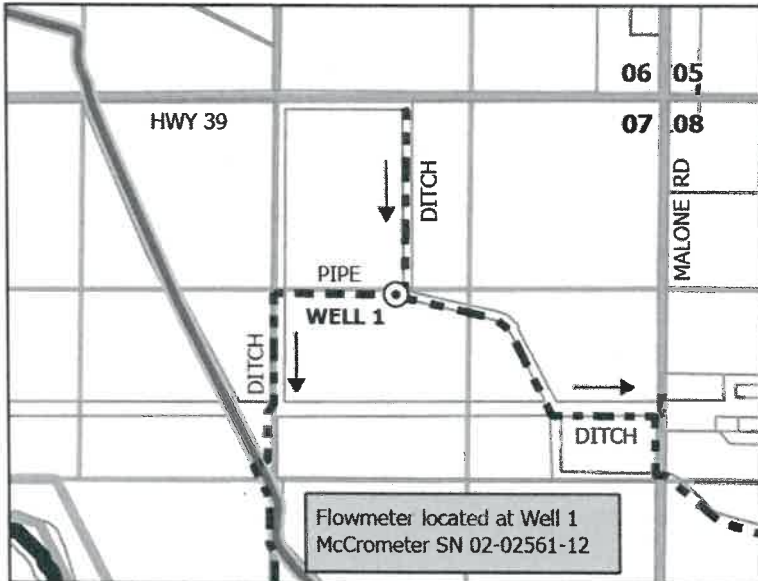

WELL 2: SW NW, SECTION 29, T40S, R10E, WM

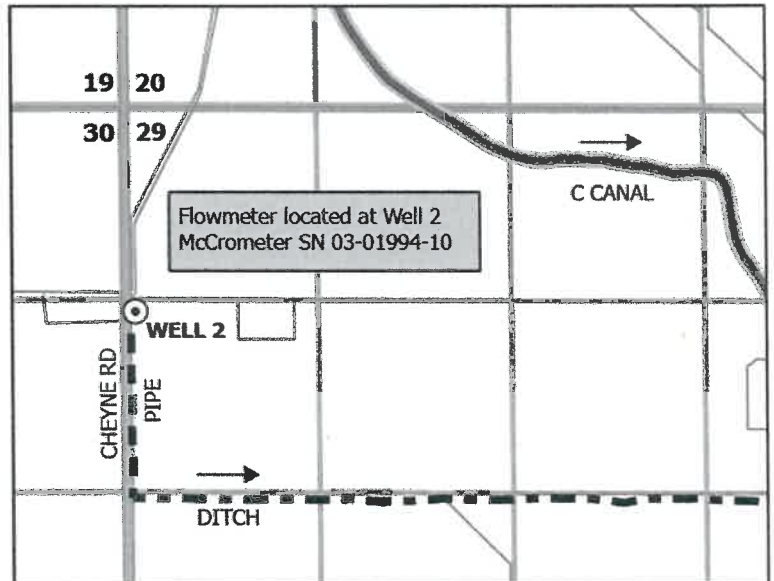

DISCLAIMER
 This map is not intended to provide legal dimensions or locations of property ownership lines.



0 330 660 1,320 US Feet

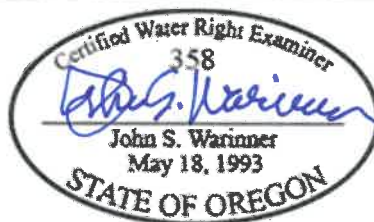

WATERSOLVING LLC
 johnw@watersolving.com
 (541) 815-4103 mobile

CLAIM OF BENEFICIAL USE MAP

APPLICATION G-16400
PERMIT G-18783

GREGORY DREW HEATON

Revised 2025-02-27