

S18 S17

S19 S20

T15S R10E, WM DESCHUTES COUNTY, OR

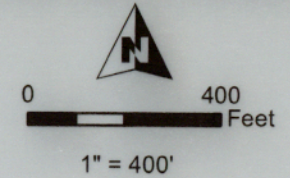

- Well
- Meter
- Pipeline
- POU Irrigation
- POU Storage
- Section
- Quarter Quarter
- Tax Lot

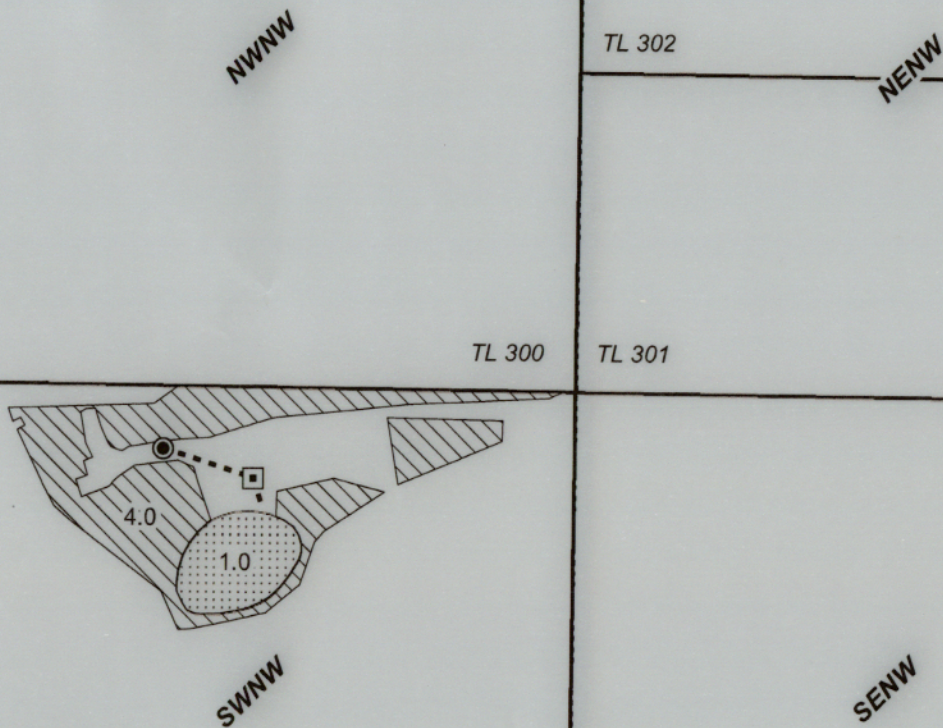

Well Location:
DESC 3127:
1200' N, 480' E of W 1/4 Cor Sec 20

Center of Pond Location:
1000' N, 640' E of W 1/4 Cor Sec 20

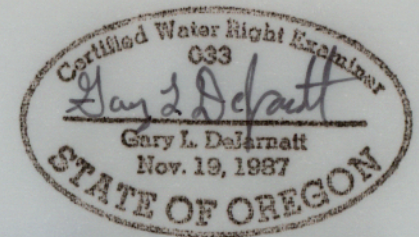

Received
SEP 23 2024
OWRD
RENEWAL DATE 12/31/2025



CLAIM OF BENEFICIAL USE MAP Schuepbach

Date: 7/18/2024

T-11879

PROJECT #24024

This map is not intended
to provide legal dimensions
or locations of property
ownership lines.

WATER RIGHT SERVICES, LLC
PO BOX 1830, BEND, OR 97709
WWW.OREGONWATER.US CCB # 197121
johnshort@usa.com 541-389-2837