

T.9S. R.4W., W.M

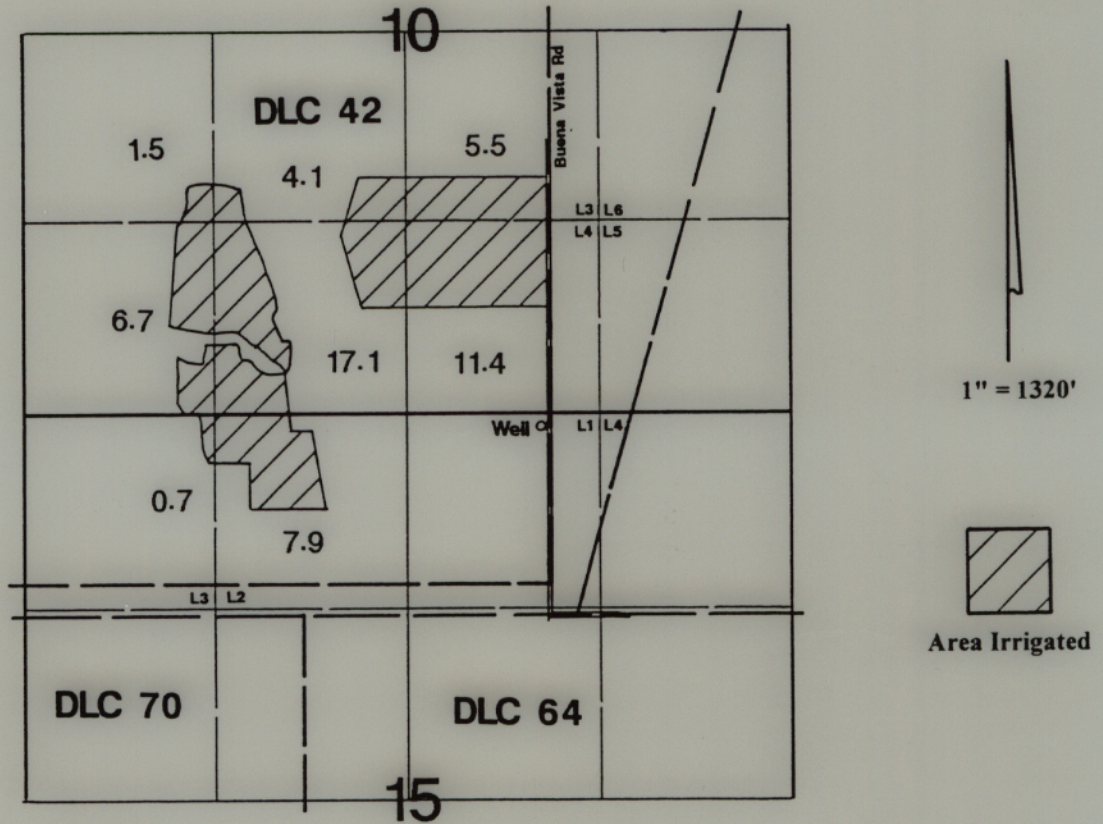

Well is located 100'S & 1650'W from NE corner of Section 15.

Final Proof Survey

Application #: G-12327 Permit #: G-12202

In Name Of

Paul Young

Surveyed on September 8, 1999 by JM Schuette

RECEIVED

SEP 24 1999

**WATER RESOURCES DEPT.
SALINA, OREGON**

This Map Was Prepared For The Purpose Of Identifying The Location Of A Water Right Only And Is Not Intended To Provide Legal Dimensions Or Location Of Property Ownership Lines.

