



Reservoir Application
Glover
T.26S R.7W Section 13
Douglas County
Scale: 1"=400'

RECEIVED

MAY 08 2023

OWRD

RECEIVED

DEC 21 2020

OWRD

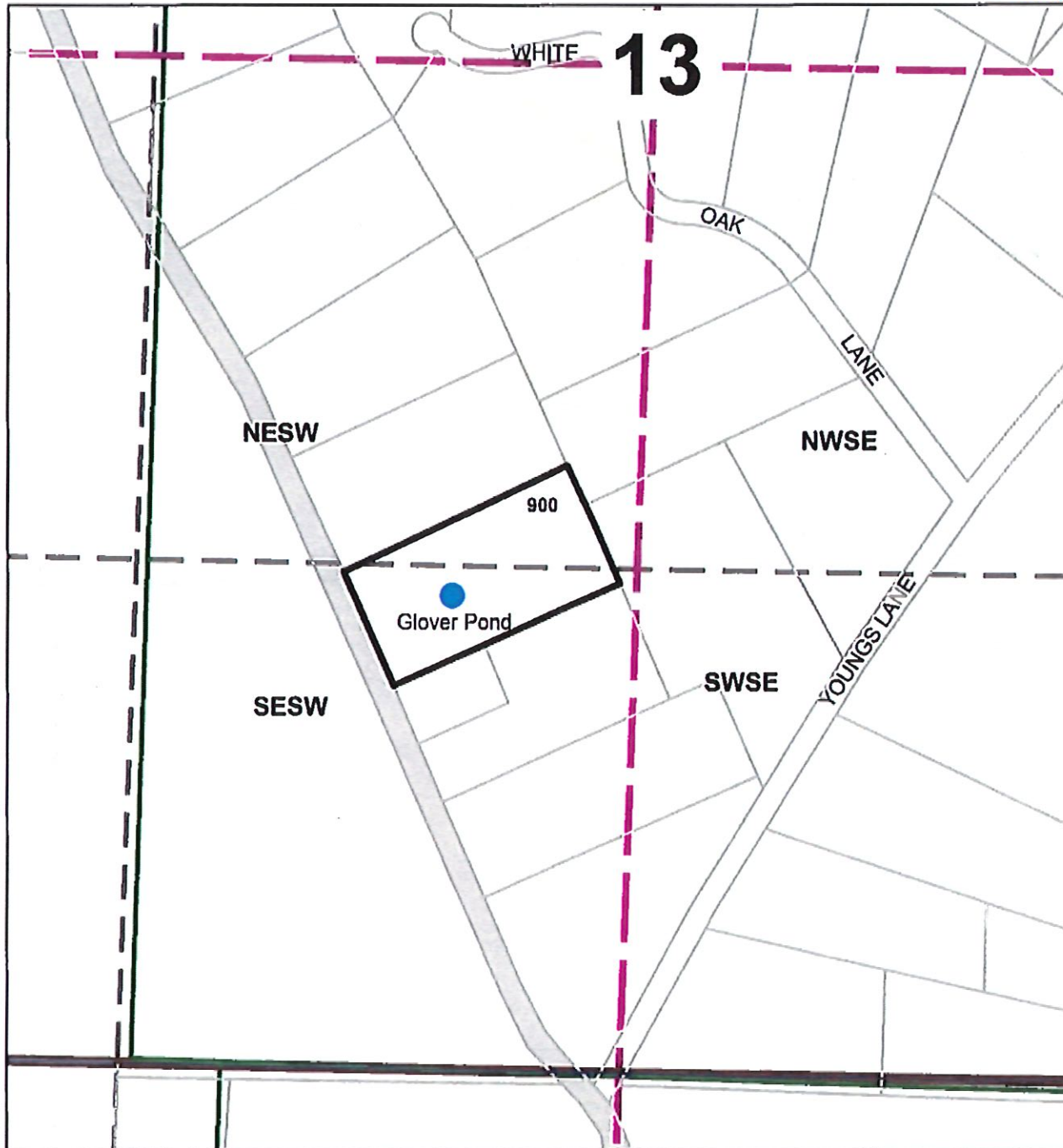

Pond is located 1416 ft South and 472 ft West of the Center of Section 13

The purpose of this map is to identify
the location of a water right.
Not intended to show property ownership.

SEE MAP 26 7 138

CANCELLED NOTS

SEE MAP 26 7 14

OFF MAR 26 7 13D

RECEIVED
MAY 08 2023

OVERD

DEC 21 2020

RECEIVED

610,000

26 7 13C

