

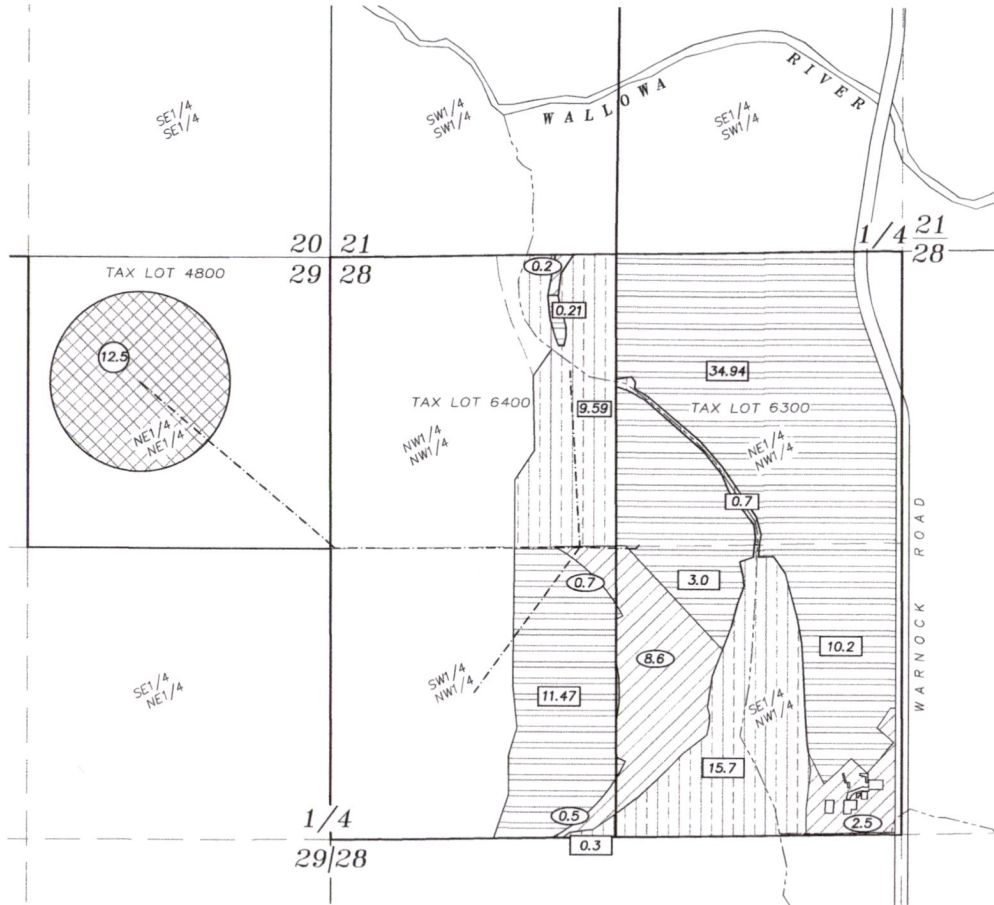









TOWNSHIP 1 NORTH RANGE 43 EAST

Received
FEB 12 2024
OWRD



LEGEND

-  Lands irrigated under Certificate 97431 (priority date 1883), with supplemental irrigation under Certificate 95646 (priority date 1935) and 95647 (priority date 1916) to remain in place
-  Lands irrigated under Certificate 97431 (priority date 1883), with supplemental irrigation under Certificate 95646 (priority date 1935) and 95647 (priority date 1916) to be transferred
-  Land to receive transferred water
-  Lands irrigated under Certificate 3162 (priority dated 1883) to remain in place
-  Proposed Mainline
-  Ditch
-  Area of irrigated land, to remain in place
-  Area of irrigated land, to be transferred
-  Area of land receiving transferred water

January 11, 2024

APPLICATION FOR
TRANSFER OF PLACE OF USE

FOR
ROCKING M CATTLE COMPANY

BY
BAGETT - GRIFFITH & BLACKMAN
2006 ADAMS AVENUE
LAGRANDE, OREGON 97850

APPLICATION NO. _____

PERMIT NUMBER _____

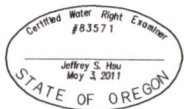

Renews: June 30,

NOTE: The preparation of this map was for the purpose of identifying the location of water rights and has no intent to provide dimensions or location of property ownership lines. Location information shown hereon was furnished by the applicant.



SCALE: 1"=400'

14405 -

MAP
 ACCOMPANYING APPLICATION OF THE CROSS
 COUNTRY CANAL COMPANY OF LOSTINE, OREGON
 FOR A PERMIT TO APPROPRIATE WATER.
 WALLOWA COUNTY, OREGON

Scale: 4" = 1 Mile

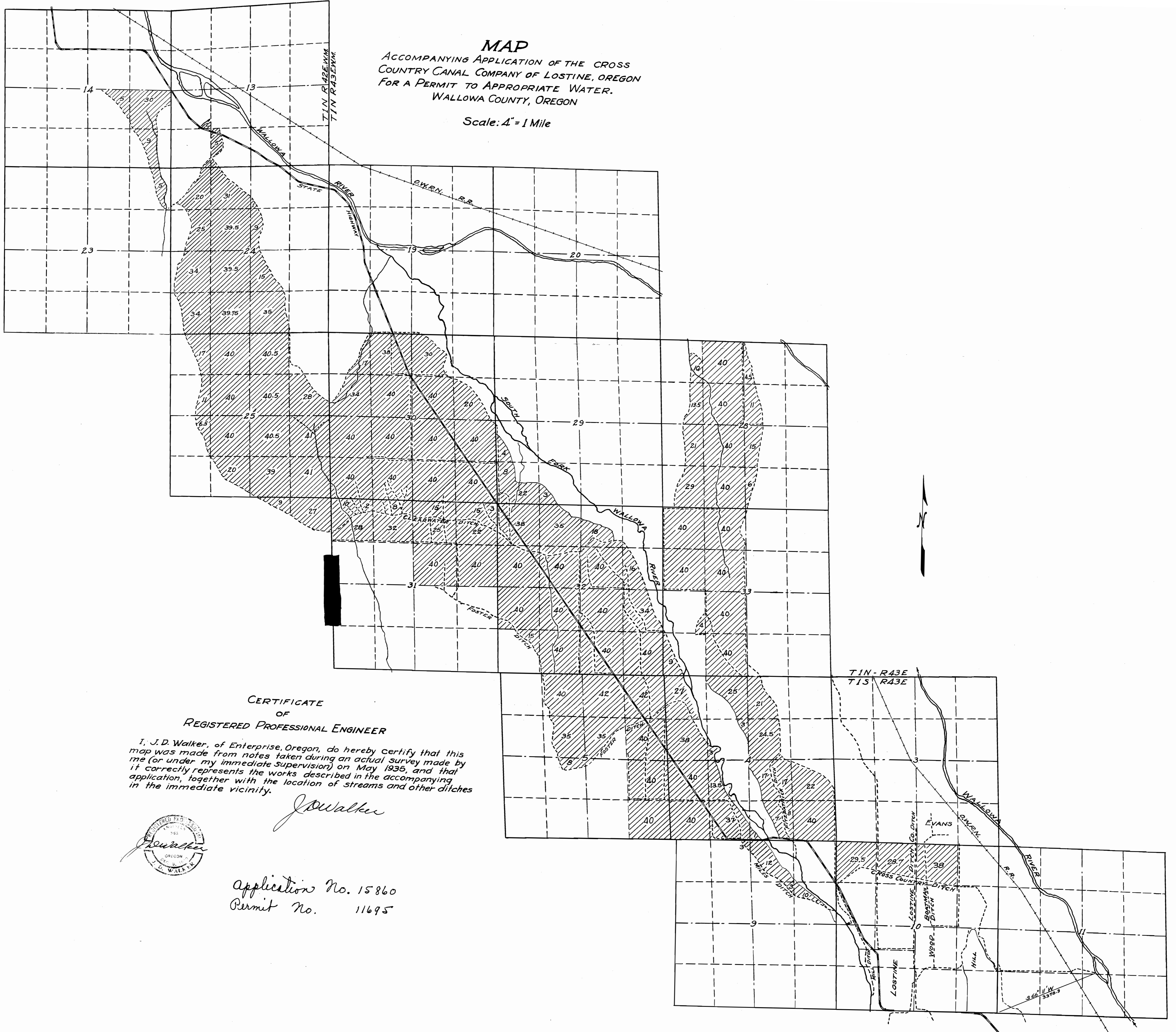

CERTIFICATE
 OF
 REGISTERED PROFESSIONAL ENGINEER

I, J. D. Walker, of Enterprise, Oregon, do hereby certify that this map was made from notes taken during an actual survey made by me (or under my immediate supervision) on May 1935, and that it correctly represents the works described in the accompanying application, together with the location of streams and other ditches in the immediate vicinity.

J. D. Walker



Application No. 15860
 Permit No. 11695