

CLAIM OF BENEFICIAL USE MAP

TO ADD A POINT OF APPROPRIATION AND CHANGE PLACE OF USE FOR T-12583

JRS PROPERTIES III, LLLP

TOWNSHIP 27 SOUTH, RANGE 19 EAST, SECTION 28, W.M.
TAX LOTS: 2200 & 3501

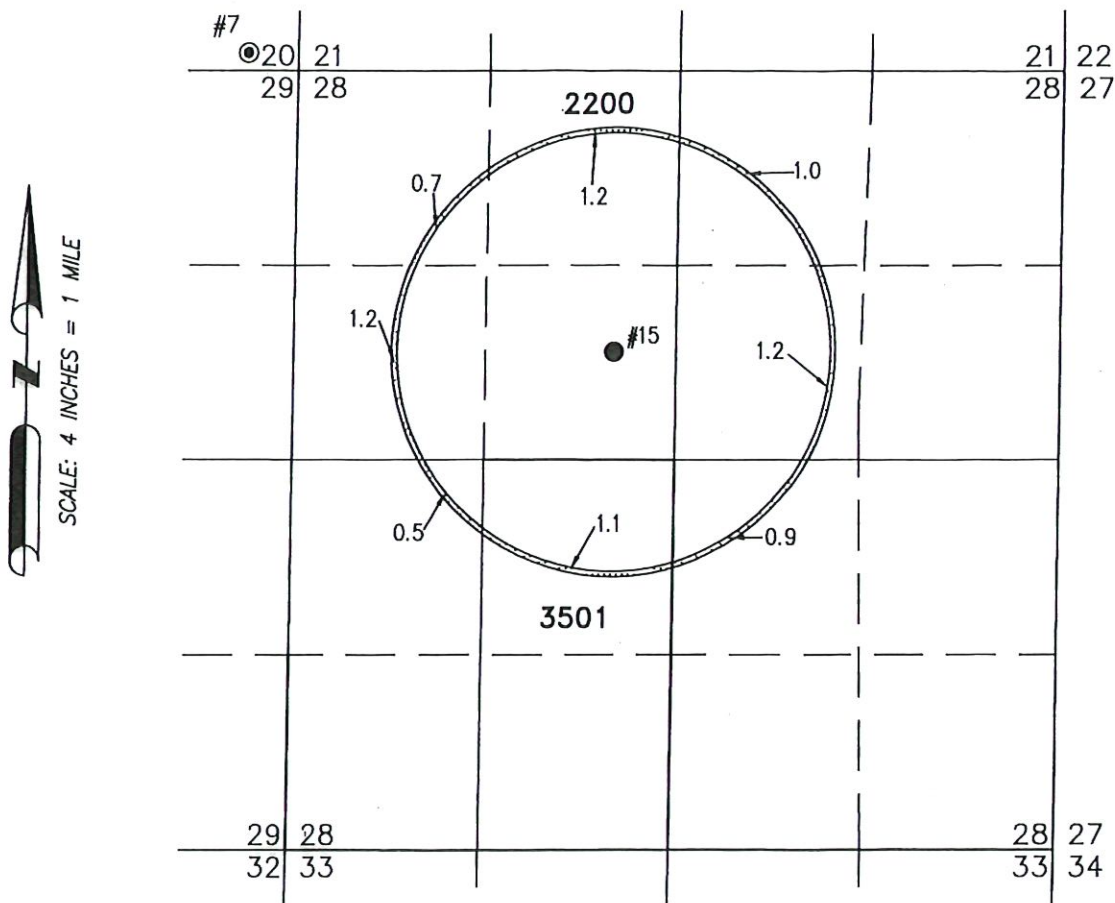

- WELL #15 (LAKE 1196)
SE 1/4 NW 1/4 SECTION 28, T27S
R19E, W.M.; 1910 FEET SOUTH AND
3110 FEET WEST FROM THE NE
CORNER OF SECTION 28.



7.8 ACRES PRIMARY IRRIGATION FROM
G-6051 (C#65759)



THIS MAP IS FOR THE PURPOSE OF LOCATING
A WATER RIGHT ONLY AND HAS NO INTENT
TO PROVIDE LEGAL DIMENSIONS OR THE
LOCATION OF PROPERTY LINES

RENEWAL DATE: 12/31/2020

PREPARED FOR:

J.R.S. PROPERTIES III, LLLP
P.O. BOX 27
BOISE, ID 83707

PREPARED BY:



ALL POINTS ENGINEERING AND SURVEYING, INC.
P.O. BOX 767
(541) 548-5833
TERREBONNE, OR 97760
www.APEandS.com

CLAIM OF BENEFICIAL USE MAP

TO ADD A POINT OF APPROPRIATION
FOR T-12583

JRS PROPERTIES III, LLLP

TOWNSHIP 27 SOUTH, RANGE 19 EAST, SECTIONS 19 & 20, W.M.
TAX LOTS: 2800 & 3200

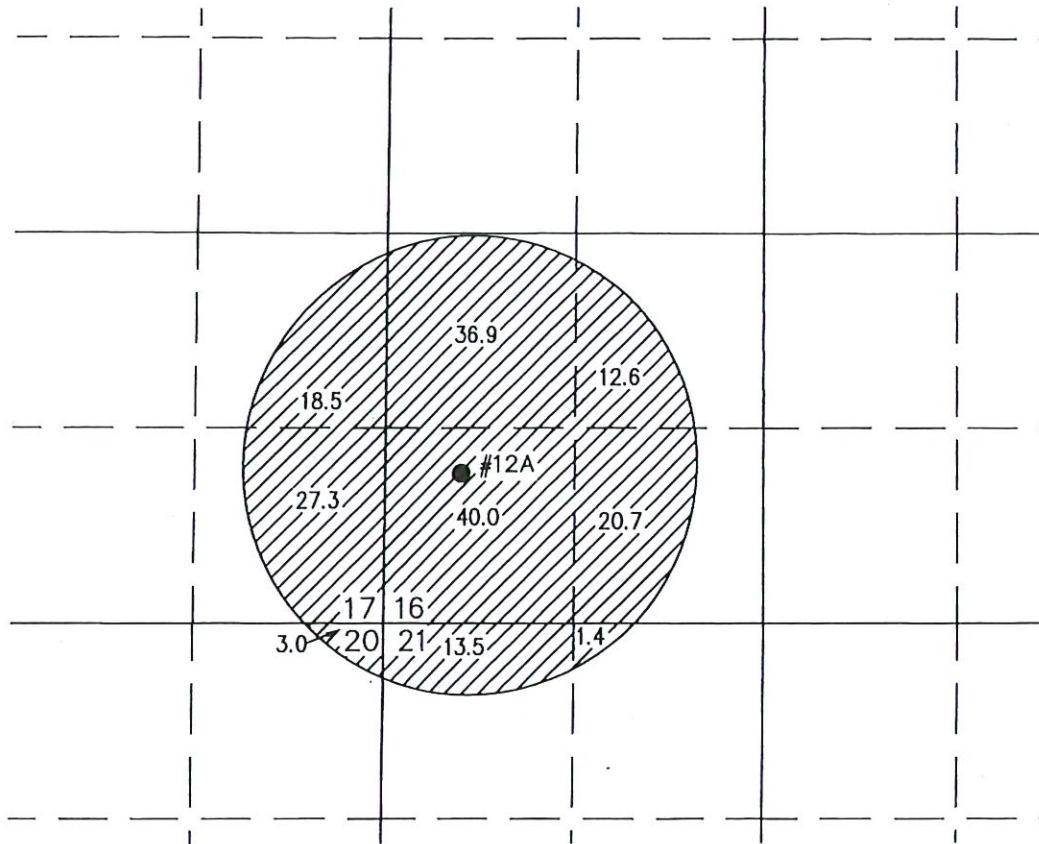

- WELL #12A (LAKE 52738/52768)
SW 1/4 SW 1/4 SECTION 16, T27S
R19E, W.M.; 1010 FEET NORTH AND
535 FEET EAST FROM THE SW
CORNER OF SECTION 16.



173.9 ACRES PRIMARY IRRIGATION
FROM G-6051 (C#94917)



THIS MAP IS FOR THE PURPOSE OF LOCATING
A WATER RIGHT ONLY AND HAS NO INTENT
TO PROVIDE LEGAL DIMENSIONS OR THE
LOCATION OF PROPERTY LINES

RENEWAL DATE: 12/31/2020

PREPARED FOR:

J.R.S. PROPERTIES III, LLLP
P.O. BOX 27
BOISE, ID 83707

PREPARED BY:



ALL POINTS ENGINEERING AND SURVEYING, INC.
P.O. BOX 767
(541) 548-5833
TERREBONNE, OR 97760
www.APEandS.com