

**T14S R14E, WM,
CROOK COUNTY, OR**

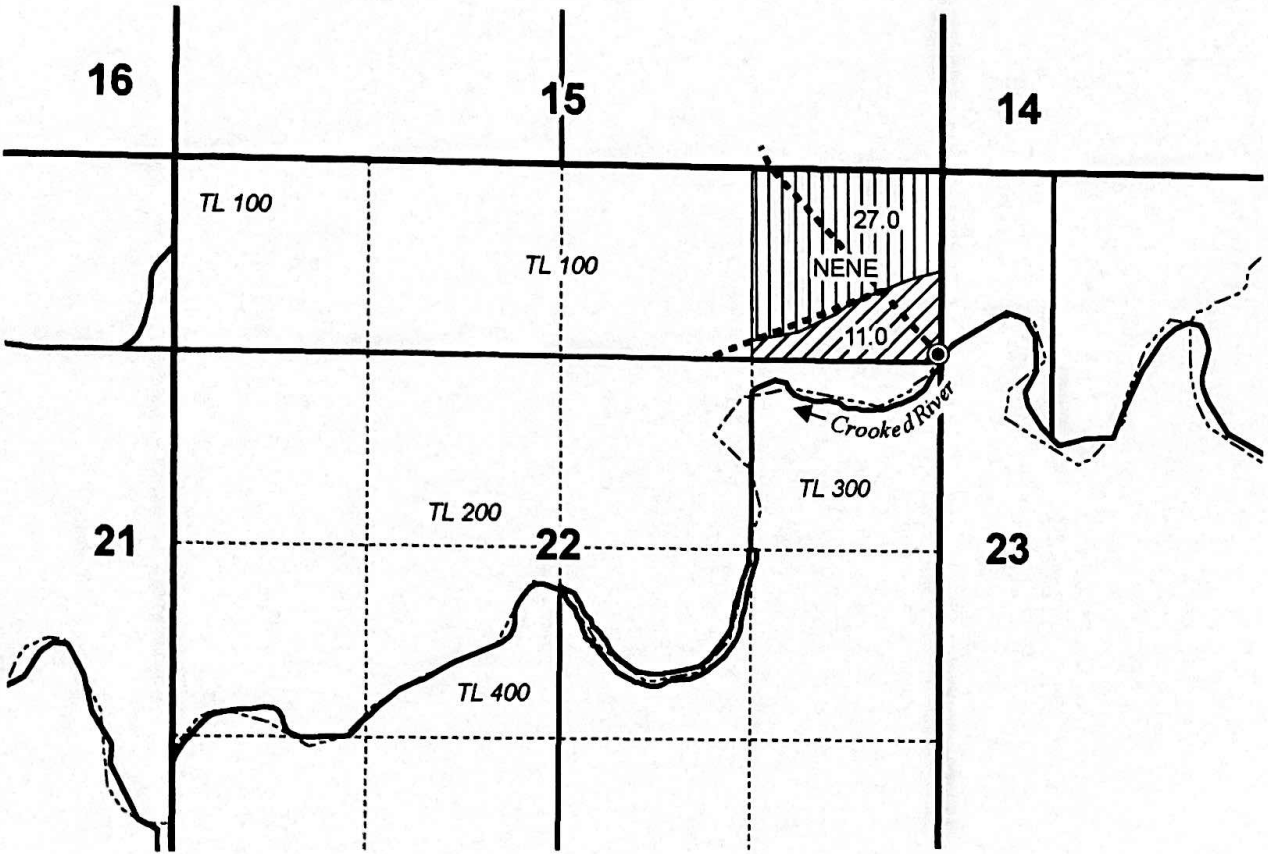

0 1,320 Feet

1" = 1,320'



- POD
- Pipeline
- POU IR "OFF" in NENE QQ
- POU IR "No Change" in NENE QQ
- Section
- Quarter Quarter
- Tax Lot

POD Location: 1300' S of NE Cor Sec 22

Note: The Point of Diversion Location
Is not on the certificate



RENEWS: 06/30/2026



PERMANENT TRANSFER "OFF" MAP
Butler / Knight
A portion of C-94473

Date: 5/27/2025

This map is not intended
to provide legal dimensions
or locations of property
ownership lines.

WATER RIGHT SERVICES, LLC
PO BOX 1830, BEND, OR 97709
WWW.OREGONWATER.US CCB # 197121
johnshort@usa.com 541-389-2837

