

T.6S. R.1W. Section 28, W.M.

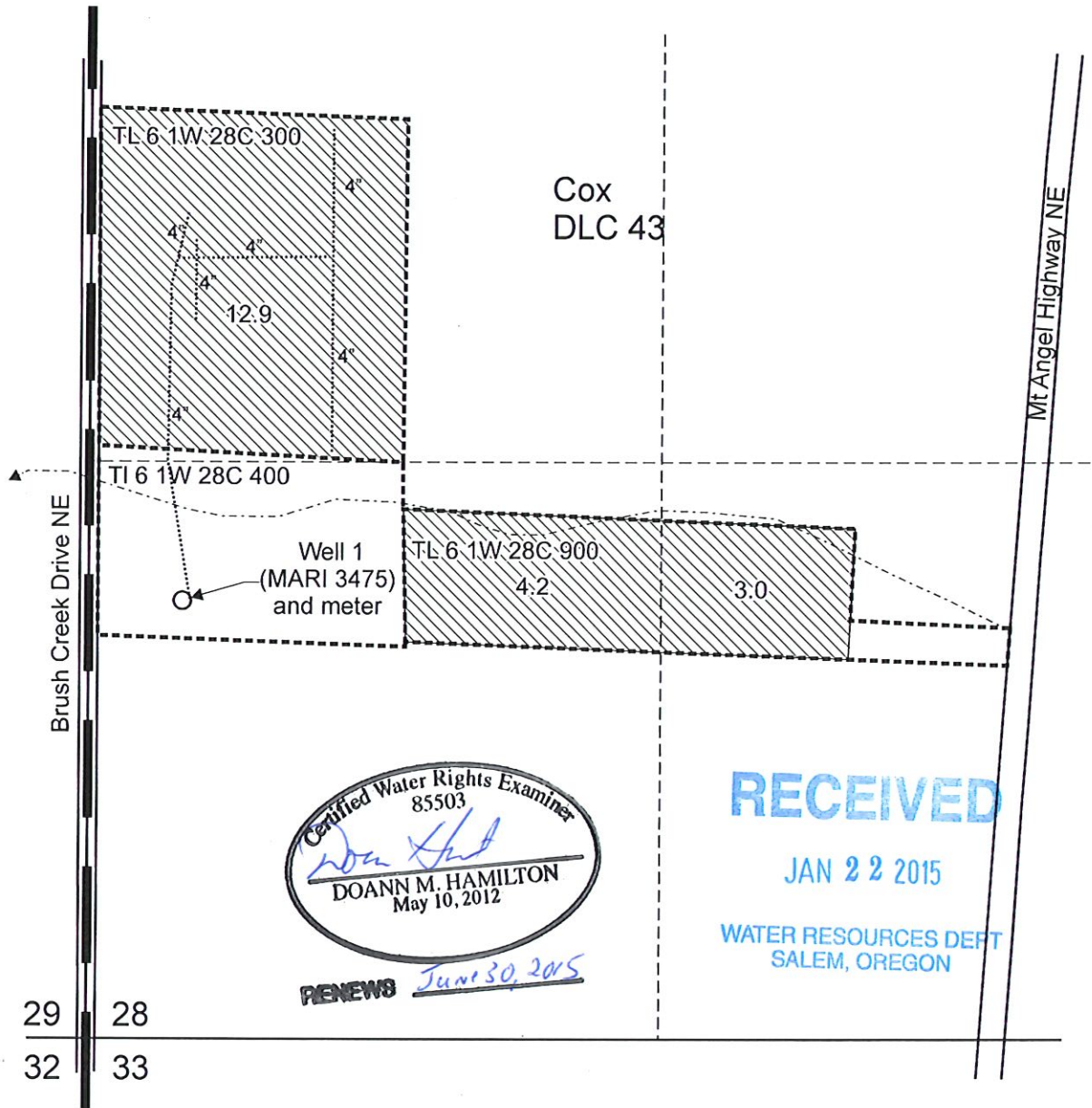

Certified Water Rights Examiner
85503
Doann M. Hamilton
DOANN M. HAMILTON
May 10, 2012
RENEWS *June 30, 2015*

RECEIVED
JAN 22 2015
WATER RESOURCES DEPT
SALEM, OREGON

29 28
32 33

Well 1 (MARI 3475) is located 1,000 feet north and 215 feet east from the SW corner, Section 28.

Area (20.1 acres) of nursery operations under Application G-17125, Permit G-16570.

- Tax lot boundary
- Donation Land Claim
- Unnamed intermittent drainage
- Mainline

Scale: 1" = 400'



This map was prepared for the purpose of identifying the location of a water right only and is not intended to provide legal dimensions or location of property ownership lines.



Claim of Beneficial Use Map
Application G-17125, Permit G-16570

Matthew Buchheit
T.6S. R.1W. Section 28, W.M.

Pacific Hydro-Geology Inc.

01/2015