

T. 8 S. R. 1 W. W. M.

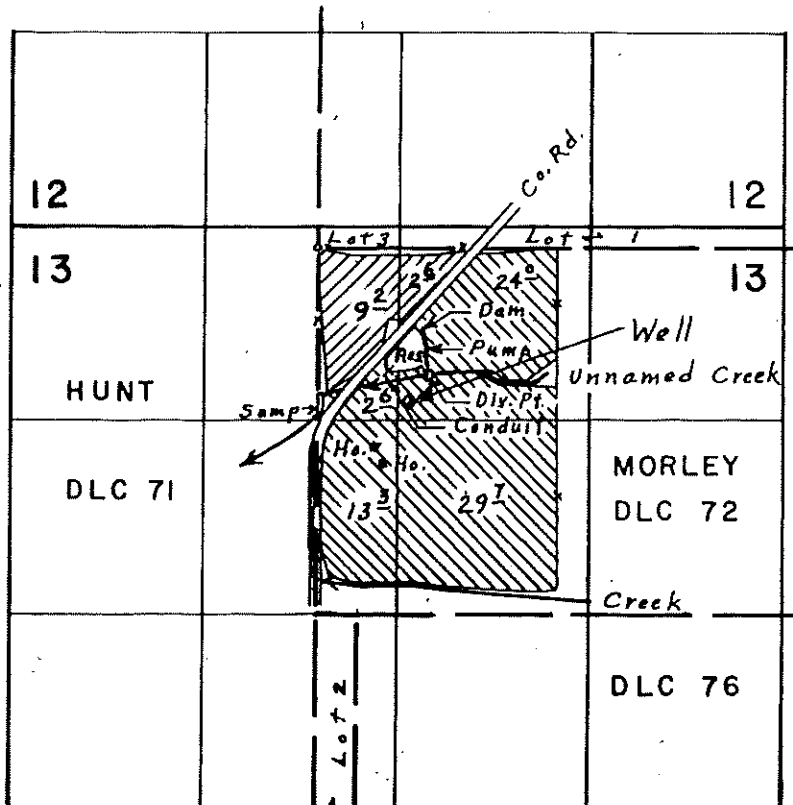

Scale 1" = 1320'

Div. Pts. located: Res. 680' S. & 750' E.; Unnamed Creek, 876' S. & 760' E.; Sump, 1080' S. & 20' E.; all from N.W. Cor. Morley D.L.C. 72

Well located 1050' S. & 640' E from NW Cor. DLC 72

Final  
**WATER RIGHT MAP FOR**  
 Appl. No. G-12115 Permit No. G-11111  
**DELBERT HENDRICKS**

Well surveyed May 8, 1990, by

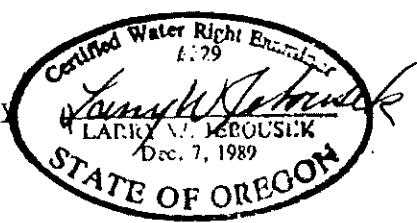

THIS MAP WAS PREPARED FOR THE PURPOSE OF IDENTIFYING THE LOCATION OF A WATER RIGHT ONLY AND IS NOT INTENDED TO PROVIDE LEGAL DIMENSIONS OR LOCATION OF PROPERTY OWNERSHIP LINES.