

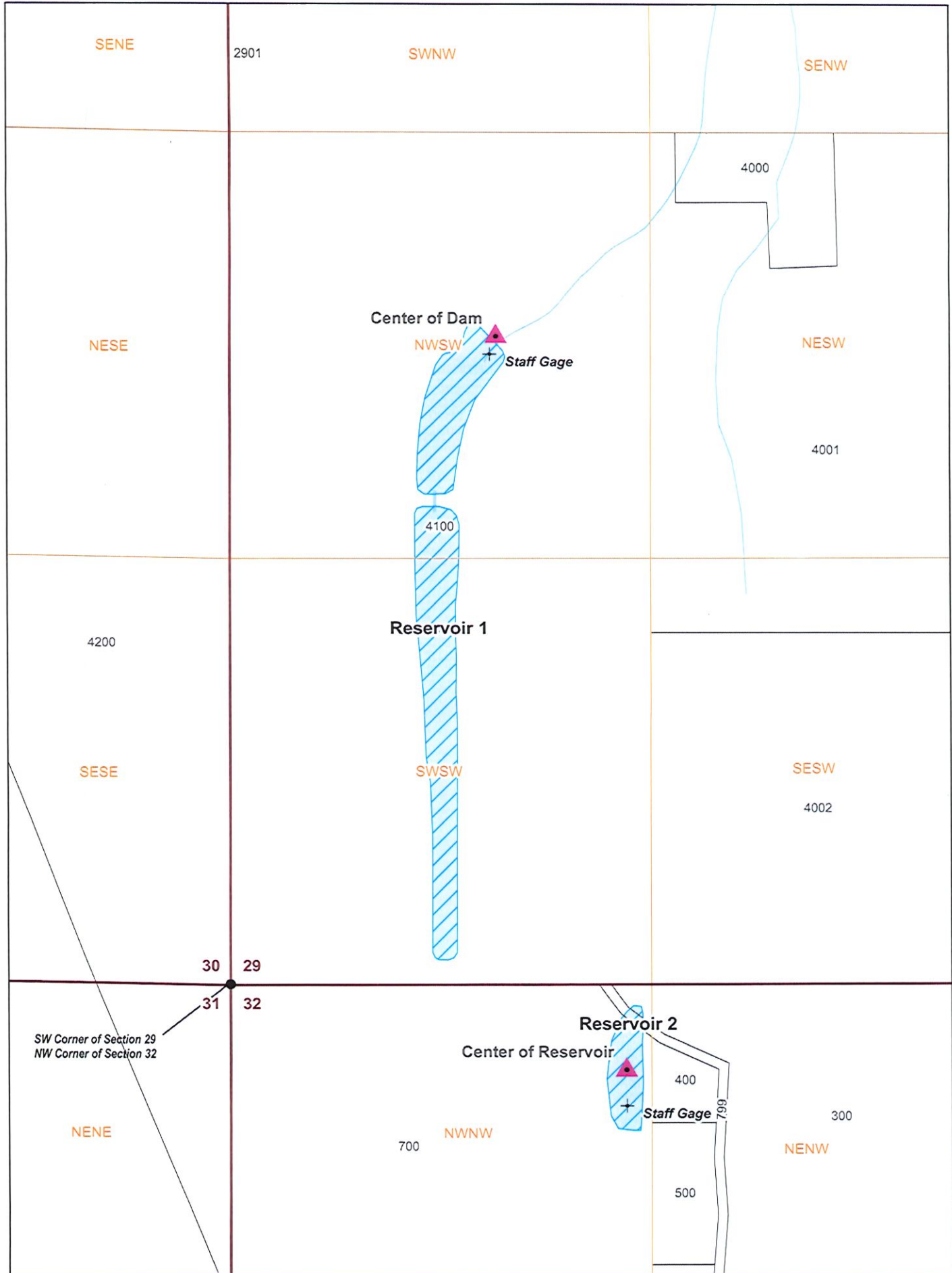





Claim of Beneficial Use Permit R-12096, Application R-74011

A Water Right held by McKenzie Family Properties, LLC
Curry County

Received
SEP 08 2025
OWRD



Legend

-  Place of Use (POU)
-  Point of Diversion (POD)
-  Staff Gage
-  Watercourse
-  Tax Lots

POD Location Description

Center of Dam (Reservoir 1)
Located 2,000 feet North and 820 feet East from SW corner of Section 29 (NWSW), Township 31 South, Range 15 West, W.M.

Center of Reservoir (Reservoir 2)
Located 245 feet South and 1,220 feet East from NW corner of Section 32 (NWNW), Township 31 South, Range 15 West, W.M.

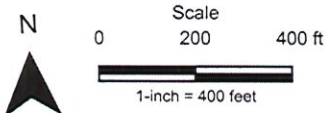
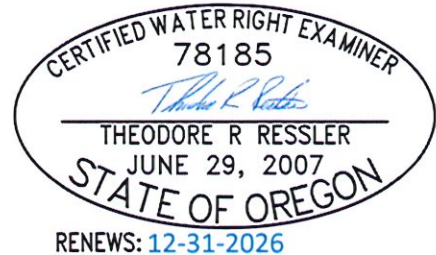

Date: 8/3/2025
Data Sources: BLM, OWRD, USGS, and Curry County.
Disclaimer: This map is not intended to provide legal dimensions or locations of property ownership lines.

