

RECEIVED

SEP 29 1993

WATER RESOURCES DEPT
SALEM, OREGON

T.6S., R.3W., W.M.

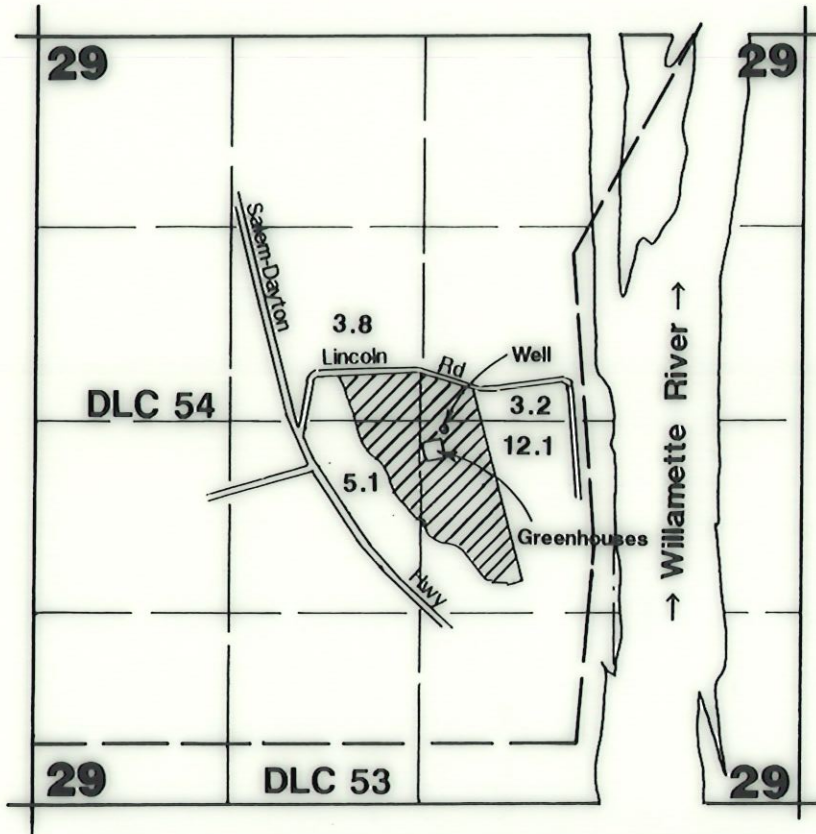

1" = 1320'

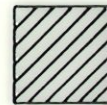

Nursery Operations

Well located 2150'N & 920'W from SE corner DLC 54.

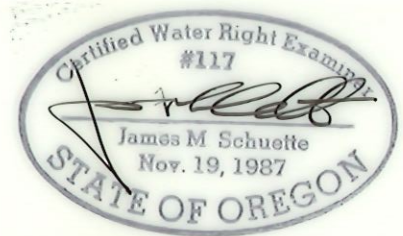

Final Proof Survey

Application #: G-12019 Permit #: G-10980

In Name Of

Wade Waddell

Surveyed on September 20, 1993 by JM Schuette

THIS MAP WAS PREPARED FOR THE PURPOSE OF IDENTIFYING THE LOCATION OF A WATER RIGHT ONLY AND IS NOT INTENDED TO PROVIDE LEGAL DIMENSIONS OR LOCATION OF PROPERTY OWNERSHIP LINES.