

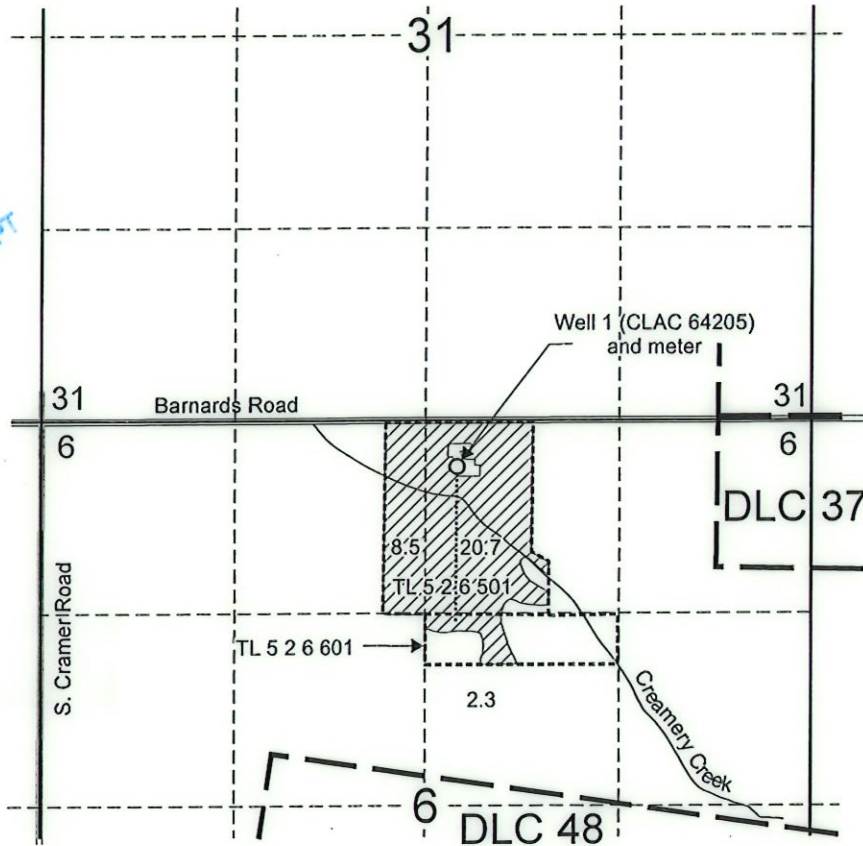

T.5S. R.2E. Section 6, W.M.

RECEIVED
 JUN - 3 2013
 WATER RESOURCES DEPT
 SALEM, OREGON



Well 1 (CLAC 64205) is located 1,900 feet north and 1,270 feet east from the NW corner of DLC 48.

 Area (31.5 Acres) irrigated under Application G-16490; Permit G-16080

----- Tax lot boundary

..... Mainline

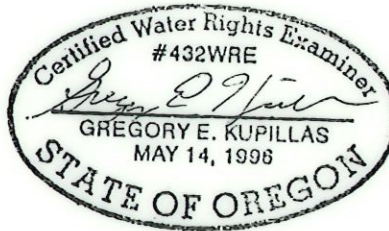

EXPIRATION DATE: 6/30/2015

Scale: 1" = 1,320'



This map was prepared for the purpose of identifying the location of a water right only and is not intended to provide legal dimensions or location of property ownership lines.

Claim of Beneficial Use Map
 Application G-16490, Permit G-16080

Pacific Hydro-Geology Inc.

Bgp-11/2012

Margaret Frances Kiernan
 T.5S. R.2E. Section 6, W.M.

KiernanCOBU.cdr

