

REGISTRATION NO. GR-10

CERTIFICATE NO. GR-9

RECEIVED
SEP 1 1955
STATE ENGINEER
SALEM, OREGON

Registration Statement

OF CLAIMANT OF RIGHT TO APPROPRIATE GROUND WATER

(Under Chapter 708, Oregon Laws 1955.)

TO THE STATE ENGINEER OF OREGON:

I, Sam & Vesta Nofziger
of Rt. 1, Albany County of Benton
State of Oregon

do hereby make application for a certificate of registration as evidence of a right to appropriate ground water.

1. Source from which water is withdrawn is Pump well
(Flowing well, pump well, infiltration trench, or tunnel)

2. Location is: 1 1/2 miles NW from Albany
(Approximate distance and direction from nearest city or town)

and is more particularly described as follows:

(a) 12.7 chs S and 15.8 chs East from the 1/4 corner between Secs 31 & 32
(Give distance and bearing to corner of section or other legal subdivision)

being within NE 1/4 of SE 1/4 of Sec. 31, Twp. 10S, Rge. 3W
(Smallest legal subdivision) (N. or S.) (E. or W.)

or (b) within limits of recorded platted property, town or city:

in Lot _____, Block _____ of _____
(Name of plat or addition)

County of Benton
(If within city or town, give name)

3. Construction Work was begun on October 1953; was completed on October 20, 1955
(Date) (Date)

and the ground water claimed was first used for the purposes set out below on May, 1954
(Date)

since which time the water has been used Continuously
(Continuously or Intermittently)

from May, 1954 to October, 1955
(Date) (Date)

4. Quantity of water claimed and used is 200 gallons per minute; _____ acre feet per year.

5. Purpose or Purposes for which water is used Irrigation
(Domestic, irrigation, municipal, manufacturing, industrial, etc.)

6. Description of Well: Depth 52' feet. Type Dug 10' - Dead - Drilled 32'
(Dug or drilled)

diameter 8 inches. Elevation of ground at well site 225' feet, mean sea level.
(As near as known)

Depth to water table 30' feet.

7. Capacity of Well: 220 g.p.m. with No change feet drawdown.

_____ g.p.m. with _____ feet drawdown.

Date of test October, 1953

If Flowing Well: Measured discharge _____ g.p.m. on _____
(Date)

Shut-in pressure at ground surface _____ lbs. per sq. in. on _____
(Date)

Water is controlled by _____
(Cap, valve, etc.)

8. **Casing:** (Give diameter, commercial specifications and depth below ground surface of each casing size.)

8 inch diameter from 10' to 42' feet
 inch diameter from to feet
 inch diameter from to feet
 inch diameter from to feet

Describe and show depth of shoe, plug, adapter, liner or other details:

9. **Perforated Casings or Screens:**

3" x 1" - 3" apart around 6" apart above from to
(Number per-foot and size of perforations, or describe screen)
 from to
 from to
 from to

10. **Log of Well:** (Describe each stratum or formation clearly, indicate if water bearing, and give thickness and depth as indicated.)

MATERIAL	Thickness (Feet)	Depth to Bottom (Feet)
Silty clay loam	20	
Coarse gravel	22	42 well depth

If log of well is not available, give name and address of driller. Nickolas Claus

11. Infiltration Trench: Covered or open

Dimensions: Length ft. Minimum depth ft. Maximum depth ft.

Bottom width ft. Discharge g.p.m. Date of test

12. Tunnel: Type of lining

Dimensions:
(Length, course, and cross sectional size)

Position of water bearing stratum with reference to portal of tunnel

Log of tunnel: (Preceding table for log of well may be used, if desired. Give footage from portal and character of materials, as pertinent.)

13. Pumping Equipment:

(a) Pump Go-0 CENTRIFUGAL Capacity 28 2.15 g.p.m.
(Make, type and size)

(b) Motor 15 h.p. electric motor
(Type and horsepower)

14. Location of area irrigated or to be irrigated, or place of use if for purposes other than irrigation.

Township North or South	Range E. or W. of Willamette Meridian	Section	Forty-acre Tract	Number Acres To Be Irrigated	Date of Reclamation
10S	3W	31	NE 1/4 SE 1/4	30.2	May, 1954
			NW 1/4 SE 1/4	49.5	
			SW 1/4 SE 1/4	50.3	
			SE 1/4 SE 1/4		
			NE 1/4 SW 1/4		
			SW 1/4 SW 1/4		

15. If the ground water supply is supplemental to an existing water supply, identification of any application for a permit, permit, certificate or adjudicated right to appropriate water made or held by the registrant.

Township 10S Range 3W W.M.

North

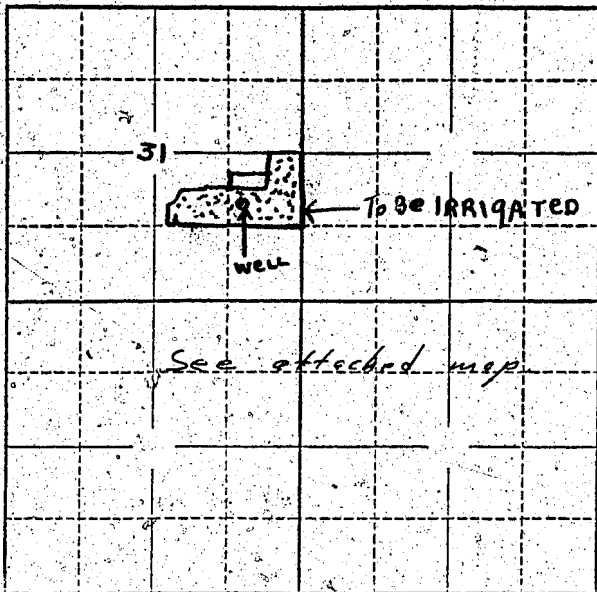

Locate well and acreage of irrigated land on plat.

Scale: 2" = 1 Mile

STATE OF OREGON

County of Linn

ss.

I, Sam & Vesta Nofziger, being first duly sworn, do hereby certify that I have read the foregoing Registration Statement and that all of the items therein contained are true to the best of my knowledge and belief.

Sam Nofziger, Vesta Nofziger (Signatures of Registrant)

Subscribed and sworn to before me this 7th day of September 1955

NOTARY PUBLIC FOR OREGON

My commission expires My Commission Expires May 28 1956

Notary Signature (Notary Public)

(SEAL)

CERTIFICATE OF REGISTRATION

STATE OF OREGON

County of Marion

ss.

This is to certify that the foregoing Registration Statement was received in the office of the State Engineer on the 11th day of September 1955, at 2:23 o'clock P.M. and has been duly recorded in said office in Book No. 1 of Registration Statements on page 9

Construction shall be completed by 1955, and the water completely applied to beneficial use by 1955

Witness my hand this 24th day of February 1956

Lewis A. Stankle (State Engineer)

By (Deputy)