

RECEIVED
FEB 19 1958
STATE ENGINEER
SALEM, OREGON

Registration No. GR - 1044

Certificate No. GR - 1006

Registration Statement

OF CLAIMANT OF RIGHT TO APPROPRIATE GROUND WATER

TO THE STATE ENGINEER OF OREGON:

I, K. Nishikawa

of Rt. 3, Box 236 - BORING County of Clackamas
(Mailing address)

State of Oregon, do hereby make application for a certificate of registration as evidence of a right to appropriate ground water.

1. Source from which water is withdrawn is Pump Well
(Flowing well, pump well, infiltration trench, or tunnel)

2. Location is: 1 mile South of BORING
(Approximate distance and direction from nearest city or town)

and is more particularly described as follows:

(a) N 86° W, 1305' from SE Corner of SECTION 1,
(Give distance and bearing to corner of section or other legal subdivision)

being within SE 1/4 SE 1/4 of Sec. 1, Twp. 25, Rge. 3E
(Smallest legal subdivision) (N. or S.) (E. or W.)

or (b) within limits of recorded platted property, town or city:

in Lot _____, Block _____ of _____
(Name of plat or addition)

County of _____
(If within city or town, give name)

3. Construction Work was begun on Jan - '53; was completed on Jan - '53
(Date) (Date)

and the ground water claimed was first used for the purposes set out below on April 1953
(Date)

since which time the water has been used intermittently during season
(Continuously or intermittently)

from April 1953 to Oct 1957
(Date) (Date)

4. Quantity of water claimed and used is 30 gallons per minute; _____ acre feet per year.

5. Purpose or Purposes for which water is used IRRIGATION

(Domestic, irrigation, municipal, manufacturing, industrial, etc.)

6. Description of Well: Depth 210 feet, Type drilled
(Dug or drilled)

diameter 6 inches. Elevation of ground at well site 600 feet, mean sea level.
(As near as known)

Depth to water table 190 feet.

7. Capacity of Well: 30 g.p.m. with 5 feet drawdown.

_____ g.p.m. with _____ feet drawdown.

Date of test Jan

If Flowing Well, Measured discharge _____ g.p.m. on _____
(Date)

Shut-in pressure at ground surface _____ lbs. per sq. in. on _____
(Date)

Water is controlled by _____
(Cap, valve, etc.)

Township 2S Range 3E W.M.

North

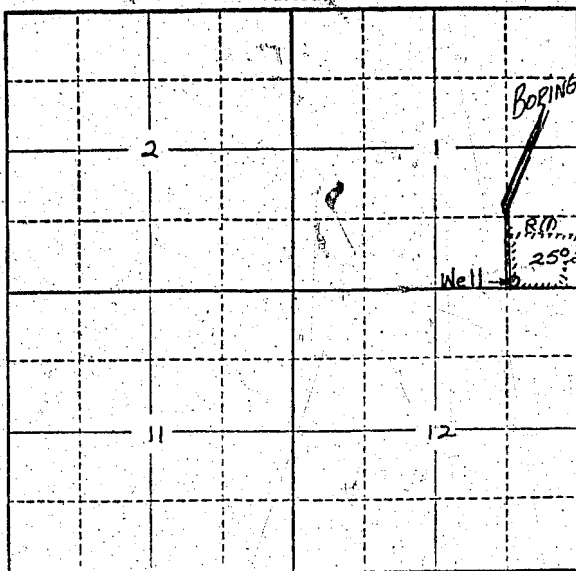

Locate well and acreage of irrigated land on plat.

Scale: 2" = 1 Mile

STATE OF OREGON

County of CLATSOP

ss.

I, K. Nishikawa, being first duly sworn, do hereby certify that I have read the foregoing Registration Statement and that all of the items therein contained are true to the best of my knowledge and belief.

K. Nishikawa
(Signature of Registrant)

Subscribed and sworn to before me this 17th day of FEBRUARY, 1958.

My commission expires

Mar 1st
(Notary Public)

(SEAL)

CERTIFICATE OF REGISTRATION

STATE OF OREGON

County of Marion

ss.

This is to certify that the foregoing Registration Statement was received in the office of the State Engineer on the 10th day of FEBRUARY, 1958, at o'clock M. and has been duly recorded in said office in Book No. 5 of Registration Statements on page GR-1006C

Witness my hand this 30th day of June, 1958.

Lewis A. Stanley
(State Engineer)

By

(Deputy)