

# Registration Statement

## OF CLAIMANT OF RIGHT TO APPROPRIATE GROUND WATER

TO THE STATE ENGINEER OF OREGON:

I, Leroy McGill & Deroy McGill D.B.A. McGill Bros.

of Marion County of Marion  
(Mailing address)

State of Oregon, do hereby make application for a certificate of registration as evidence of a right to appropriate ground water.

1. Source from which water is withdrawn is Pump Well #1  
(Flowing well, pump well, infiltration trench, or tunnel)

2. Location is: 1 1/2 Miles south of Marion  
(Approximate distance and direction from nearest city or town)

and is more particularly described as follows:

(a) Well No. 1 1770' S. & 1679' E. of N.W. cor. Wm. McKinney D.L.C.  
(Give distance and bearing to corner of section or other legal subdivision)

being within N.E. 1/4 of S.E. 1/4 Sec. 5 of Sec. 5, Twp. 10S, Rge. 2W  
(Smallest legal subdivision) (N. or S.) (E. or W.)

or (b) within limits of recorded platted property, town or city:

in Lot \_\_\_\_\_, Block \_\_\_\_\_ of \_\_\_\_\_  
(Name of plat or addition)

County of \_\_\_\_\_  
(If within city or town, give name)

3. Construction Work was begun on Feb. 1, 1941; was completed on Feb. 3, 1941  
(Date) (Date)

and the ground water claimed was first used for the purposes set out below on April 1941  
(Date)

since which time the water has been used intermittently  
(Continuously or intermittently)

from May 1 to Oct. 1957  
(Date) (Date)

4. Quantity of water claimed and used is 500 gallons per minute; 300 acre feet per year.

5. Purpose or Purposes for which water is used Irrigation

(Domestic, irrigation, municipal, manufacturing, industrial, etc.)

6. Description of Well: Depth 30 feet. Type Drilled  
(Dug or drilled)

diameter 8 inches. Elevation of ground at well site \_\_\_\_\_ feet, mean sea level.  
(As near as known)

Depth to water table 10 feet.

7. Capacity of Well: 600 g.p.m. with 15 feet drawdown.

\_\_\_\_\_ g.p.m. with \_\_\_\_\_ feet drawdown.

Date of test 1941

If Flowing Well: Measured discharge \_\_\_\_\_ g.p.m. on \_\_\_\_\_  
(Date)

Shut-in pressure at ground surface \_\_\_\_\_ lbs. per sq. in. on \_\_\_\_\_  
(Date)

Water is controlled by \_\_\_\_\_  
(Cap, valve, etc.)





Township 10S Range 2W, W.M.  
North

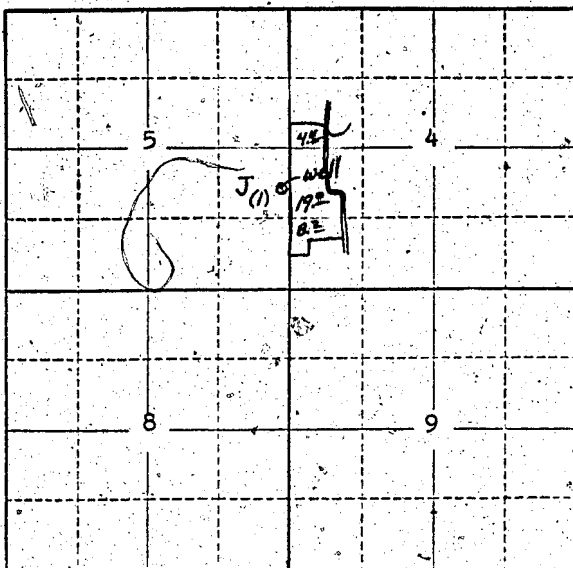

Locate well and acreage of irrigated land on plat.

Scale: 2" = 1 Mile

STATE OF OREGON

County of Marion

ss.

I, McElliott Bros., being first duly sworn, do hereby certify that I have read the foregoing Registration Statement and that all of the items therein contained are true to the best of my knowledge and belief.

McElliott Bros. by first McElliott  
(Signature of Registrant)

Subscribed and sworn to before me this 21st day of February, 1958.

My commission expires 12th June 1961

Wm. S. Bartholomew  
(Notary Public)

(SEAL)

**CERTIFICATE OF REGISTRATION**

STATE OF OREGON

County of Marion

This is to certify that the foregoing Registration Statement was received in the office of the State Engineer on the 21st day of February, 1958, at 9:00 o'clock A. M. and has been duly recorded in said office in Book No. 5 of Registration Statements on page GR-1016 C

Witness my hand this 30th day of June, 1958.

Lewis A. Stanley  
(State Engineer)

By

(Deputy)

GR - 1016 C