

RECEIVED
FEB 23 1958
STATE ENGINEER
SACRAMENTO DIVISION

Registration No. GR. - 1058

Certificate No. GR. - 1020

Registration Statement

OF CLAIMANT OF RIGHT TO APPROPRIATE GROUND WATER

TO THE STATE ENGINEER OF OREGON:

I, James E. Barton

of 3741 Y St., Sacramento County of Sacramento
(Mailing address)

State of California, do hereby make application for a certificate of registration as evidence of a right to appropriate ground water.

1. Source from which water is withdrawn is Pump well
(Flowing well, pump well, infiltration trench, or tunnel)

2. Location is: 4 miles NW of Shedd, Oregon
(Approximate distance and direction from nearest city or town)

and is more particularly described as follows:

(a) S. 85° 45' E. 30.75 chains from NW corner of DLC 44, T. 12 S., R. 4 W.
(Give distance and bearing to corner of section or other legal subdivision)

being within NE 1/4 of SW 1/4 of Sec. 34, Twp. 12 S., Rge. 4 W.
(Smallest legal subdivision) (N. or S.) (E. or W.)

or (b) within limits of recorded platted property, town or city:

in Lot _____, Block _____ of _____
(Name of plat or addition)

County of Linn
(If within city or town, give name)

3. Construction Work was begun on March 1954; was completed on March 1954
(Date) (Date)

and the ground water claimed was first used for the purposes set out below on May 1954
(Date)

since which time the water has been used continuously
(Continuously or intermittently)

from May 1954 to present time
(Date) (Date)

4. Quantity of water claimed and used is 25 gallons per minute; 10.25 acre feet per year.

5. Purpose or Purposes for which water is used Irrigation
(Domestic, irrigation, municipal, manufacturing, industrial, etc.)

6. Description of Well: Depth 85 feet Type Drilled
(Dug or drilled)

diameter 6 inches. Elevation of ground at well site 257 feet, mean sea level.
(As near as known)

Depth to water table 12 feet.

7. Capacity of Well: Not known g.p.m. with _____ feet drawdown.

_____ g.p.m. with _____ feet drawdown.

Date of test None

If Flowing Well: Measured discharge _____ g.p.m. on _____
(Date)

Shut-in pressure at ground surface _____ lbs. per sq. in. on _____
(Date)

Water is controlled by _____
(Cap. valve, etc.)

8. Casing: (Give diameter, commercial specifications and depth below ground surface of each casing size.)

6 inch diameter steel casing from 0 to 85 feet
..... inch diameter from to feet
..... inch diameter from to feet
..... inch diameter from to feet

Describe and show depth of shoe, plug, adapter, liner or other details:

9. Perforated Casings or Screens:

Slot perforations from 79 to 85
(Number per foot and size of perforations, or describe screen)
..... from to
..... from to
..... from to

10. Log of Well: (Describe each stratum or formation clearly, indicate if water bearing, and give thickness and depth as indicated.)

MATERIAL	Thickness (Feet)	Depth to Bottom (Feet)
Not available		

If log of well is not available, give name and address of driller. Slate Drilling Co., Tangent, Oregon

11. Infiltration Trench: Covered or open
 Dimensions: Length ft. Minimum depth ft. Maximum depth ft.

Bottom width ft. Discharge g.p.m. Date of test

12. Tunnel: Type of lining

Dimensions:
 (Length, course, and cross-sectional size)

Position of water bearing stratum with reference to portal of tunnel

Log of tunnel: (Preceding table for log of well may be used, if desired. Give footage from portal and character of materials, as pertinent.)

13. Pumping Equipment:

(a) Pump Fairbanks Morse Deep well Capacity 50 g.p.m.
 (Make, type and size)

(b) Motor 1 H. P. electric
 (Type and horsepower)

14. Location of area irrigated or to be irrigated, or place of use if for purposes other than irrigation.

Township North or South	Range E. or W. of Willamette Meridian	Section	Forty-acre Tract	Number Acres To Be Irrigated	Date of Reclamation
12 S	4 W.	34	NE $\frac{1}{4}$ of SW $\frac{1}{4}$	4.0	May 1951
12 S	4 W.	34	SE $\frac{2}{4}$ of SW $\frac{1}{4}$	0.1	
				4.1	

Beginning at the Northwest corner of the George W. Miller D.L.C. No. 44 in T. 12 S., R. 4 W. and D.L.C. No. 65 in T. 13 S., R. 4 W. of the Will. Mer. in Linn County, Oregon; and running thence South along the West line of said Claim 9.45 chains; thence East 46.00 chains to the East line of the Southwest $\frac{1}{4}$ of Sec. 34 in T. 12 S., R. 4 W.; thence North along the East line of said Southwest $\frac{1}{4}$ 9.45 chains to a point due East of the Northeast corner of said George W. Miller D.L.C.; thence West 45.99 chains to the place of beginning. ALSO beginning on the West line of and South 18.80 chains from the Northwest corner of the above mentioned George W. Miller D.L.C.; thence East 46.02 chains to the East line of the Southwest $\frac{1}{4}$ of Sec. 34 in T. 12 S., R. 4 W.; thence South 8.36 chains to the Southeast corner of said Southwest $\frac{1}{4}$ of Sec. 34; thence West along the South line of Sec. 34 a distance of 3.21 chains to the East line of said George W. Miller D.L.C.; thence South 10.27 chains to the Southeast corner of said George W. Miller D.L.C.; thence West 42.90 chains to the Southwest corner of said George W. Miller D.L.C.; thence North 18.74 chains to the place of beginning and containing in all 126.70 acres, more or less, ALSO

Beginning on the West boundary line of and South 9.45 chains distant from the North west corner of the Donation Land Claim of G. W. Miller, same being Notification No. 2238 and Claim No. 44 in Township 12 South Range 4 West of the Willamette Meridian, in Linn County, Oregon; and running thence East 46.00 chains to the West boundary line of the South East quarter in Section 34, in said Township; and thence South along said boundary line 35 chains; thence West 18.80 chains to the West boundary line of said claim No. 44; thence North 18.74 chains to the place of beginning; containing in all 126.70 acres, more or less, ALSO

..... of any application for a permit, permit, certificate or adjudicated right to appropriate water made or held by the registrant.

Township 12 S Range 4 W, W.M.
North

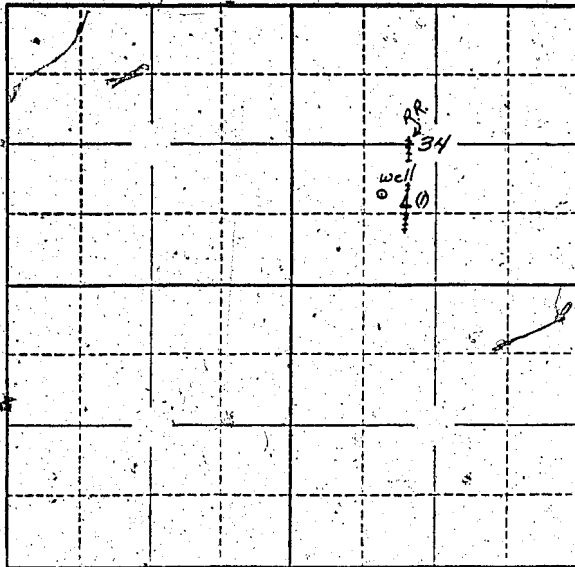

Locate well and acreage of irrigated land on plat.
Scale: 2" = 1 Mile

CALIFORNIA
STATE OF OREGON
County of Sacramento

ss.

I, James E. Barton, being first duly sworn, do hereby certify that I have read the foregoing Registration Statement and that all of the items therein contained are true to the best of my knowledge and belief.

James E. Barton
(Signature of Registrant)

Subscribed and sworn to before me this 12th day of February, 1958

My commission expires August 12, 1961

William H. Rose
(Signature of Public)

(SEAL)

CERTIFICATE OF REGISTRATION

STATE OF OREGON
County of Marion

ss.

This is to certify that the foregoing Registration Statement was received in the office of the State Engineer on the 24th day of February, 1958, at 8:00 o'clock A.M. and has been duly recorded in said office in Book No. 5 of Registration Statements on page GR-1020C

Witness my hand this 30th day of June, 1958.

Lewis A. Stanley
(State Engineer)

By _____
(Deputy)

GR-1020 C