

Registration Statement

REGISTRATION NO. GR-1069
CERTIFICATE NO. GR-1031

OF CLAIMANT OF RIGHT TO APPROPRIATE GROUND WATER

(Under Chapter 708, Oregon Laws 1955.)

TO THE STATE ENGINEER OF OREGON:

I, John A. & Marie Erickson
of Woodburn County of Marietta
State of Oregon, do hereby make application for a certificate of registration as evidence
of a right to appropriate ground water.

- 1. Source from which water is withdrawn is in Pump
(Flowing well, pump well, infiltration trench, or tunnel)
- 2. Location is: 1 1/2 mi. North east of Woodburn
(Approximate distance and direction from nearest city or town)

and is more particularly described as follows:

(a) 205 Ch W. & 23 Ch S from Center of Section 9
(Give distance and bearing to corner of section or other legal subdivision)
being within NW 1/4 SW 1/4 of Sec. 9, Twp. 5 S, Rge. 1 W
(Smallest legal subdivision) (N. or S.) (E. or W.)
or (b) within limits of recorded platted property, town or city:
in Lot 24, Block 5 of WOODBURN FRUIT FARM
(Name of plat or addition)
County of MARIETTA
(If within city or town, give name)

3. Construction Work was begun on AUG 1 1953; was completed on AUG 6 1953
(Date) (Date)
and the ground water claimed was first used for the purposes set out below on SEP 1 1953
(Date)
since which time the water has been used INTERMITTENTLY
(Continuously or Intermittently)
from APRIL '53 to OCTOBER '57
(Date) (Date)

4. Quantity of water claimed and used is 5 gallons per minute; _____ acre
feet per year.

5. Purpose or Purposes for which water is used IRRIGATION
(Domestic, irrigation, municipal, manufacturing, industrial, etc.)

6. Description of Well: Depth 122 feet. Type DRILLED
(Dug or drilled)
diameter 1 inches. Elevation of ground at well site _____ feet, mean sea level.
(As near as known)
Depth to water table 1 feet.

7. Capacity of Well: 100 g.p.m. with 54 feet drawdown.
250 g.p.m. with 98 feet drawdown.

Date of test AUG 7 1953
If Flowing Well: Measured discharge _____ g.p.m. on _____ (Date)
Shut-in pressure at ground surface _____ lbs. per sq. in. on _____ (Date)
Water is controlled by _____
(Cap. valve, etc.)

Township 5 S Range 1 W W.M.
North

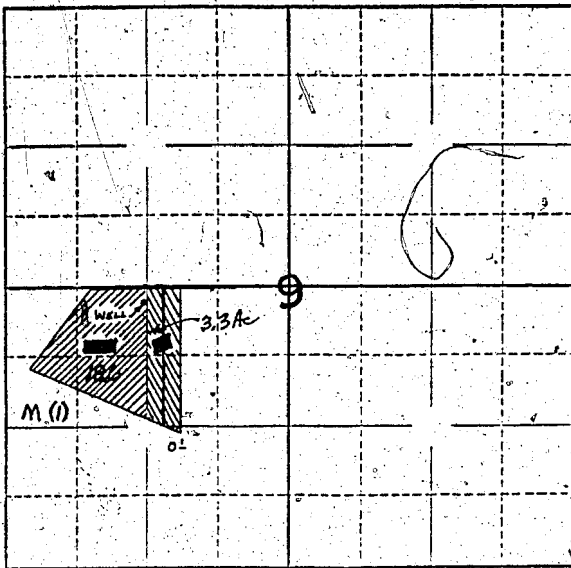

Locate well and acreage of irrigated land on plat.
Scale: $\frac{1}{4}$ " = 1 Mile

STATE OF OREGON

County of Marion ss.

I, John A. Erickson being first duly sworn, do hereby certify that I have read the foregoing Registration Statement and that all of the items therein contained are true to the best of my knowledge and belief.

John A. Erickson
(Signature of Registrant)

Subscribed and sworn to before me this 24th day of February 19 58

My commission expires 12th June 1961 Wm. S. Bartholomew
(Notary Public)

(SEAL)

CERTIFICATE OF REGISTRATION

STATE OF OREGON

County of Marion ss.

This is to certify that the foregoing Registration Statement was received in the office of the State Engineer on the 24th day of February 19 58 at 3:30 o'clock P. M. and has been duly recorded in said office in Book No. 5 of Registration Statements on page GR-1031C

~~THIS STATEMENT IS TO BE RECORDED BY THE STATE ENGINEER'S OFFICE ON OR BEFORE THE 30TH DAY OF JUNE 1958 AND THE OFFICE EMPLOYED BY THE REGISTRANT~~

~~RECORDED BY~~

Witness my hand this 30th day of June 19 58

Leona A. Stanley
(State Engineer)

By _____ (Deputy)

GR-1031C