

Registration Statement

OF CLAIMANT OF RIGHT TO APPROPRIATE GROUND WATER

TO THE STATE ENGINEER OF OREGON:

I, Raymond Zollner

of Rt 1 Box 211 Gervais County of Marion
(Mailing address)

State of Oregon, do hereby make application for a certificate of registration as evidence of a right to appropriate ground water.

1. Source from which water is withdrawn is Well #1
(Flowing well, pump well, infiltration trench, or tunnel)

2. Location is: 1 1/2 MI East of Gervais
(Approximate distance and direction from nearest city or town)

and is more particularly described as follows:

(a) 1900 feet west & 300 feet south from E 1/4 corner Section 36
(Give distance and bearing to corner of section or other legal subdivision)

being within NW 1/4 of SE 1/4 of Sec. 36, Twp. 5S, Rge. 2W
(Smallest legal subdivision) (For S.) (For W.)

or (b) within limits of recorded platted property, town or city:

in Lot _____, Block _____ of _____
(Name of plat or addition)

County of _____
(If within city or town, give name)

3. Construction Work was begun on Aug 15 1954; was completed on Sept 1 1954
(Date) (Date)

and the ground water claimed was first used for the purposes set out below on Sept 1 1954
(Date)

since which time the water has been used Seasonally Intermittently
(Continuously or Intermittently)

from Sept 1-51 to 1958
(Date) (Date)

4. Quantity of water claimed and used is 180 gallons per minute; _____ acre feet per year.

5. Purpose or Purposes for which water is used Irrigation
(Domestic, irrigation, municipal, manufacturing, industrial, etc.)

6. Description of Well: Depth 140 feet. Type Drilled
(Dug or drilled)

diameter 10 inches. Elevation of ground at well site 170 feet, mean sea level.
(As near as known)

Depth to water table 31 feet.

7. Capacity of Well: 140 g.p.m. with 85 feet drawdown.

225 g.p.m. with 105 feet drawdown.
265 g.p.m. with 125 feet drawdown.

Date of test _____

If Flowing Well: Measured discharge _____ g.p.m. on _____
(Date)

Shut-in pressure at ground surface _____ lbs. per sq. in. on _____
(Date)

Water is controlled by _____
(Cap. valve, etc.)

If log of well is not available, give name and address of driller. R. Stadeli & Sons

11. Infiltration Trench: Covered or open

Dimensions: Length ft. Minimum depth ft. Maximum depth ft.

Bottom width ft. Discharge g.p.m. Date of test

12. Tunnel: Type of lining

Dimensions:
(Length, course, and cross sectional size)

Position of water bearing stratum with reference to portal of tunnel

Log of tunnel: (Preceding table for log of well may be used, if desired. Give footage from portal and character of materials, as pertinent.)

13. Pumping Equipment:

(a) Pump Jacuzzi Turbine 15 H-P Capacity 180 g.p.m.
(Make, type and size)

(b) Motor Vertical Hollow Shaft Motor 15 H-P
(Type and horsepower)

14. Location of area irrigated or to be irrigated, or place of use if for purposes other than irrigation.

Township North or South	Range E. or W. of Willamette Meridian	Section	Forty-acre Tract	Number Acres To Be Irrigated	Date of Reclamation
5	2-W	36	NW 1/4 of SE 1/4	1.020	Sept. I
5	2-W	36	SW 1/4 of NE 1/4	3.440	Sept. I
5	2-W	36	NW 1/4 of SE 1/4	12.390	Sept. I
				<u>16.99</u>	

15. If the ground water supply is supplemental to an existing water supply, identification of any application for a permit, permit, certificate or adjudicated right to appropriate water made or held by the registrant.

Township 5 S Range 2-W, W.M.
North

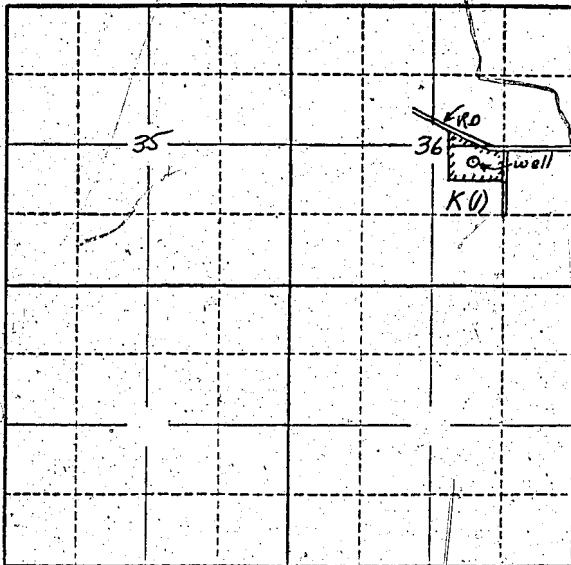

Locate well and acreage of irrigated land on plat.
Scale: 2" = 1 Mile

STATE OF OREGON

County of Marion

ss.

I, _____, being first duly sworn, do hereby certify that I have read the foregoing Registration Statement and that all of the items therein contained are true to the best of my knowledge and belief.

Raymond Gallner
(Signature of Registrant)

Subscribed and sworn to before me this 25th day of February, 1958

My commission expires 12th June 1961

Wm. S. Bartholomew
(Notary Public)

(SEAL)

CERTIFICATE OF REGISTRATION

STATE OF OREGON

County of Marion

ss.

This is to certify that the foregoing Registration Statement was received in the office of the State Engineer on the 25th day of February, 1958, at 9:00 o'clock H. M. and has been duly recorded in said office in Book No. 5 of Registration Statements on page GR-1035 C

Witness my hand this 30th day of June, 1958

Laura A. Stanley
(State Engineer)

By _____
(Deputy)

GR - 1035 C