

Registration No. GR - 1075

Certificate No. GR - 2199

Registration Statement

OF CLAIMANT OF RIGHT TO APPROPRIATE GROUND WATER

TO THE STATE ENGINEER OF OREGON:

I, Arnold J. Moore

of Rt. 3 Bx 39 Boring, Oregon County of Clatsop

State of Oregon, do hereby make application for a certificate of registration as evidence of a right to appropriate ground water.

1. Source from which water is withdrawn is pump well

2. Location is: East by Southeast 1 mi. from Boring, Oregon

and is more particularly described as follows: N 19°30' W, 1995 FEET FROM SE CORNER OF SECTION 6, T. 25, R. 4E

(a) Approx 3/4 mi. North Northwest of Southeast corner of

being within NE 1/4 SE 1/4 of Sec. 6, Twp. 25, Rge. 4E

or (b) within limits of recorded platted property, town or city:

in Lot _____, Block _____ of _____

County of Clatsop

3. Construction Work was begun on 2/1/53; was completed on 2/28/53

and the ground water claimed was first used for the purposes set out below on 6/15/53

since which time the water has been used intermittently (as required for irrigation)

from 6/15/53 to present

4. Quantity of water claimed and used is 150 gallons per minute; 75 acre feet per year.

5. Purpose or Purposes for which water is used irrigation

6. Description of Well: Depth 200 feet. Type drilled

diameter 8 in. inches. Elevation of ground at well site 600 feet, mean sea level.

Depth to water table 35 feet.

7. Capacity of Well: 150 g.p.m. with 165 feet drawdown.

Date of test 2/28/53

If Flowing Well: Measured discharge _____ g.p.m. on _____

Shut-in pressure at ground surface _____ lbs. per sq. in. on _____

Water is controlled by _____

8. Casing: (Give diameter, commercial specifications and depth below ground surface of each casing size.)

8 inch diameter from Surface to 200 feet
 inch diameter from to feet
 inch diameter from to feet
 inch diameter from to feet

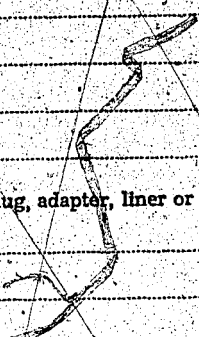

Describe and show depth of shoe, plug, adapter, liner or other details: ~~None~~ Steel Shoe

9. Perforated Casings or Screens:

..... from 130 ft to 165 ft.
 (Number per foot and size of perforations, or describe screen)
 from to
 from to
 from to

10. Log of Well: (Describe each stratum or formation clearly, indicate if water bearing, and give thickness and depth as indicated.)

MATERIAL	Thickness (Feet)	Depth to Bottom (Feet)
Boulders and clay and cement gravel first 100 ft. - from 105 ft. to 110 ft. water bearing gravel. This was not drawn upon because of the probability of surface water.		
Next stratum of water was 135 ft. to 140 ft. and at 160 ft. and 165 ft., both of which were perforated Next large stratum was coarse sand at 170 ft. to 175 ft. which contained a large volume of water that could not be used because of the fear of pumping sand. Silt was hit from 180 ft. to 182 ft. and blue clay was hit at 200 ft. So casing was put to a depth of 200 ft. and drilling was ceased.		

Township 2S Range 4E, W.M.
North

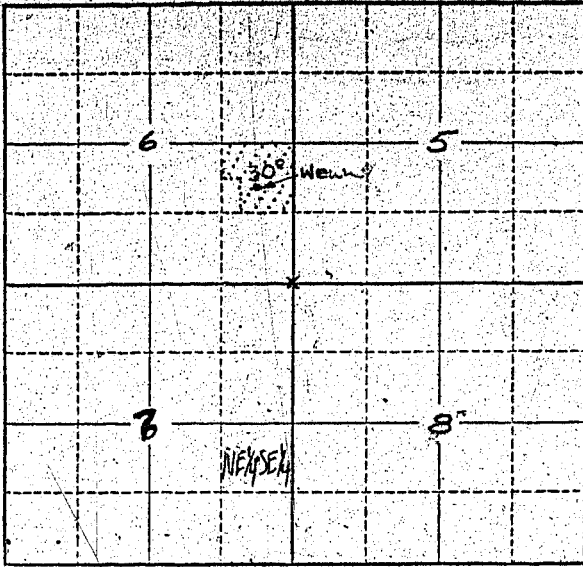

Locate well and acreage of irrigated land on plat.
Scale: 2" = 1 Mile

STATE OF OREGON }
County of Multnomah } ss.

I, Arnold J. Moore, being first duly sworn, do hereby certify that I have read the foregoing Registration Statement and that all of the items therein contained are true to the best of my knowledge and belief.

Arnold J. Moore
(Signature of Registrant)

Subscribed and sworn to before me this 18th day of Feb., 19 58.

My commission expires Oct. 28, 1960
R. H. Russell
(Notary Public)

(SEAL)

CERTIFICATE OF REGISTRATION

STATE OF OREGON }
County of Marion } ss.

This is to certify that the foregoing Registration Statement was received in the office of the State Engineer on the 25th day of February, 1958, at 9:00 o'clock A. M. and has been duly recorded in said office in Book No. 9 of Registration Statements on page GR 2129

Witness my hand this 10th day of March, 19 59
Laura A. Stanley
(State Engineer)

\$15.00

By _____
(Deputy)