

RECEIVED  
MAR. 7 1958  
STATE ENGINEER  
SALEM, OREGON

Registration No. GR-1117

Certificate No. GR-1077

### Registration Statement

#### OF CLAIMANT OF RIGHT TO APPROPRIATE GROUND WATER

TO THE STATE ENGINEER OF OREGON:

I, THORWALD C. ANDERSEN

of 590 Willamette Drive Junction City County of Lane

State of Oregon, do hereby make application for a certificate of registration as evidence of a right to appropriate ground water.

1. Source from which water is withdrawn is PUMP WELL  
(Flowing well, pump well, infiltration trench, or tunnel)

2. Location is: 1 1/2 MILES EAST OF JUNCTION CITY  
(Approximate distance and direction from nearest city or town)

and is more particularly described as follows:

(a) 5303.64 FEET NORTH 5° 07' EAST OF SW COR. SEC. 34  
(Give distance and bearing to corner of section or other legal subdivision)

being within NW 1/4 NW 1/4 of Sec. 34, Twp. 15 S, Rge. 4 W  
(Smallest legal subdivision) (N. or S.) (E. or W.)

or (b) within limits of recorded platted property, town or city:

in Lot 4, Block \_\_\_\_\_ of MILLETT PLAT  
(Name of plat or addition)

County of LANE  
(If within city or town, give name)

3. Construction Work was begun on 1947; was completed on 1947  
(Date) (Date)

and the ground water claimed was first used for the purposes set out below on Summer 1947  
(Date)

from which time the water has been used Inter  
(Continuously or intermittently)

from MAY to September  
(Date) (Date)

4. Quantity of water claimed and used is 275 gallons per minute; 143.25 acre feet per year.

5. Purpose or Purposes for which water is used

Irrigation  
(Domestic, irrigation, municipal, manufacturing, industrial, etc.)

6. Description of Well: Depth 22 feet, Type Driven  
(Dug or drilled)

diameter 3 inches. Elevation of ground at well site 318 feet, mean sea level.  
(As near as known)

Depth to water table 2 feet.

7. Capacity of Well: No. Test g.p.m. with \_\_\_\_\_ feet drawdown.

\_\_\_\_\_ g.p.m. with \_\_\_\_\_ feet drawdown.

Date of test \_\_\_\_\_

If Flowing Well: Measured discharge \_\_\_\_\_ g.p.m. on \_\_\_\_\_  
(Date)

Shut-in pressure at ground surface \_\_\_\_\_ lbs. per sq. in. on \_\_\_\_\_  
(Date)

Water is controlled by \_\_\_\_\_  
(Cap, valve, etc.)





Township 15 S Range 4 W, W.M.  
North

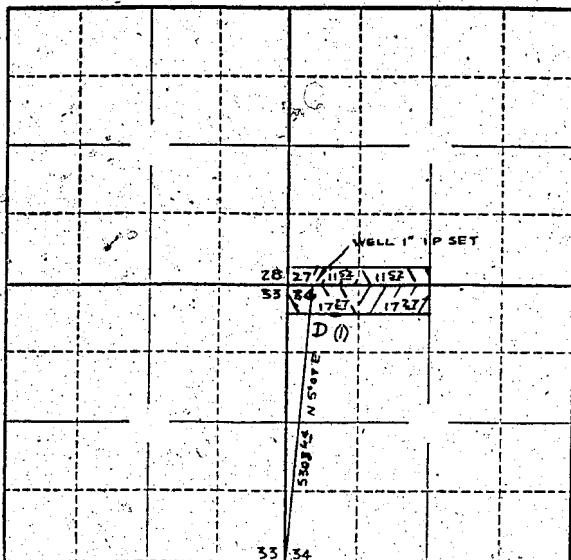

Locate well and acreage of irrigated land on plat.  
Scale: 2" = 1 Mile

STATE OF OREGON

County of Lane } ss.

I, Thorvald C. Andersen, being first duly sworn, do hereby certify that I have read the foregoing Registration Statement and that all of the items therein contained are true to the best of my knowledge and belief.

*Thorvald C. Andersen*  
(Signature of Registrant)

Subscribed and sworn to before me this 12 day of February, 1958.

My commission expires June 2, 1961.

*[Signature]*  
(Notary Public)

(SEAL)

CERTIFICATE OF REGISTRATION

STATE OF OREGON

County of Marion } ss.

This is to certify that the foregoing Registration Statement was received in the office of the State Engineer on the 1 day of March, 1958, at 10 o'clock A.M. and has been duly recorded in said office in Book-No. 6 of Registration Statements on page GR-1077.

Witness my hand this 30th day of June, 1958.

*Laura A. Stanley*  
(State Engineer)

By \_\_\_\_\_ (Deputy)

GR - 1077