

# Registration Statement

## OF CLAIMANT OF RIGHT TO APPROPRIATE GROUND WATER

(Under Chapter 708, Oregon Laws 1955.)

TO THE STATE ENGINEER OF OREGON:

I, F. H. Bourland

of Yamhill 1001 E. 3rd. St. Newberg County of Yamhill

State of Oregon, do hereby make application for a certificate of registration as evidence of a right to appropriate ground water.

1. Source from which water is withdrawn is Pumping well No. 1  
(Flowing well, pump well, infiltration trench, or tunnel)

2. Location is: One (1) Mile West of Lafayette, Oregon  
(Approximate distance and direction from nearest city or town)

and is more particularly described as follows:

(a) 3272' East and 436' North of the most Westerly SW corner of the Millican D.L.C.  
(Give distance and bearing to corner of section or other legal subdivision)

being within SW 1/4 S 11/4 of Sec. 1, Twp. 4S, Rge. 4W  
(Smallest legal subdivision) (N. or S.) (E. or W.)

or (b) within limits of recorded platted property, town or city:

in Lot \_\_\_\_\_, Block \_\_\_\_\_ of \_\_\_\_\_  
(Name of plat or addition)

County of \_\_\_\_\_  
(If within city or town, give name)

3. Construction Work was begun on May 22, 1954; was completed on May 29, 1954  
(Date) (Date)

and the ground water claimed was first used for the purposes set out below on June 1, 1954  
(Date)

since which time the water has been used Continuously  
(Continuously or intermittently)

from June 1, 1954 to 1-17, 1958  
(Date) (Date)

4. Quantity of water claimed and used is 20 gallons per minute; \_\_\_\_\_ acre feet per year.

5. Purpose or Purposes for which water is used Domestic and irrigation

(Domestic, irrigation, municipal, manufacturing, industrial, etc.)

6. Description of Well: Depth 73 feet. Type 3" tight drilled hole  
(Dug or drilled)

diameter 6 inches. Elevation of ground at well site 62 feet, mean sea level.  
(As near as known)

Depth to water table 57 feet.

7. Capacity of Well: 20 g.p.m. with 18' feet drawdown.

\_\_\_\_\_ g.p.m. with \_\_\_\_\_ feet drawdown.

Date of test No actual test.

If Flowing Well: Measured discharge pumping g.p.m. on \_\_\_\_\_  
(Date)

Shut-in pressure at ground surface \_\_\_\_\_ lbs. per sq. in. on \_\_\_\_\_  
(Date)

Water is controlled by \_\_\_\_\_  
(Cap, valve, etc.)

8. <sup>4</sup>Casing: (Give diameter, commercial specifications and depth below ground surface of each casing size.)

6" inch diameter ..... from Top to 79' feet  
 ..... inch diameter ..... from ..... to ..... feet  
 ..... inch diameter ..... from ..... to ..... feet  
 ..... inch diameter ..... from ..... to ..... feet

Describe and show depth of shoe, plug, adapter, liner or other details: None used. Hole drilled tight

9. Perforated Casings or Screens:

Do not have information and driller now in Central America 71' to 77'  
 (Number per foot and size of perforations, or describe screen)  
 ..... from ..... to .....  
 ..... from ..... to .....  
 ..... from ..... to .....

10. Log of Well: (Describe each stratum or formation clearly, indicate if water bearing, and give thickness and depth as indicated.)

MATERIAL	Thickness (Feet)	Depth to Bottom (Feet)
Top soil	0	4
Yellow clay	4	33
Yellow clay & sand	33	57
Sand & gravel	57	75
Coarse sand & gravel	75	79 T.D.

If log of well is not available, give name and address of driller. **E.L.Koeneman**

Address unknown, Now working in Central America

11. Infiltration Trench: Covered or open .....

Dimensions: Length ..... ft. Minimum depth ..... ft. Maximum depth ..... ft.

Bottom width ..... ft. Discharge ..... g.p.m. Date of test .....

12. Tunnel: Type of lining .....

Dimensions: .....  
(Length, course, and cross sectional size)

Position of water bearing stratum with reference to portal of tunnel .....

Log of tunnel: (Preceding table for log of well may be used, if desired. Give footage from portal and character of materials, as pertinent.)

13. Pumping Equipment:

(a) Pump **Jacuzzi** ..... Capacity **28** ..... g.p.m.  
(Make, type and size)

(b) Motor .....  
(Type and horsepower)

14. Location of area irrigated or to be irrigated, or place of use if for purposes other than irrigation.

Township North or South	Range E. or W. of Willamette Meridian	Section	Forty-acre Tract	Number Acres To Be Irrigated	Date of Reclamation
4S	4W	1	SE 1/4 SE 1/4	24.5	1954
4S	4W	1	NW 1/4 SW 1/4	1.0	1955
4S	4W	2	SE 1/4 SE 1/4	3.5	1955
Total to be irrigated				29.0 Acres	<del>1956</del>

15. If the ground water supply is supplemental to an existing water supply, identification of any application for a permit, permit, certificate or adjudicated right to appropriate water made or held by the registrant.  
Ground water only.

Section 1,

Township 4S Range 4W, W.M.  
North

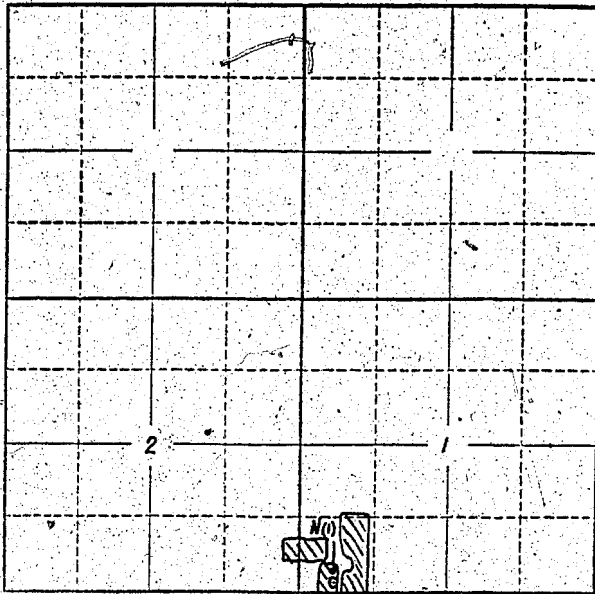

Locate well and acreage of irrigated land on plat.  
Scale: 2" = 1 Mile

STATE OF OREGON

County of Yamhill Marion } SS.

I, F. H. Boushland, being first duly sworn, do hereby certify that I have read the foregoing Registration Statement and that all of the items therein contained are true to the best of my knowledge and belief.

*F. H. Boushland*  
(Signature of Registrant)

Subscribed and sworn to before me this 16<sup>th</sup> day of February, 1956.

My commission expires Sept 8, 1956

*Ch. T. White*  
(Notary Public)

(SEAL)

**CERTIFICATE OF REGISTRATION**

For certificate of registration see page 103K

STATE OF OREGON }  
County of Marion } SS.

This is to certify that the foregoing Registration Statement was received to the office of the State Engineer on the \_\_\_\_\_ day of \_\_\_\_\_ 19\_\_\_\_. It conforms to the requirements of the laws of this State and has been duly recorded in the office of the State Engineer at \_\_\_\_\_ of Registration Statement is on page \_\_\_\_\_.

Construction shall be completed by \_\_\_\_\_ and the water supply shall be applied to \_\_\_\_\_ by \_\_\_\_\_.

Witness my hand this \_\_\_\_\_ day of \_\_\_\_\_ 19\_\_\_\_.

(State Engineer)

By \_\_\_\_\_  
(Deputy)

# Registration Statement

## OF CLAIMANT OF RIGHT TO APPROPRIATE GROUND WATER

(Under Chapter 708, Oregon Laws 1955.)

TO THE STATE ENGINEER OF OREGON:

I, F.H. Bourland

of 1001 E. 3rd. St. Newberg County of Yamhill

State of Oregon, do hereby make application for a certificate of registration as evidence of a right to appropriate ground water.

1. Source from which water is withdrawn is Pumping well No. 2.  
(Flowing well, pump well, infiltration trench, or tunnel)

2. Location is: One (1) Mile West of Lafayette, Oregon  
(Approximate distance and direction from nearest city or town)

and is more particularly described as follows:

(a) 3755' East and 1016' North of the most Westerly SW corner of the Millican D.L.C.  
(Give distance and bearing to corner of section or other legal subdivision)

being within SE 1/4 of Sec. 1, Twp. 4S, Rge. 4W  
(Smallest legal subdivision) (N. or S.) (E. or W.)

or (b) within limits of recorded platted property, town or city:

in Lot \_\_\_\_\_, Block \_\_\_\_\_ of \_\_\_\_\_  
(Name of plat or addition)  
County of \_\_\_\_\_  
(If within city or town, give name)

3. Construction Work was begun on 2-9-1955; was completed on 2-14-1955  
(Date) (Date)

and the ground water claimed was first used for the purposes set out below on April 1955  
(Date)

since which time the water has been used intermittently  
(Continuously or intermittently)

from April 1955 to Oct. 1955  
(Date) (Date)

4. Quantity of water claimed and used is est. 20 gallons per minute; \_\_\_\_\_ acre feet per year.

5. Purpose or Purposes for which water is used irrigation of strawberries and permanent pasture  
(Domestic, irrigation, municipal, manufacturing, industrial, etc.)

6. Description of Well: Depth 88' feet. Type 6" tight hole  
(Dug or drilled)

diameter 6 inches. Elevation of ground at well site 57' feet, mean sea level.  
(As near as known)

Depth to water table 60' feet.

7. Capacity of Well: est. 20 g.p.m. with 20' feet drawdown.

\_\_\_\_\_ g.p.m. with \_\_\_\_\_ feet drawdown.

Date of test No official test made.

If Flowing Well: Measured discharge No g.p.m. on \_\_\_\_\_  
(Date)

Shut-in pressure at ground surface \_\_\_\_\_ lbs. per sq. in. on \_\_\_\_\_  
(Date)

Water is controlled by \_\_\_\_\_  
(Cap, valve, etc.)

8. Casing: (Give diameter, commercial specifications and depth below ground surface of each casing size.)

6 inch diameter ..... from top to bottom 88 feet

..... inch diameter ..... from ..... to ..... feet

..... inch diameter ..... from ..... to ..... feet

..... inch diameter ..... from ..... to ..... feet

Describe and show depth of shoe, plug, adapter, liner or other details: None used

9. Perforated Casings or Screens:

Do not know ..... from ..... to .....  
(Number per foot and size of perforations, or describe screen)

..... from ..... to .....

..... from ..... to .....

..... from ..... to .....

10. Log of Well: (Describe each stratum or formation clearly, indicate if water bearing, and give thickness and depth as indicated.)

MATERIAL	Thickness (Feet)	Depth to Bottom (Feet)
Top soil	0	2
Yellow clay & sandy	2	22
Light yellow clay	22	46
Blue shale	46	51
Yellow clay & sandy	51	60
Yellow sandy hard shale	60	62
sandstone		
Yellow <del>sandy shale</del>	62	70
Blue clay & shale	70	88 T.D.

If log of well is not available, give name and address of driller. E.L.Koensman

Address unknown, Now in Central America

11. Infiltration Trench: Covered or open .....

Dimensions: Length ..... ft. Minimum depth ..... ft. Maximum depth ..... ft.

Bottom width ..... ft. Discharge ..... g.p.m. Date of test .....

12. Tunnel: Type of lining .....

Dimensions: .....

(Length, course, and cross sectional size)

Position of water bearing stratum with reference to portal of tunnel .....

Log of tunnel: (Preceding table for log of well may be used, if desired. Give footage from portal and character of materials, as pertinent.)

13. Pumping Equipment:

(a) Pump Jacuzzi ..... Capacity 28 g.p.m.  
(Make, type and size)

(b) Motor .....  
(Type and horsepower)

14. Location of area irrigated or to be irrigated, or place of use if for purposes other than irrigation.

Township North or South	Range E. or W. of Willamette Meridian	Section	Forty-acre Tract	Number Acres To Be Irrigated	Date of Reclamation
4S	4W	1	SW $\frac{1}{4}$ SW $\frac{1}{4}$	24.5 Acres	1954
4S	4W	1	NW $\frac{1}{4}$ SW $\frac{1}{4}$	1.0 Acre	1955
4S	4W	2	SE $\frac{1}{4}$ SE $\frac{1}{4}$	3.5 Acres	1955
Total to be irrigated				29.0 Acres	

15. If the ground water supply is supplemental to an existing water supply, identification of any application for a permit, permit, certificate or adjudicated right to appropriate water made or held by the registrant.

Ground water only

Section 1,

Township 4S Range 4W, W.M.  
North

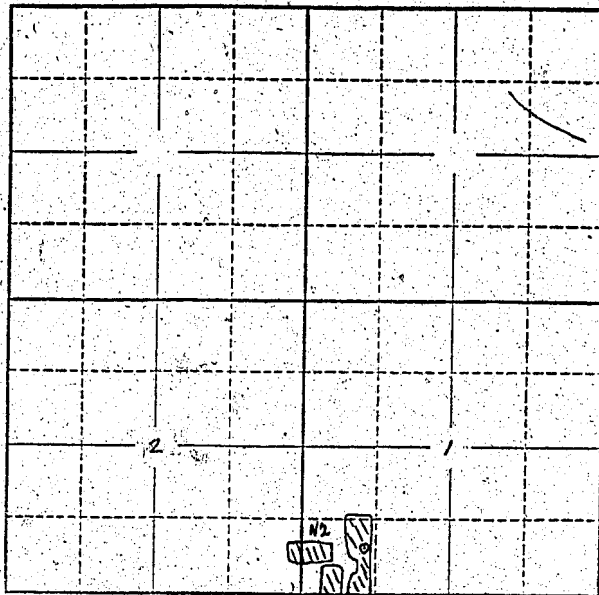

Locate well and acreage of irrigated land on plat.  
Scale: 2" = 1 Mile

STATE OF OREGON

County of Yamhill Marion } ss.

I, E. H. Bauland, being first duly sworn, do hereby certify that I have read the foregoing Registration Statement and that all of the items therein contained are true to the best of my knowledge and belief.

*[Handwritten Signature]*  
(Signature of Registrant)

Subscribed and sworn to before me this 16 day of February, 1956

My commission expires Sept. 8, 1956

*[Handwritten Signature]*  
(Notary Public)

(SEAL)

**CERTIFICATE OF REGISTRATION**

For certificate of registration see page 103K

STATE OF OREGON

County of Marion } ss.

~~This is to certify that the foregoing Registration Statement was received in the office of the State Engineer on the \_\_\_\_\_ day of \_\_\_\_\_ 19\_\_\_\_ and that the same has been duly recorded in the \_\_\_\_\_ of the \_\_\_\_\_ of Registration Statements on page \_\_\_\_\_~~  
~~Construction shall be completed by \_\_\_\_\_ and the water promptly applied to \_\_\_\_\_~~  
~~Waters right in this \_\_\_\_\_~~

\_\_\_\_\_  
(State Engineer)

By \_\_\_\_\_  
(Deputy)



# Registration Statement

OF CLAIMANT OF RIGHT TO APPROPRIATE GROUND WATER  
(Under Chapter 708, Oregon Laws 1955.)

TO THE STATE ENGINEER OF OREGON:

I, F.H. Bourland

of 1001 E. 3rd. St., Newberg, County of Yamhill

State of Oregon, do hereby make application for a certificate of registration as evidence of a right to appropriate ground water.

- 1. Source from which water is withdrawn is Pumping well # 2  
(Flowing well, pumpwell, infiltration trench, or tunnel)
- 2. Location is: One (1) miles West of Lafayette, Oregon  
(Approximate distance and direction from nearest city or town)

and is more particularly described as follows:

(a) 3500± East and 746± North of the most Westerly NW Corner of the Millican D.L.C.  
(Give distance and bearing to corner of section or other legal subdivision)

being within SW<sup>1</sup>/<sub>4</sub> SW<sup>1</sup>/<sub>4</sub> of Sec. 1, Twp. 4S, Rge. 4W  
(Smallest legal subdivision) (N. or S.) (E. or W.)

or (b) within limits of recorded platted property, town or city:

in Lot \_\_\_\_\_, Block \_\_\_\_\_ of \_\_\_\_\_  
(Name of plat or addition)

County of \_\_\_\_\_  
(If within city or town, give name)

3. Construction Work was begun on June 2, 1955; was completed on June 12, 1955  
(Date) (Date)

and the ground water claimed was first used for the purposes set out below on June 14, 1955  
(Date)

since which time the water has been used intermittently  
(Continuously or Intermittently)  
from June 14, 1955 to Oct. 1955.  
(Date) (Date)

4. Quantity of water claimed and used is 140 gallons per minute; \_\_\_\_\_ acre feet per year.

5. Purpose or Purposes for which water is used irrigation

(Domestic, irrigation, municipal, manufacturing, industrial, etc.)

6. Description of Well: Depth 77 feet. Type 20" hole drilled and 6" pipe set and gravel treated.  
(Dug or drilled)  
diameter 6" inches. Elevation of ground at well site 59' feet, mean sea level.  
(As near as known)

Depth to water table 62' feet.

7. Capacity of Well: 40 g.p.m. with 13 feet drawdown.  
\_\_\_\_\_ g.p.m. with \_\_\_\_\_ feet drawdown.

Date of test June 13, 1955

If Flowing Well: Measured discharge pumping g.p.m. on \_\_\_\_\_  
(Date)

Shut-in pressure at ground surface \_\_\_\_\_ lbs. per sq. in. on \_\_\_\_\_  
(Date)

Water is controlled by \_\_\_\_\_  
(Cap, valve, etc.)

8. Casing: (Give diameter, commercial specifications and depth below ground surface of each casing size.)

6" inch diameter ..... from top ..... to bottom 77' feet  
 ..... inch diameter ..... from ..... to ..... feet  
 ..... inch diameter ..... from ..... to ..... feet  
 ..... inch diameter ..... from ..... to ..... feet

Describe and show depth of shoe, plug, adapter, liner or other details: .....  
 6" line and gravel treated. ....

9. Perforated Casings or Screens:

Do not have record ..... from ..... to .....  
 (Number per foot and size of perforations, or describe screen)  
 ..... from ..... to .....  
 ..... from ..... to .....  
 ..... from ..... to .....

10. Log of Well: (Describe each stratum or formation clearly, indicate if water bearing, and give thickness and depth as indicated.)

MATERIAL	Thickness (Feet)	Depth to Bottom (Feet)
Top soil	0	2
Yellow clay	2	25
Blue clay & sand	25	47
Yellow clay & sand	47	62
Sandy shale	62	68
Hard light brown shale	68	77 T.D.

If log of well is not available, give name and address of driller. Arrow Drilling & Supplies,

Newberg, Oregon

11. Infiltration Trench: Covered or open \_\_\_\_\_

Dimensions: Length \_\_\_\_\_ ft. Minimum depth \_\_\_\_\_ ft. Maximum depth \_\_\_\_\_ ft.

Bottom width \_\_\_\_\_ ft. Discharge \_\_\_\_\_ g.p.m. Date of test \_\_\_\_\_

12. Tunnel: Type of lining \_\_\_\_\_

Dimensions: \_\_\_\_\_  
(Length, course, and cross sectional size)

Position of water bearing stratum with reference to portal of tunnel \_\_\_\_\_

Log of tunnel: (Preceding table for log of well may be used, if desired. Give footage from portal and character of materials, as pertinent.)

13. Pumping Equipment:

(a) Pump None installed at this time Capacity \_\_\_\_\_ g.p.m.  
(Make, type and size)

(b) Motor Turbine to be purchased soon  
(Type and horsepower)

14. Location of area irrigated or to be irrigated, or place of use if for purposes other than irrigation.

Township North or South	Range E. or W. of Willamette Meridian	Section	Forty-acre Tract	Number Acres To Be Irrigated	Date of Reclamation
4S	4W	1	SW <sup>1</sup> / <sub>4</sub> SW <sup>1</sup> / <sub>4</sub>	24.5	1954
1S	1W	1	NW <sup>1</sup> / <sub>4</sub> SW <sup>1</sup> / <sub>4</sub>	1.0	1953
1S	1W	2	SE <sup>1</sup> / <sub>4</sub> SE <sup>1</sup> / <sub>4</sub>	3.5	1955
Total area to be irrigated				29.0 Acres	

15. If the ground water supply is supplemental to an existing water supply, identification of any application for a permit, permit, certificate or adjudicated right to appropriate water made or held by the registrant.

Ground water only

Township 45 Range 4W W.M.  
North

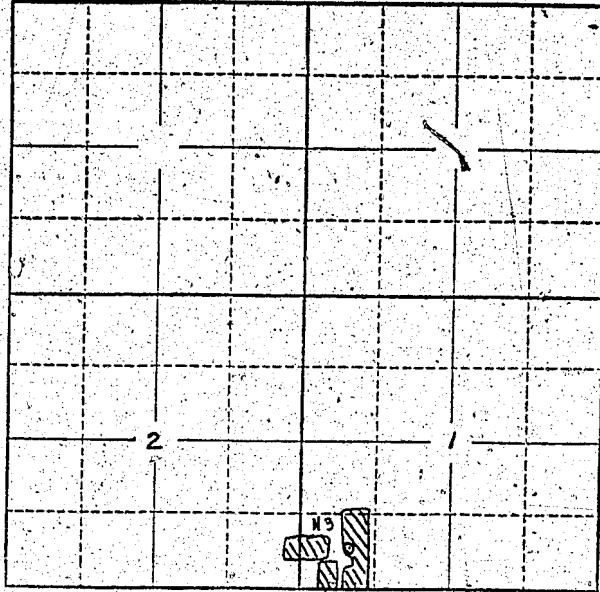

Locate well and acreage of irrigated land on plat.  
Scale: 2" = 1 Mile

STATE OF OREGON

County of Marion } ss.

I, F. H. Bowland, being first duly sworn, do hereby certify that I have read the foregoing Registration Statement and that all of the items therein contained are true to the best of my knowledge and belief.

[Signature]  
(Signature of Registrant)

Subscribed and sworn to before me this 16<sup>th</sup> day of February, 1956

My commission expires Sept. 8, 1956

[Signature]  
(Notary Public)

(SEAL)

**CERTIFICATE OF REGISTRATION**

STATE OF OREGON

County of Marion } ss.

This is to certify that the foregoing Registration Statement was received in the office of the State Engineer on the 16<sup>th</sup> day of February, 1956, at 10:35 o'clock A. M. and has been duly recorded in said office in Book No. 1 of Registration Statements on page GR-103A

~~Construction shall be completed by \_\_\_\_\_ and the water completely applied to beneficial use by \_\_\_\_\_~~

Witness my hand this 12<sup>th</sup> day of April, 1956

[Signature]  
(State Engineer)

By \_\_\_\_\_  
(Deputy)

GR-103.K