

RECEIVED  
STATE ENGINEER  
SALEM, OREGON

Registration No. GR - 1136  
Certificate No. GR - 1096

# Registration Statement

## OF CLAIMANT OF RIGHT TO APPROPRIATE GROUND WATER

TO THE STATE ENGINEER OF OREGON:

I, Andrew Millar

of Box 44 Rt 2 M - Freewater County of Umatilla  
(Mailing address)

State of Oregon, do hereby make application for a certificate of registration as evidence of a right to appropriate ground water.

1. Source from which water is withdrawn is Pump  
(Flowing well, pump well, infiltration trench, or tunnel)

2. Location is: 1 1/2 miles West of Freewater  
(Approximate distance and direction from nearest city or town)

and is more particularly described as follows:

(a) 10 ft N. E. 1/4 Sec 34 T. 12 N. R. 12 E.  
(Give distance and bearing to corner of section or other legal subdivision)

being within S. 1/4 Sec 34 of Sec. 34, Twp. 6 S., Rge. 5  
(Smallest legal subdivision) (N. or S.) (E. or W.)

or (b) within limits of recorded platted property, town or city:

in Lot \_\_\_\_\_, Block \_\_\_\_\_ of \_\_\_\_\_  
(Name of plat or addition)

County of \_\_\_\_\_  
(If within city or town, give name)

3. Construction Work was begun on 1916; was completed on 1917  
(Date) (Date)

and the ground water claimed was first used for the purposes set out below on 1919  
(Date)

since which time the water has been used 100 days each year to irrigate orchard  
(Continuously or intermittently)

from June to August + Sept  
(Date) (Date)

4. Quantity of water claimed and used is 200 gallons per minute; 25 acre feet per year.

5. Purpose or Purposes for which water is used to irrigate orchard + potatoes

(Domestic, irrigation, municipal, manufacturing, industrial, etc.)

6. Description of Well: Depth 40 feet. Type Dug  
(Dug or drilled)

diameter 12 inches. Elevation of ground at well site 1000 feet, mean sea level.  
(As near as known)

Depth to water table 20 feet.

7. Capacity of Well: \_\_\_\_\_ g.p.m. with \_\_\_\_\_ feet drawdown.

\_\_\_\_\_ g.p.m. with \_\_\_\_\_ feet drawdown.

Date of test \_\_\_\_\_

If Flowing Well: Measured discharge \_\_\_\_\_ g.p.m. on \_\_\_\_\_  
(Date)

Shut-in pressure at ground surface \_\_\_\_\_ lbs. per sq. in. on \_\_\_\_\_  
(Date)

Water is controlled by \_\_\_\_\_  
(Cap, valve, etc.)

**8. Casing:** (Give diameter, commercial specifications and depth below ground surface of each casing size.)

..... inch diameter ..... from ..... to ..... feet  
 ..... inch diameter ..... from ..... to ..... feet  
 ..... inch diameter ..... from ..... to ..... feet  
 ..... inch diameter ..... from ..... to ..... feet

Describe and show depth of shoe, plug, adapter, liner or other details: .....

**9. Perforated Casings or Screens:**

..... from ..... to .....  
(Number per foot and size of perforations, or describe screen)  
 ..... from ..... to .....  
 ..... from ..... to .....  
 ..... from ..... to .....

**10. Log of Well:** (Describe each stratum or formation clearly, indicate if water bearing, and give thickness and depth as indicated.)

MATERIAL	Thickness (Feet)	Depth to Bottom (Feet)
<i>small sand</i>		

If log of well is not available, give name and address of driller. ....

11. Infiltration Trench: Covered or open .....

Dimensions: Length ..... ft. Minimum depth ..... ft. Maximum depth ..... ft.

Bottom width ..... ft. Discharge ..... g.p.m. Date of test .....

12. Tunnel: Type of lining .....

Dimensions: .....  
(Length, course, and cross sectional size)

Position of water bearing stratum with reference to portal of tunnel .....

Log of tunnel: (Preceding table for log of well may be used, if desired. Give footage from portal and character of materials as pertinent.)

13. Pumping Equipment:

(a) Pump ..... Capacity ..... g.p.m.  
(Make, type and size)

(b) Motor .....  
(Type and horsepower)

14. Location of area irrigated or to be irrigated, or place of use if for purposes other than irrigation.

Township North or South	Range E. or W. of Williamsite Meridian	Section	Forty-acre Tract	Number Acres To Be Irrigated	Date of Reclamation
G.A.	75E	34	SE 1/4 SW 1/4	9	

15. If the ground water supply is supplemental to an existing water supply, identification of any application for a permit, permit, certificate or adjudicated right to appropriate water made or held by the registrant.

Pleasant View Ditch & Finnis Ditch

Township 6 N. Range 35 E., W.M.  
North

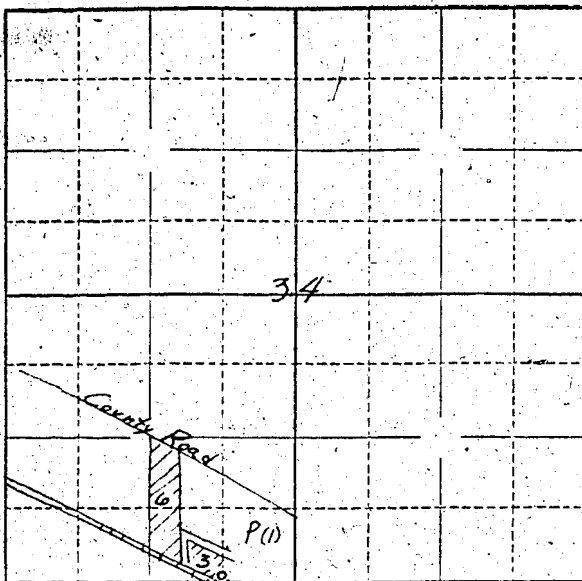

Locate well and acreage of irrigated land on plat.

Scale: 8" = 1 Mile  
4"

STATE OF OREGON

County of Marion

} ss.

I, Andrew Miller, being first duly sworn, do hereby certify that I have read the foregoing Registration Statement and that all of the items therein contained are true to the best of my knowledge and belief.

Andrew Miller  
(Signature of Registrant)

Subscribed and sworn to before me this 15th day of August, 1958

My commission expires 12/31/59

(Notary Public)

(SEAL)

### CERTIFICATE OF REGISTRATION

STATE OF OREGON

County of Marion

} ss.

This is to certify that the foregoing Registration Statement was received in the office of the State Engineer on the 15th day of August, 1958, at 5:00 o'clock A. M. and has been duly recorded in said office in Book No. 6 of Registration Statements on page GR-1096

Witness my hand this 20th day of August, 1958

Lewis A. Stoney  
(State Engineer)

By

(Deputy)

GR - 1096