

Registration Statement

STATE ENGINEER

SALES - OREGON

OF CLAIMANT OF RIGHT TO APPROPRIATE GROUND WATER

TO THE STATE ENGINEER OF OREGON:

I, J. H. Murphy

of R. 2 Box 352

County of Umatilla

State of Oregon, do hereby make application for a certificate of registration as evidence of a right to appropriate ground water.

1. Source from which water is withdrawn is pump well #1
(Flowing well, pump well, infiltration trench, or tunnel)

2. Location is: 1 1/2 mile N.W.
(Approximate distance and direction from nearest city or town)

and is more particularly described as follows:

(a) 3 feet North - 3 feet West of SE Corner of SW 1/4 of NW 1/4
(Give distance and bearing to corner of section or other legal subdivision)
being within N. W. Quarter of Sec. 35, Twp. 6 N, Rge. 35 E. W. M.
(Smallest legal subdivision) (N. or S.) (E. or W.)

or (b) within limits of recorded platted property, town or city:

in Lot _____, Block _____ of _____
(Name of plat or addition)

County of _____
(If within city or town, give name)

3. Construction Work was begun on 1917; was completed on 1917
(Date) (Date)

and the ground water claimed was first used for the purposes set out below on 1917
(Date)

since which time the water has been used CONTINUOUSLY
(Continuously or intermittently)

from June 1 to Oct. 30
(Date) (Date)

4. Quantity of water claimed and used is 300 gallons per minute; _____ acre feet per year.

5. Purpose or Purposes for which water is used _____

IRRIGATION
(Domestic, irrigation, municipal, manufacturing, industrial, etc.)

6. Description of Well: Depth 40 feet. Type Dug
(Dug or drilled)

diameter 9 1/2 inches. Elevation of ground at well site 880 feet, mean sea level.
(As near as known)

Depth to water table 10 feet. June 1st - dry in winter

7. Capacity of Well: 300 g.p.m. with 25 feet drawdown. June - 1957

200 g.p.m. with 38 feet drawdown. Sept. - 1957

Date of test _____

If Flowing Well: Measured discharge _____ g.p.m. on _____
(Date)

Shut-in pressure at ground surface _____ lbs. per sq. in. on _____
(Date)

Water is controlled by _____
(Cap, valve, etc.)

8. Casing: (Give diameter, commercial specifications and depth below ground surface of each casing size.)

8' x 8" ^{SP} inch diameter Concrete from 0 to 10 feet
 inch diameter from to feet
 inch diameter from to feet
 inch diameter from to feet

Describe and show depth of shoe, plug, adapter, liner or other details:

9. Perforated Casings or Screens:

unk from to
 (Number per foot and size of perforations, or describe screen)
 from to
 from to
 from to

10. Log of Well: (Describe each stratum or formation clearly, indicate if water bearing, and give thickness and depth as indicated.)

MATERIAL	Thickness (Feet)	Depth to Bottom (Feet)
top soil	2 ft.	
gravel	38 ft.	

If log of well is not available, give name and address of driller. unk

11. Infiltration Trench: Covered or open
 Dimensions: Length ft. Minimum depth ft. Maximum depth ft.
 Bottom width ft. Discharge g.p.m. Date of test

12. Tunnel: Type of lining
 Dimensions:
(Length, course, and cross sectional size)
 Position of water bearing stratum with reference to portal of tunnel

Log of tunnel: (Preceding table for log of well may be used, if desired. Give footage from portal and character of materials, as pertinent.)

13. Pumping Equipment:
 (a) Pump Pacific Centrifugal Capacity 300 g.p.m.
(Make, type and size)
 (b) Motor Electric 3 H.P.
(Type and horsepower)

14. Location of area irrigated or to be irrigated, or place of use if for purposes other than irrigation.

Township North or South	Range E. or W. of Willamette Meridian	Section	Forty-acre Tract	Number Acres To Be Irrigated	Date of Reclamation
<u>6N</u>	<u>35E.M.</u>	<u>35</u>	<u>SW 1/4 - NW 1/4</u>	<u>10 acre.</u>	<u>1917</u>

15. If the ground water supply is supplemental to an existing water supply, identification of any application for a permit, permit, certificate or adjudicated right to appropriate water made or held by the registrant.

2.41 Acres covered by West Ford Branch of Little Wells Wells - Little Wells Wells Adjudication Proceedings

Township 6N Range 35E W.M.
North

Well location
35 feet North + 3 feet
west of SE ~~1/4~~ Corner
of SW 1/4 of NW 1/4
of Sec 35

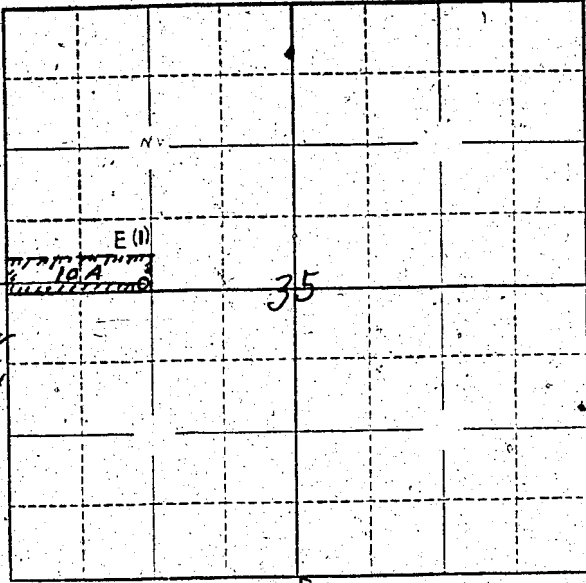

Locate well and acreage of irrigated land on plat.

Scale: $\frac{1}{4}$ " = 1 Mile

STATE OF OREGON

County of _____ } ss.

I, _____, being first duly sworn, do hereby certify that I have read the foregoing Registration Statement and that all of the items therein contained are true to the best of my knowledge and belief.

J. H. Murphy
(Signature of Registrant)

Subscribed and sworn to before me this _____ day of _____, 19____.

My commission expires April _____, _____ (Notary Public)

(SEAL)

CERTIFICATE OF REGISTRATION

STATE OF OREGON

County of Marion } ss.

This is to certify that the foregoing Registration Statement was received in the office of the State Engineer on the _____ day of March, 1958, at 5:00 o'clock P.M. and has been duly recorded in said office in Book No. 6 of Registration Statements on page GR-1115

Witness my hand this 20 day of August, 1958.

Lewis A. Stanley
(State Engineer)

By _____ (Deputy)