

# Registration Statement

## OF CLAIMANT OF RIGHT TO APPROPRIATE GROUND WATER

(Under Chapter 703, Oregon Laws 1955.)

TO THE STATE ENGINEER OF OREGON:

I, J. A. B. King  
of Jefferson County of Marion

State of Oregon, do hereby make application for a certificate of registration as evidence of a right to appropriate ground water.

1. Source from which water is withdrawn is Pump well #1  
(Flowing well, pump well, infiltration trench, or tunnel)
2. Location is: 1 1/2 mile East of Marion  
(Approximate distance and direction from nearest city or town)

and is more particularly described as follows:

(a) 850' North and 340 feet west from south east corner of section 27  
(Give distance and bearing to corner of section on other legal subdivision)

being within SE 1/4 of SE 1/4 of Sec. 27, Twp. 9 S, Rge. 2 W  
(Smallest legal subdivision) (N. or S.) (E. or W.)

or (b) within limits of recorded platted property, town or city:

in Lot \_\_\_\_\_, Block \_\_\_\_\_ of \_\_\_\_\_  
(Name of plat or addition)  
County of Marion  
(If within city or town, give name)

3. Construction Work was begun on Dec 10 - 1948, was completed on Jan 10 1949  
(Date) (Date)

and the ground water claimed was first used for the purposes set out below on May 1949  
(Date)

since which time the water has been used continuously in irrigation  
(Continuously or intermittently)  
from 1949 to 1955  
(Date) (Date)

4. Quantity of water claimed, and used is, 350 gallons per minute; \_\_\_\_\_ acre feet per year.

5. Purpose or Purposes for which water is used Irrigation  
(Domestic, irrigation, municipal, manufacturing, industrial, etc.)

6. Description of Well: Depth 105 feet. Type Drilled  
(Dug or drilled)  
diameter 8 inches. Elevation of ground at well site 325 feet, mean sea level.  
(As near as known)

Depth to water table 25 feet.  
200'

7. Capacity of Well: 300 g.p.m. with 100' feet drawdown.  
75 g.p.m. with \_\_\_\_\_ feet drawdown.

Date of test Jan 10 - 1949

If Flowing Well: Measured discharge \_\_\_\_\_ g.p.m. on \_\_\_\_\_  
(Date)

Shut-in pressure at ground surface \_\_\_\_\_ lbs. per sq. in. on \_\_\_\_\_  
(Date)

Water is controlled by \_\_\_\_\_  
(Cap, valve, etc.)

8. Casing: (Give diameter, commercial specifications and depth below ground surface of each casing size.)

8 inch diameter ..... from 0 to 105 feet  
 ..... inch diameter ..... from ..... to ..... feet  
 ..... inch diameter ..... from ..... to ..... feet  
 ..... inch diameter ..... from ..... to ..... feet

Describe and show depth of shoe, plug, adapter, liner or other details: .....

9. Perforated Casings or Screens:

Mill Slot ..... from 25 to 105  
(Number per foot and size of perforations, or describe screen)  
 ..... from ..... to .....  
 ..... from ..... to .....  
 ..... from ..... to .....

10. Log of Well: (Describe each stratum or formation clearly, indicate if water bearing, and give thickness and depth as indicated.)

MATERIAL	Thickness (Feet)	Depth to Bottom (Feet)
Clay	0	10
Gravel	10	105
from memory		

If log of well is not available, give name and address of driller.

*West*

11. Infiltration Trench: Covered or open \_\_\_\_\_

Dimensions: Length \_\_\_\_\_ ft. Minimum depth \_\_\_\_\_ ft. Maximum depth \_\_\_\_\_ ft.

Bottom width \_\_\_\_\_ ft. Discharge \_\_\_\_\_ g.p.m. Date of test \_\_\_\_\_

12. Tunnel: Type of lining \_\_\_\_\_

Dimensions: \_\_\_\_\_  
(Length, course, and cross sectional size)

Position of water bearing stratum with reference to portal of tunnel \_\_\_\_\_

Log of tunnel: (Preceding table for log of well may be used, if desired. Give footage from portal and character of materials, as pertinent.)

13. Pumping Equipment:

(a) Pump *FM Turbine* Capacity *500* g.p.m.  
(Make, type and size)

(b) Motor *25*  
(Type and horsepower)

14. Location of area irrigated or to be irrigated, or place of use if for purposes other than irrigation.

Township North or South	Range E. or W. of Williamsite Meridian	Section	Forty-acre Tract	Number Acres To Be Irrigated	Date of Reclamation
<i>9 S</i>	<i>2 W</i>	<i>27</i>	<i>NE 1/4 of SE 1/4</i>	<i>32</i>	<i>1950</i>
			<i>NW 1/4 of SE 1/4</i>	<i>18</i>	"
			<i>SW 1/4 of SE 1/4</i>	<i>19</i>	"
			<i>SE 1/4 of SE 1/4</i>	<i>37</i>	"
				<i>106</i>	

15. If the ground water supply is supplemental to an existing water supply, identification of any application for a permit, permit, certificate or adjudicated right to appropriate water made or held by the registrant.

Sec 27 Township 9S Range 2W, W.M.  
North

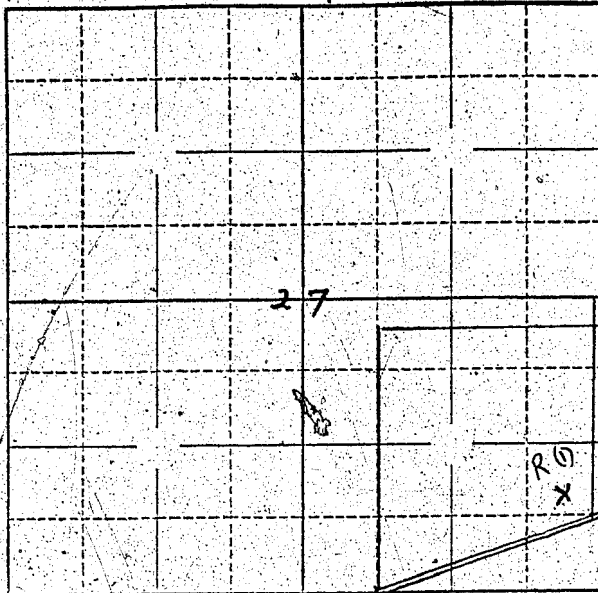

Locate well and acreage of irrigated land on plat.

Scale: 1/4" = 1 Mile

STATE OF OREGON

County of

Marion

ss.

A. B. Hinz

being first duly sworn, do hereby certify that I have read the foregoing Registration Statement and that all of the items therein contained are true to the best of my knowledge and belief.

A. B. Hinz

(Signature of Registrant)

Subscribed and sworn to before me this 16<sup>th</sup> day of February, 1956

My commission expires

Sept. 8, 1956

Chas. J. Wheeler

(Notary Public)

(SEAL)

CERTIFICATE OF REGISTRATION

STATE OF OREGON

County of Marion

ss.

For certificate of registration see page GR-108 G

This is to certify that the foregoing Registration Statement was received in the office of the State Engineer on this \_\_\_\_\_ day of \_\_\_\_\_ 19\_\_\_\_ and has been recorded in said office in Book No. \_\_\_\_\_ of Registration Statements on page \_\_\_\_\_ and construction there completed by \_\_\_\_\_ and the water completely applied to \_\_\_\_\_

Witness my hand this \_\_\_\_\_ day of \_\_\_\_\_ 19\_\_\_\_

(State Engineer)

By

(Deputy)

GR-108 C

# Registration Statement

REGISTRATION NO. GR-117  
CERTIFICATE NO. GR-108

## OF CLAIMANT OF RIGHT TO APPROPRIATE GROUND WATER

(Under Chapter 708, Oregon Laws 1955.)

TO THE STATE ENGINEER OF OREGON:

I, A. B. Heinz  
of Jefferson County of Marion  
State of Oregon, do hereby make application for a certificate of registration as evidence of a right to appropriate ground water.

1. Source from which water is withdrawn is well #2  
(Flowing well, pump well, infiltration trench, or tunnel)

2. Location is: 1 1/2 miles east of Marion  
(Approximate distance and direction from nearest city or town)

and is more particularly described as follows:

(a) 1740 feet west and 500 feet north of SE section corner  
(Give distance and bearing to corner of section or other legal subdivision)

being within SW 1/4 of SE 1/4 of Sec. 27, Twp. 9 S, Rge. 2 W  
(Smallest legal subdivision) (N. or S.) (E. or W.)

or (b) within limits of recorded platted property, town or city:

in Lot \_\_\_\_\_, Block \_\_\_\_\_ of \_\_\_\_\_  
(Name of plat or addition)

County of Marion  
(If within city or town, give name)

3. Construction Work was begun on 1950; was completed on 1950  
(Date) (Date)

and the ground water claimed was first used for the purposes set out below on 1950  
(Date)

since which time the water has been used continuously during season  
(Continuously or Intermittently)

from 1950 to Feb. 1956  
(Date) (Date)

4. Quantity of water claimed and used is 300 gallons per minute; \_\_\_\_\_ acre feet per year.

5. Purpose or Purposes for which water is used Irrigation  
(Domestic, irrigation, municipal, manufacturing, industrial, etc.)

6. Description of Well: Depth 130 feet. Type Dug  
(Dug or drilled)

diameter 8 inches. Elevation of ground at well site 320' feet, mean sea level.  
(As near as known)

Depth to water table 25 feet.

7. Capacity of Well: 300 g.p.m. with 120' feet drawdown.

\_\_\_\_\_ g.p.m. with \_\_\_\_\_ feet drawdown.

Date of test \_\_\_\_\_

If Flowing Well: Measured discharge \_\_\_\_\_ g.p.m. on \_\_\_\_\_  
(Date)

Shut-in pressure at ground surface \_\_\_\_\_ lbs. per sq. in. on \_\_\_\_\_  
(Date)

Water is controlled by \_\_\_\_\_  
(Cap, valve, etc.)

GR-108 D



If log of well is not available, give name and address of driller. West

11. Infiltration Trench: Covered or open

Dimensions: Length ..... ft. Minimum depth ..... ft. Maximum depth ..... ft.

Bottom width ..... ft. Discharge ..... g.p.m. Date of test .....

12. Tunnel: Type of lining

Dimensions: .....  
(Length, course, and cross sectional size)

Position of water bearing stratum with reference to portal of tunnel .....

Log of tunnel: (Preceding table for log of well may be used, if desired. Give footage from portal and character of materials, as pertinent.)

13. Pumping Equipment:

(a) Pump Fairbanks Morse Turbine Capacity 400 g.p.m.  
(Make, type and size)

(b) Motor 25 HP  
(Type and horsepower)

14. Location of area irrigated or to be irrigated, or place of use if for purposes other than irrigation.

Township North or South	Range E. or W. of Willamette Meridian	Section	Forty-acre Tract	Number Acres To Be Irrigated	Date of Reclamation
<u>9 S</u>	<u>2 W</u>	<u>27</u>	<u>NE 1/4 of SE 1/4</u>	<u>32</u>	<u>1950</u>
			<u>NW 1/4 of SE 1/4</u>	<u>18</u>	"
			<u>SW 1/4 of SE 1/4</u>	<u>19</u>	"
			<u>SE 1/4 of SE 1/4</u>	<u>37</u>	"
				<u>106</u>	

15. If the ground water supply is supplemental to an existing water supply, identification of any application for a permit, permit, certificate or adjudicated right to appropriate water made or held by the registrant.



