

RECEIVED
MAR 12 1958

Registration No. GR - 1170

Certificate No. GR - 1131

Registration Statement

STATE ENGINEER
SALEM, OREGON

OF CLAIMANT OF RIGHT TO APPROPRIATE GROUND WATER

TO THE STATE ENGINEER OF OREGON:

I, Dwane M. & Dorothy L. Lehman

of Route 1, Box 89, Eagle Point, County of Jackson
(Mailing address)

State of Oregon, do hereby make application for a certificate of registration as evidence of a right to appropriate ground water.

- 1. Source from which water is withdrawn is pump well
(Flowing well, pump well, infiltration trench, or tunnel)
- 2. Location is: 2.5 miles south of Eagle Point, Oregon
(Approximate distance and direction from nearest city or town)

and is more particularly described as follows:

(a) 245' South and 1565' W. from the E¹ corner Section 15
(Give distance and bearing to corner of section or other legal subdivision)
being within N¹/₂ NW¹/₄ SE¹/₄ of Sec. 15, Twp. 38 S., Rge. 7 W.
(Smallest legal subdivision) (N. or S.) (E. or W.)

or (b) within limits of recorded platted property, town or city:
in Lot _____, Block _____ of _____
(Name of plat or addition)
County of _____
(If within city or town, give name)

3. Construction Work was begun on March 1955; was completed on March 1955
(Date) (Date)

and the ground water claimed was first used for the purposes set out below on May 1955
(Date)
since which time the water has been used continuously
(Continuously or intermittently)
from May 1955 to October 1957
(Date) (Date)

4. Quantity of water claimed and used is 65 gallons per minute; 63 acre feet per year.

5. Purpose or Purposes for which water is used irrigation
(Domestic, irrigation, municipal, manufacturing, industrial, etc.)

6. Description of Well: Depth 131 feet. Type drilled
(Dug or drilled)
diameter 6.0 inches. Elevation of ground at well site 1380 feet, mean sea level.
(As near as known)
Depth to water table 20 feet.

7. Capacity of Well: _____ g.p.m. with _____ feet drawdown.
_____ g.p.m. with _____ feet drawdown.

Date of test none

If Flowing Well: Measured discharge _____ g.p.m. on _____
(Date)

Shut-in pressure at ground surface _____ lbs. per sq. in. on _____
(Date)

Water is controlled by _____
(Cap, valve, etc.)

Township 36.S Range 1.W, W.M.
North

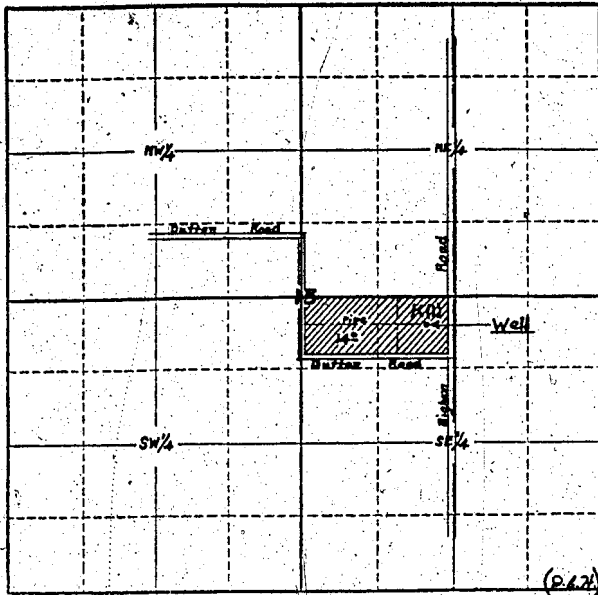

Locate well and acreage of irrigated land on plat.

Scale: 4' = 1 Mile

STATE OF OREGON

County of _____ } ss.

I, _____, being first duly sworn, do hereby certify that I have read the foregoing Registration Statement and that all of the items therein contained are true to the best of my knowledge and belief.

(Signature of Registrant)

Subscribed and sworn to before me this _____ day of _____, 19____.

My commission expires _____
(Notary Public)

(SEAL)

CERTIFICATE OF REGISTRATION

STATE OF OREGON } ss.
County of Marion

This is to certify that the foregoing Registration Statement was received in the office of the State Engineer on the _____ day of _____, 19____, at _____ o'clock _____ M. and has been duly recorded in said office in Book No. 6 of Registration Statements on page GR-1131.

Witness my hand this 28 day of August, 1958.

Lewis A. Stanley
(State Engineer)

By _____
(Deputy)

GR 1131