

RECEIVED  
MAR 14 1958  
STATE ENGINEER  
SALEM, OREGON

Registration No. GR - 1185

Certificate No. GR - 1146

### Registration Statement

#### OF CLAIMANT OF RIGHT TO APPROPRIATE GROUND WATER

TO THE STATE ENGINEER OF OREGON:

I, WILLIAM A. DOHERTY

of P.O. Box 1308, Milton-Freewater County of Umatilla

(Mailing address)

State of OREGON, do hereby make application for a certificate of registration as evidence of a right to appropriate ground water.

1. Source from which water is withdrawn is Pump Well

(Flowing well, pump well, infiltration trench, or tunnel)

2. Location is: 1 1/4 mile north west of Milton-Freewater, Oregon

(Approximate distance and direction from nearest city or town)

and is more particularly described as follows:

(a) 2465 feet west & 635 feet south of the N.E. 1/4 of Section 34

(Give distance and bearing to corner of section or other legal subdivision)

being within NE 1/4 of NW 1/4 of SE 1/4 of Sec. 34, Twp. 6 N, Rge. 35 E

(Smallest legal subdivision)

(N. or S.)

(E. or W.)

or (b) within limits of recorded platted property, town or city:

in Lot \_\_\_\_\_, Block \_\_\_\_\_ of \_\_\_\_\_

(Name of plat or addition)

County of \_\_\_\_\_

(If within city or town, give name)

3. Construction Work was begun on February 1st, 1893 was completed on March 1st, 1919

(Date)

(Date)

and the ground water claimed was first used for the purposes set out below on June 1st, 1893

(Date)

since which time the water has been used continuously

(Continuously or intermittently)

from June each year to October 15th each year to date

(Date)

(Date)

4. Quantity of water claimed and used is 170 to 200 gallons per minute; 90 to 100 acre feet per year.

5. Purpose or Purposes for which water is used to irrigate prune, apple, and cherry orchard

(Domestic, irrigation, municipal, manufacturing, industrial, etc.)

6. Description of Well: Depth 42 feet. Type dug well

(Dug or drilled)

diameter 8 1/2 feet inches. Elevation of ground at well site about 940 feet, mean sea level.

(As near as known)

Depth to water table 10 to 12 feet at beginning of irrigation season

7. Capacity of Well: 350 g.p.m. with 5 to 25 feet drawdown.

g.p.m. with \_\_\_\_\_ feet drawdown.

Date of test \_\_\_\_\_

If Flowing Well: Measured discharge \_\_\_\_\_ g.p.m. on \_\_\_\_\_

(Date)

Shut-in pressure at ground surface \_\_\_\_\_ lbs. per sq. in. on \_\_\_\_\_

(Date)

Water is controlled by \_\_\_\_\_

(Cap, valve, etc.)

8. Casing: (Give diameter, commercial specifications and depth below ground surface of each casing size.)

8 feet by 8 inch diameter concrete, cement curbing from 0 to 12 feet  
 inch diameter from to feet  
 inch diameter from to feet  
 inch diameter from to feet

Describe and show depth of shoe, plug, adapter, liner or other details:

9. Perforated Casings or Screens:

(Number per foot and size of perforations, or describe screen) from to  
 from to  
 from to  
 from to

10. Log of Well: (Describe each stratum or formation clearly, indicate if water bearing, and give thickness and depth as indicated.)

MATERIAL	Thickness (Feet)	Depth to Bottom (Feet)
Top Soil	2 feet	2 feet
Gravel	10 feet	12 feet
Cement Gravel	30 feet	42 feet

If log of well is not available, give name and address of driller.

11. Infiltration Trench: Covered or open  
 Dimensions: Length ..... ft. Minimum depth ..... ft. Maximum depth ..... ft.

Bottom width ..... ft. Discharge ..... g.p.m. Date of test .....

12. Tunnel: Type of lining .....

Dimensions: .....  
(Length, course, and cross sectional size)

Position of water bearing stratum with reference to portal of tunnel .....

Log of tunnel: (Preceding table for log of well may be used, if desired. Give footage from portal and character of materials, as pertinent.)

13. Pumping Equipment: 8 inch bowl - 2 stage vertical

(a) Pump Turbine pump 4 inch column Capacity 350 g.p.m.  
(Make, type and size)

(b) Motor 5 Horse Power - Electric  
(Type and horsepower)

14. Location of area irrigated or to be irrigated, or place of use if for purposes other than irrigation.

Township North or South	Range E. or W. of Willamette Meridian	Section	Forty-acre Tract	Number Acres To Be Irrigated	Date of Reclamation
6 N	35 E	34	NW 1/4 of SE 1/4	10 acres	1893

15. If the ground water supply is supplemental to an existing water supply, identification of any application for a permit, permit, certificate or adjudicated right to appropriate water made or held by the registrant.  
 Flood Water Right under Pleasant View Irrigation Company.  
 ( No right after June 15th, usually)

Township 6 N Range 35 E, W.M.

North.

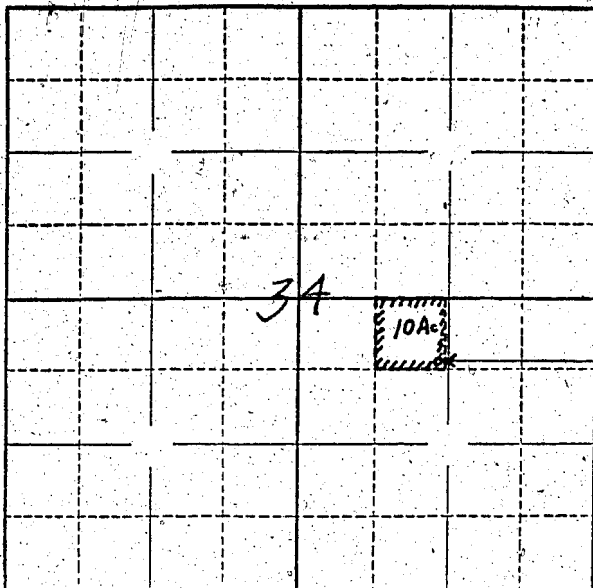

well location  
2465 feet west  
635 feet south of  
E<sub>2</sub> corner of Section  
34

Locate well and acreage of irrigated land on plat.

Scale: ~~20~~ 4" = 1 Mile.

STATE OF OREGON

County of \_\_\_\_\_

} ss.

I, William A. Doherty, being first duly sworn, do hereby certify that I have read the foregoing Registration Statement and that all of the items therein contained are true to the best of my knowledge and belief.

*William A. Doherty*  
(Signature of Registrant)

Subscribed and sworn to before me this 17 day of March, 1958.

My commission expires 1/1/59

(Notary Public)

(SEAL)

**CERTIFICATE OF REGISTRATION**

STATE OF OREGON

County of Marion

} ss.

This is to certify that the foregoing Registration Statement was received in the office of the State Engineer on the 17 day of March, 1958, at 1:00 o'clock P. M. and has been duly recorded in said office in Book No. 6 of Registration Statements on page GR-1146

Witness my hand this 28 day of August, 1958.

*Laura A. Stanley*  
(State Engineer)

By \_\_\_\_\_

(Deputy)