

RECEIVED
MAR 17 1958
STATE ENGINEER
SALEM, OREGON

REGISTRATION NO. GR-1200
CERTIFICATE NO. GR-1318

Registration Statement

OF CLAIMANT OF RIGHT TO APPROPRIATE GROUND WATER

(Under Chapter 708, Oregon Laws 1955.)

TO THE STATE ENGINEER OF OREGON:

I, Ejner P. Christiansen, 333 River Rd.
of Junction City County of Lane

State of Oregon, do hereby make application for a certificate of registration as evidence of a right to appropriate ground water.

1. Source from which water is withdrawn is pump well
(Flowing well, pump well, infiltration trench, or tunnel)

2. Location is: 1/2 mile east of Junction City
(Approximate distance and direction from nearest city or town)

and is more particularly described as follows: 750 feet North & 570 feet West from SE corner Section 32

(a) 45 rods to South east section corner
(Give distance and bearing to corner of section or other legal subdivision)
being within S. E. 1/4 of SE 1/4 of Sec. 32, Twp. 15 S, Rge. 4 W
(Smallest legal subdivision) (N. or S.) (E. or W.)

or (b) within limits of recorded platted property, town or city:
in Lot _____, Block _____ of _____
(Name of plat or addition)

County of _____
(If within city or town, give name)

3. Construction Work was begun on May 13, 1947, was completed on May 13, 1947
(Date) (Date)

and the ground water claimed was first used for the purposes set out below on May 13, 1947,
(Date)

since which time the water has been used intermittently during season
(Continuously or intermittently)

from May 1947 to Oct. 1957
(Date) (Date)

4. Quantity of water claimed and used is 100 gallons per minute; 37 1/2 acre feet per year.

5. Purpose or Purposes for which water is used irrigation
(Domestic, irrigation, municipal, manufacturing, industrial, etc.)

6. Description of Well: Depth 25 feet. Type drilled driven
(Dug or drilled)

diameter 3 inches. Elevation of ground at well site _____ feet, mean sea level.
(As near as known)

Depth to water table 6 feet.

7. Capacity of Well: 50 g.p.m. with 2 feet drawdown.
100 g.p.m. with not checked feet drawdown.

Date of test May 13 1947

If Flowing Well: Measured discharge _____ g.p.m. on _____
(Date)

Shut-in pressure at ground surface _____ lbs. per sq. in. on _____
(Date)

Water is controlled by _____
(Cap, valve, etc.)

8. Casing: (Give diameter, commercial specifications and depth below ground surface of each casing size.)

3 inch diameter steel pipe from 0 to 25 feet
 inch diameter from to feet
 inch diameter from to feet
 inch diameter from to feet

Describe and show depth of shoe, plug, adapter, liner or other details:

9. Perforated Casings or Screens:

Casing perforated amount of holes from 21 to 25 ft
(Number per foot and size of perforations, or describe screen)
 from to
 from to
 from to

10. Log of Well: (Describe each stratum or formation clearly, indicate if water bearing, and give thickness and depth as indicated.)

MATERIAL	Thickness (Feet)	Depth to Bottom (Feet)
Willamette loam	4	4
Gravel	21	25

If log of well is not available, give name and address of driller.

11. Infiltration Trench: Covered or open

Dimensions: Length ft. Minimum depth ft. Maximum depth ft.

Bottom width ft. Discharge g.p.m. Date of test

12. Tunnel: Type of lining

Dimensions:
(Length, course, and cross sectional size)

Position of water bearing stratum with reference to portal of tunnel

Log of tunnel: (Preceding table for log of well may be used, if desired. Give footage from portal and character of materials, as pertinent.)

13. Pumping Equipment:

(a) Pump *Belt driven centrifugal* Capacity *100* g.p.m.
(Make, type and size)

(b) Motor *9 H.P. gasoline*
(Type and horsepower)

14. Location of area irrigated or to be irrigated, or place of use if for purposes other than irrigation.

Township North or South	Range E. or W. of Willamette Meridian	Section	Forty-acre Tract	Number Acres To Be Irrigated	Date of Reclamation
<i>TWP 15S</i>	<i>4W</i>	<i>32</i>	<i>SE 1/4 of SE 1/4</i>	<i>15.2</i>	<i>1947 ?</i>

15. If the ground water supply is supplemental to an existing water supply, identification of any application for a permit, permit, certificate or adjudicated right to appropriate water made or held by the registrant.

Township 15 S Range 4 W, W.M.
North

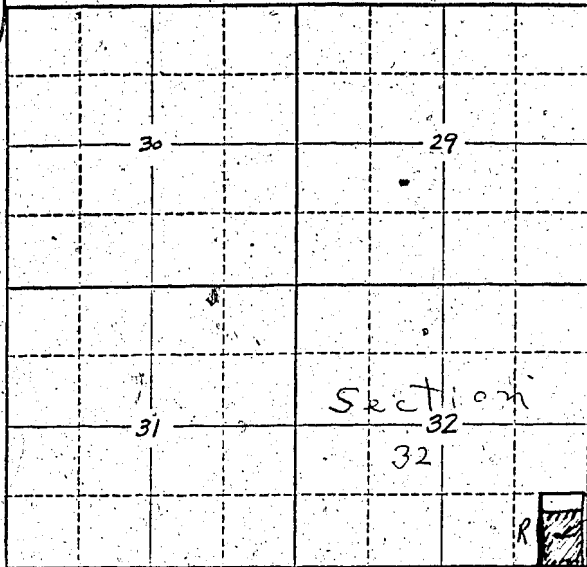

Locate well and acreage of irrigated land on plat.

Scale: 2" = 1 Mile

STATE OF OREGON

County of Lane } ss.

I, Ejner Christiansen, being first duly sworn, do hereby certify that I have read the foregoing Registration Statement and that all of the items therein contained are true to the best of my knowledge and belief.

Ejner Christiansen
(Signature of Registrant)

Subscribed and sworn to before me this 14th day of March, 1958.

My commission expires June 25 1961
(Notary Public)

(SEAL)

CERTIFICATE OF REGISTRATION

STATE OF OREGON

County of Marion } ss.

This is to certify that the foregoing Registration Statement was received in the office of the State Engineer on the 17 day of March, 1958, at 1:00 o'clock P.M. and has been duly recorded in said office in Book No. 6 of Registration Statements on page GR-1318

~~of such nature shall be completed by~~
~~and the work completed by~~
~~of such nature shall be completed by~~

Witness my hand this 20th day of October, 1958.

Lawrence J. [Signature]
(State Engineer)

By _____ (Deputy)

GR-1318