

RECEIVED

MAR 4 1958

STATE ENGINEER
SALEM, OREGON

Registration No. GR - 1210

Certificate No. GR - 1170

Registration Statement

OF CLAIMANT OF RIGHT TO APPROPRIATE GROUND WATER

TO THE STATE ENGINEER OF OREGON:

I, HENRY L AND GRACE E. PRICE

of Route 2 Box 903 Junction City County of Linn

State of Oregon, do hereby make application for a certificate of registration as evidence of a right to appropriate ground water.

1. Source from which water is withdrawn is ~~Flowing Well~~ PUMP WELL # 2
(Flowing well, pump well, infiltration branch, or tunnel)

2. Location is: 4 miles north Junction City Oregon
(Approximate distance and direction from nearest city or town)

and is more particularly described as follows:

(a) 1900 feet west & 450 feet south from NE corner Section 18
(Give distance and bearing to corner of section or other legal subdivision)

being within NE 1/4 of NE 1/4 of Sec. 18, Twp. 15 S, Rge. 4 W
(Smallest legal subdivision) (N. or S.) (E. or W.)

or (b) within limits of recorded platted property, town or city:

in Lot 7, Block _____ of JUNCTION
(Name of plat or addition)

County of _____
(If within city or town, give name)

3. Construction Work was begun on unknown when purchase made 1950; was completed on _____
(Date) (Date)

and the ground water claimed was first used for the purposes set out below on 1950
(Date)

since which time the water has been used INTERMITTENTLY
(Continuously or intermittently)

from 1951 to 1951
(Date) (Date)

4. Quantity of water claimed and used is 75 gpm gallons per minute; _____ acre feet per year.

5. Purpose or Purposes for which water is used _____

irrigation
(Domestic, irrigation, municipal, manufacturing, industrial, etc.)

6. Description of Well: Depth 2.1 feet. Type Drum
(Dug or drilled)

diameter 4 inches. Elevation of ground at well site 200 feet, mean sea level.
(As near as known)

Depth to water table 13 feet.

7. Capacity of Well: 7000 g.p.m. with 6 feet drawdown.

7000 g.p.m. with 6 feet drawdown.

Date of test April 16, 1951

If Flowing Well: Measured discharge _____ g.p.m. on _____
(Date)

Shut-in pressure at ground surface _____ lbs. per sq. in. on _____
(Date)

Water is controlled by _____
(Cap. valve, etc.)

8. Casing: (Give diameter, commercial specifications and depth below ground surface of each casing size.)

4 inch diameter Pipe from 0 to 21 feet
 inch diameter from to feet
 inch diameter from to feet
 inch diameter from to feet

Describe and show depth of shoe, plug, adapter, liner or other details:

9. Perforated Casings or Screens:

unk from to
 (Number per foot and size of perforations, or describe screen.)
 from to
 from to
 from to

10. Log of Well: (Describe each stratum or formation clearly, indicate if water bearing, and give thickness and depth as indicated.)

MATERIAL	Thickness (Feet)	Depth to Bottom (Feet)
<u>unk</u>		

If log of well is not available, give name and address of driller. _____

11. Infiltration Trench: Covered or open _____

Dimensions: Length _____ ft. Minimum depth _____ ft. Maximum depth _____ ft.

Bottom width _____ ft. Discharge _____ g.p.m. Date of test _____

12. Tunnel: Type of lining _____

Dimensions: _____
(Length, course, and cross sectional size)

Position of water bearing stratum with reference to portal of tunnel _____

Log of tunnel: (Preceding table for log of well may be used, if desired. Give footage from portal and character of materials, as pertinent.)

13. Pumping Equipment:

(a) Pump Portable Pump 2" 2 1/2" 2 1/2" 2 1/2" Capacity 75 g.p.m.
(Make, type and size)

(b) Motor 30
(Type and horsepower)

14. Location of area irrigated or to be irrigated, or place of use if for purposes other than irrigation.

Township North or South	Range E or W. of Willamette Meridian	Section	Forty-acre Tract	Number Acres To Be Irrigated	Date of Reclamation
T5S	7W	18	[scribble]	[scribble]	75
T15S	R4W	18	[scribble]	[scribble]	
"	"	"	[scribble]	[scribble]	
T15S	R4W	18	NW 1/4 + NE 1/4	28 ² total	1950

15. If the ground water supply is supplemental to an existing water supply, identification of any application for a permit, permit, certificate or adjudicated right to appropriate water made or held by the registrant.

Township 155 Range 4W W.M.

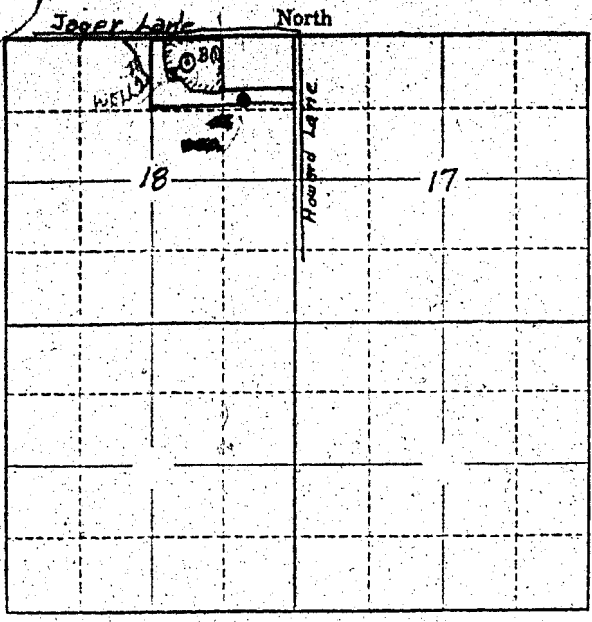

Locate well and acreage of irrigated land on plat.

Scale: 2" = 1 Mile

STATE OF OREGON

County of Linn } ss.

I, Henry J. Pace & Erna E. Pace being first duly sworn, do hereby certify that I have read the foregoing Registration Statement and that all of the items therein contained are true to the best of my knowledge and belief.

Henry J. Pace & Erna E. Pace
(Signature of Registrant)

Subscribed and sworn to before me this 3rd day of March, 1958

My commission expires Aug. 10, 1959

Ray - Ylu
(Notary Public)

(SEAL)

CERTIFICATE OF REGISTRATION

STATE OF OREGON

County of Marion } ss.

This is to certify that the foregoing Registration Statement was received in the office of the State Engineer on the 4th day of March, 1958, at 11 o'clock A. M. and has been duly recorded in said office in Book No. 6 of Registration Statements on page GR-1170

Witness my hand this 17 day of September, 1958

Lewis A. Stanley
(State Engineer)

\$ 15.00

By _____ (Deputy)

GR-1170