

RECEIVED  
MAR 18 1958  
STATE ENGINEER  
BUREAU OF ENGINEERING

Registration No. GR - 1211  
Certificate No. GR - 1171

# Registration Statement

## OF CLAIMANT OF RIGHT TO APPROPRIATE GROUND WATER

TO THE STATE ENGINEER OF OREGON:

I, Henry and Grace K. Price  
of Price Construction County of Washington  
(Mailing address)

State of Oregon, do hereby make application for a certificate of registration as evidence of a right to appropriate ground water.

1. Source from which water is withdrawn is Pump Well #1  
(Flowing well, pump well, infiltration trench, or tunnel)

2. Location is: 4 Miles North Junction of Oregon  
(Approximate distance and direction from nearest city or town)

and is more particularly described as follows:

(a) 200 Feet x 1150 Feet  
(Give distance and bearing to corner of section or other legal subdivision)

being within NE 1/4 of Sec. 15, Twp. 15N, Rge. 7W  
(Smallest legal subdivision) (N. or S.) (E. or W.)

or (b) within limits of recorded platted property, town or city:

in Lot 7, Block 8 of Map  
(Name of plat or addition)

County of \_\_\_\_\_  
(If within city or town, give name)

3. Construction Work was begun on \_\_\_\_\_; was completed on \_\_\_\_\_  
(Date) (Date)

and the ground water claimed was first used for the purposes set out below on \_\_\_\_\_  
(Date)

since which time the water has been used \_\_\_\_\_  
(Continuously or intermittently)

from 1957 to 1957  
(Date) (Date)

4. Quantity of water claimed and used is 7.5 GPM gallons per minute; \_\_\_\_\_ acre feet per year.

5. Purpose or Purposes for which water is used \_\_\_\_\_  
(Domestic, irrigation, municipal, manufacturing, industrial, etc.)

6. Description of Well: Depth \_\_\_\_\_ feet. Type \_\_\_\_\_  
(Dug or drilled)

diameter \_\_\_\_\_ inches. Elevation of ground at well site 290 feet, mean sea level.  
(As near as known)

Depth to water table \_\_\_\_\_ feet.

7. Capacity of Well: \_\_\_\_\_ g.p.m. with \_\_\_\_\_ feet drawdown.

\_\_\_\_\_ g.p.m. with \_\_\_\_\_ feet drawdown.

Date of test \_\_\_\_\_

If Flowing Well: Measured discharge \_\_\_\_\_ g.p.m. on \_\_\_\_\_  
(Date)

Shut-in pressure at ground surface \_\_\_\_\_ lbs. per sq. in. on \_\_\_\_\_  
(Date)

Water is controlled by \_\_\_\_\_  
(Cap, valve, etc.)





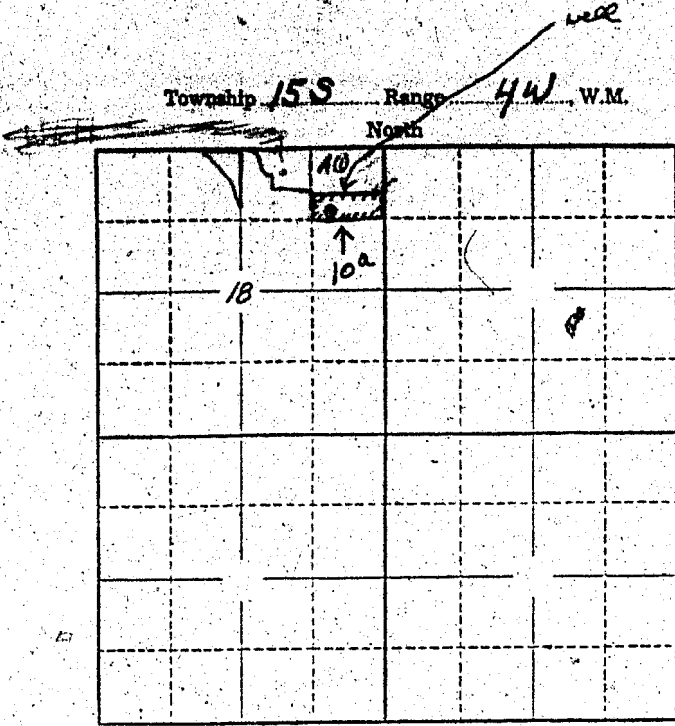

STATE OF OREGON

County of Linn } ss.

I, Henry Pace, being first duly sworn, do hereby certify that I have read the foregoing Registration Statement and that all of the items therein contained are true to the best of my knowledge and belief.

Henry Pace  
(Signature of Registrant)

Subscribed and sworn to before me this 4th day of April, 1958

My commission expires 8/10/59

Ray John  
(Notary Public)

(SEAL)

**CERTIFICATE OF REGISTRATION**

STATE OF OREGON

County of Marion } ss.

This is to certify that the foregoing Registration Statement was received in the office of the State Engineer on the 18th day of March, 1958, at 10:00 o'clock A.M. and has been duly recorded in said office in Book No. 6 of Registration Statements on page GR-1171

Witness my hand this 17 day of September, 1958

Henry A. Stanley  
(State Engineer)

By \_\_\_\_\_ (Deputy)

GR - 1171