

Registration Statement CERTIFICATE NO. GR-1194

OF CLAIMANT OF RIGHT TO APPROPRIATE GROUND WATER

(Under Chapter 708, Oregon Laws 1955.)

TO THE STATE ENGINEER OF OREGON: ✓

I, Ray Woodruff Ruth Miller

of Rte 1 Box 61 Independence County of Folk

State of Oregon, do hereby make application for a certificate of registration as evidence of a right to appropriate ground water.

1. Source from which water is withdrawn is pump well #1
(Flowing well, pump well, infiltration trench, or tunnel)

2. Location is: 6 miles Southwest of Independence
(Approximate distance and direction from nearest city or town)

and is more particularly described as follows:

(a) 2019.50 feet N. 73° 28' E. from the Southwest corner of Sec. 12, T. 9S., R. 4 W
(Give distance and bearing to corner of section or other legal subdivision)

being within SE 1/4 of SW 1/4 of Sec. 12, Twp. 9 S, Rge. 4 W
(Smallest legal subdivision) (N. or S.) (E. or W.)

or (b) within limits of recorded platted property, town or city:

in Lot _____ Block _____ of _____
(Name of plat or addition)

County of _____
(If within city or town, give name)

3. Construction Work was begun on Oct 10, 1951; was completed on Oct 11, 1951
(Date) (Date)

and the ground water claimed was first used for the purposes set out below on July 1951
(Date)

since which time the water has been used Continuously
(Continuously or intermittently)

from July 1951 to Sept 1, 1957
(Date) (Date)

4. Quantity of water claimed and used is 600 gallons per minute; _____ acre feet per year.

5. Purpose or Purposes for which water is used irrigation

(Domestic, irrigation, municipal, manufacturing, industrial, etc.)

6. Description of Well: Depth 36 feet. Type drilled
(Dug or drilled)

diameter 10" inches. Elevation of ground at well site 165' feet, mean sea level.
(As near as known)

Depth to water table 14 feet.

7. Capacity of Well: 600 g.p.m. with 3 feet drawdown.

_____ g.p.m. with _____ feet drawdown.

Date of test June 1957

If Flowing Well: Measured discharge _____ g.p.m. on _____
(Date)

Shut-in pressure at ground surface _____ lbs. per sq. in. on _____
(Date)

Water is controlled by _____
(Cap. valve, etc.)

8. Casing: (Give diameter, commercial specifications and depth below ground surface of each casing size.)

10" inch diameter 0' from 0' to 36' feet
..... inch diameter from to feet
..... inch diameter from to feet
..... inch diameter from to feet

Describe and show depth of shoe, plug, adapter, liner or other details:
.....
.....
.....

9. Perforated Casings or Screens:

..... from 26' to 32'
(Number per foot and size of perforations, or describe screen)
..... from to
..... from to
..... from to

10. Log of Well: (Describe each stratum or formation clearly, indicate if water bearing, and give thickness and depth as indicated.)

MATERIAL	Thickness (Feet)	Depth to Bottom (Feet)
sand	15	15
fine sand	21	36

If log of well is not available, give name and address of driller. *Bill Hamilton*

11. Infiltration Trench: Covered or open

Dimensions: Length ft. Minimum depth ft. Maximum depth ft.

Bottom width ft. Discharge g.p.m. Date of test

12. Tunnel: Type of lining

Dimensions:
(Length, course, and cross sectional size)

Position of water bearing stratum with reference to portal of tunnel

Log of tunnel: (Preceding table for log of well may be used, if desired. Give footage from portal and character of materials, as pertinent.)

13. Pumping Equipment:

(a) Pump *Cotnell, centrifugal, 4"* Capacity *640* g.p.m.
(Make, type and size)

(b) Motor *electric, 30 H.P.*
(Type and horsepower)

14. Location of area irrigated or to be irrigated, or place of use if for purposes other than irrigation.

Township North or South	Range E. or W. of Willamette Meridian	Section	Forty-acre Tract	Number Acres To Be Irrigated	Date of Reclamation
9 S	4 W	12	NE $\frac{1}{4}$ SW $\frac{1}{4}$	8.5	<i>May 1955</i>
9 S	4 W	12	SE $\frac{1}{4}$ SW $\frac{1}{4}$	36.0	<i>July 1951</i>
9 S	4 W	15	NE $\frac{1}{4}$ NW $\frac{1}{4}$	<u>20.5</u>	<i>May 1955</i>
				65.0 acres total	

15. If the ground water supply is supplemental to an existing water supply, identification of any application for a permit, permit, certificate or adjudicated right to appropriate water made or held by the registrant.

Township 9.5 Range 4. W W.M.

North

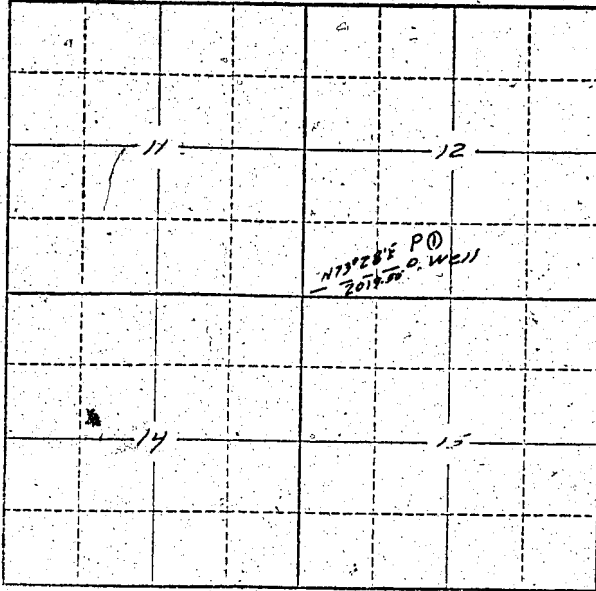

Locate well and acreage of irrigated land on plat.

Scale: 2" = 1 Mile.

STATE OF OREGON

County of Marion } ss.

I, Ruth Miller, being first duly sworn, do hereby certify that I have read the foregoing Registration Statement, and that all of the items therein contained are true to the best of my knowledge and belief.

Ruth Miller
(Signature of Registrant)

Subscribed and sworn to before me this 24 day of March, 1958.

My commission expires 9/27/58

Jeanie Baxter
(Notary Public)

(SEAL)

CERTIFICATE OF REGISTRATION

STATE OF OREGON }
County of Marion } ss.

This is to certify that the foregoing Registration Statement was received in the office of the State Engineer on the 24 day of March, 1958, at 11:30 o'clock A.M. and has been duly recorded in said office in Book No. 6 of Registration Statements on page GR-1194

Witness my hand this 17 day of September, 1958

Lewis A. Stanley
(State Engineer)

By _____ (Deputy)

GR-1194