

RECEIVED
MAR 24 1958
STATE ENGINEER
SALEM, OREGON

Registration No. GR - 1237

Certificate No. GR - 1196

Registration Statement

OF CLAIMANT OF RIGHT TO APPROPRIATE GROUND WATER

TO THE STATE ENGINEER OF OREGON:

I, VINCENT GLOVER

of 1550 MAPLE DR. JUNCTION CITY County of LANE
(Mailing address)

State of OREGON, do hereby make application for a certificate of registration as evidence of a right to appropriate ground water.

1. Source from which water is withdrawn is PUMP WELL
(Flowing well, pump well, infiltration trench, or tunnel)

2. Location is: 5 MILES S.E. OF JUNCTION CITY, OREGON
(Approximate distance and direction from nearest city or town)

and is more particularly described as follows:

(a) N. 73° 25' E. 2.140' FROM THE SW. COR. OF SEC. 17
(Give distance and bearing to corner of section or other legal subdivision)

being within SE 1/4 SW 1/4 of Sec. 17, Twp. 16 S, Rge. 4 W
(Smallest legal subdivision) (N. or S.) (E. or W.)

or (b) within limits of recorded platted property, town or city:

in Lot _____, Block _____ of _____
(Name of plat or addition)

County of _____
(If within city or town, give name)

3. Construction Work was begun on JUNE 1949; was completed on JUNE 1949
(Date) (Date)

and the ground water claimed was first used for the purposes set out below on JULY 1st 1949
(Date)

since which time the water has been used CONTINUOUSLY
(Continuously or intermittently)

from JULY 1 1949 to SEPT. 1958
(Date) (Date)

4. Quantity of water claimed and used is 200 gallons per minute; 20 acre feet per year.

5. Purpose or Purposes for which water is used IRRIGATION

(Domestic, irrigation, municipal, manufacturing, industrial, etc.)

6. Description of Well: Depth 20 feet. Type 2-3" PIPES DRIVEN 6' APART
(Dug or drilled)

diameter 2-3" APART inches. Elevation of ground at well site 345 feet, mean sea level.
(As near as known)

Depth to water table 8 feet.

7. Capacity of Well: UNKNOWN g.p.m. with _____ feet drawdown.

_____ g.p.m. with _____ feet drawdown.

Date of test _____

If Flowing Well: Measured discharge _____ g.p.m. on _____
(Date)

Shut-in pressure at ground surface _____ lbs. per sq. in. on _____
(Date)

Water is controlled by _____
(Cap, valve, etc.)

Township 16 S Range 4 W W.M.
North

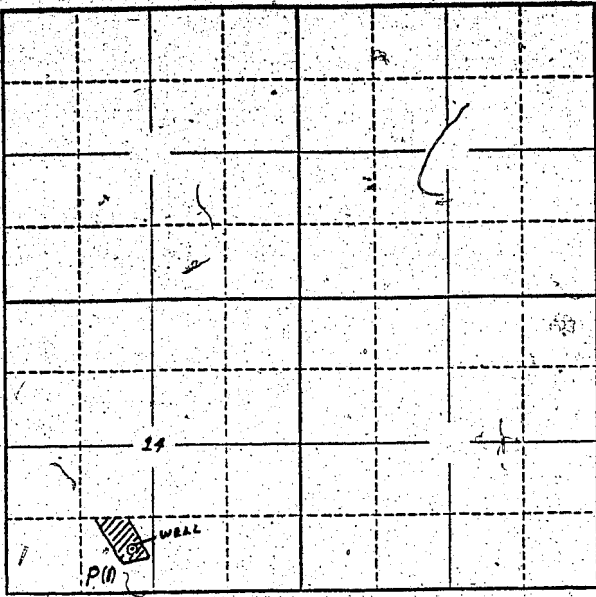

Locate well and acreage of irrigated land on plat.
Scale: 2" = 1 Mile

STATE OF OREGON }
County of Lane } ss.

I, Vincent Glover, being first duly sworn, do hereby certify that I have read the foregoing Registration Statement and that all of the items therein contained are true to the best of my knowledge and belief.

Vincent Glover
(Signature of Registrant)

Subscribed and sworn to before me this 22 day of March, 1958.

My commission expires April 20, 1960

Wm. Peterson
(Notary Public)

(SEAL)

CERTIFICATE OF REGISTRATION

STATE OF OREGON }
County of Marion } ss.

This is to certify that the foregoing Registration Statement was received in the office of the State Engineer on the 24th day of March, 1958, at 10⁰² o'clock A.M. and has been duly recorded in said office in Book No. 6 of Registration Statements on page GR 1196

Witness my hand this 17 day of September, 1958

Lewis A. Stanley
(State Engineer)

\$15.00

By _____ (Deputy)

GR-1196