

RECEIVED  
MAR 21 1958

STATE ENGINEER  
SALEM, OREGON

Registration No. GR-1243

Certificate No. GR-1201

# Registration Statement

## OF CLAIMANT OF RIGHT TO APPROPRIATE GROUND WATER

TO THE STATE ENGINEER OF OREGON:

I, Ray E Edwards and/or ARTIMESCIA Edwards Husband & wife  
of Box 97 Milton-Freewater Oregon County of Umatilla  
(Mailing address)

State of Oregon, do hereby make application for a certificate of registration as evidence of a right to appropriate ground water.

1. Source from which water is withdrawn is Pump Well  
(Flowing well, pump well, infiltration trench, or tunnel)

2. Location is: 5 miles NORTH WEST from MILTON-FREEWATER Oregon  
(Approximate distance and direction from nearest city or town)

and is more particularly described as follows:

(a) 1345 N. and 40 feet WEST of S.E. CORNER SECTION 29  
(Give distance and bearing to corner of section or other legal subdivision)

being within N.E. 1/4 S.E. 1/4 of Sec. 29, Twp. 6 N, Rge. 35 E  
(Smallest legal subdivision) (N. or S.) (E. or W.)

or (b) within limits of recorded platted property, town or city:

in Lot \_\_\_\_\_, Block \_\_\_\_\_ of \_\_\_\_\_  
(Name of plat or addition)

County of \_\_\_\_\_  
(If within city or town, give name)

3. Construction Work was begun on May 1918; was completed on MARCH 1918  
(Date) (Date)

and the ground water claimed was first used for the purposes set out below on May 1918  
(Date)

since which time the water has been used CONTINUOUSLY  
(Continuously or intermittently)

from May 1 1918 to To Date  
(Date) (Date)

4. Quantity of water claimed and used is 416 gallons per minute; 200 acre feet per year.

5. Purpose or Purposes for which water is used IRRIGATION

(Domestic, irrigation, municipal, manufacturing, industrial, etc.)

6. Description of Well: Depth 32 feet. Type Dug Well  
(Dug or drilled)

diameter 60 inches. Elevation of ground at well site 900 feet, mean sea level.  
(As near as known)

Depth to water table 10 feet.

7. Capacity of Well: 416 g.p.m. with 18 feet drawdown.

\_\_\_\_\_ g.p.m. with \_\_\_\_\_ feet drawdown.

Date of test None

If Flowing Well: Measured discharge \_\_\_\_\_ g.p.m. on \_\_\_\_\_  
(Date)

Shut-in pressure at ground surface \_\_\_\_\_ lbs. per sq. in. on \_\_\_\_\_  
(Date)

Water is controlled by \_\_\_\_\_  
(Cap, valve, etc.)

8. Casing: (Give diameter, commercial specifications and depth below ground surface of each casing size.)

60 X 60 inch diameter CONCRETE CURB ..... from ~~4~~ to 0 TO 10 feet  
..... inch diameter ..... from ..... to ..... feet  
..... inch diameter ..... from ..... to ..... feet  
..... inch diameter ..... from ..... to ..... feet

Describe and show depth of shoe, plug, adapter, liner or other details: .....

9. Perforated Casings or Screens:

..... from ..... to .....  
(Number per foot and size of perforations, or describe screen)  
..... from ..... to .....  
..... from ..... to .....  
..... from ..... to .....

10. Log of Well: (Describe each stratum or formation clearly, indicate if water bearing, and give thickness and depth as indicated.)

MATERIAL	Thickness (Feet)	Depth to Bottom (Feet)
TOP Soil	8	
Loose Gravel	<del>7</del> 7	
CONCRETE Gravel	15	

If log of well is not available, give name and address of driller. ....

11. Infiltration Trench: Covered or open .....

Dimensions: Length ..... ft. Minimum depth ..... ft. Maximum depth ..... ft.

Bottom width ..... ft. Discharge ..... g.p.m. Date of test .....

12. Tunnel: Type of lining .....

Dimensions: .....  
(Length, course, and cross sectional size)

Position of water bearing stratum with reference to portal of tunnel .....

Log of tunnel: (Preceding table for log of well may be used, if desired. Give footage from portal and character of materials, as pertinent.)

13. Pumping Equipment:

(a) Pump Centrifugal Pump 3x4 inch Capacity 416 g.p.m.  
(Make, type and size)

(b) Motor 1.0 H.P.  
(Type and horsepower)

14. Location of area irrigated or to be irrigated, or place of use if for purposes other than irrigation.

Township North or South	Range E. or W. of Williamsette Meridian	Section	Forty-acre Tract	Number Acres To Be Irrigated	Date of Reclamation
6N	35E	29	NE 1/4 SE 1/4	40	1918
6N	35E	29	W 1/2 SE 1/4 NE 1/4	10	1918
				<u>50</u>	

15. If the ground water supply is supplemental to an existing water supply, identification of any application for a permit, permit, certificate or adjudicated right to appropriate water made or held by the registrant.

None

Township 6 N Range 35 E W.M.

North

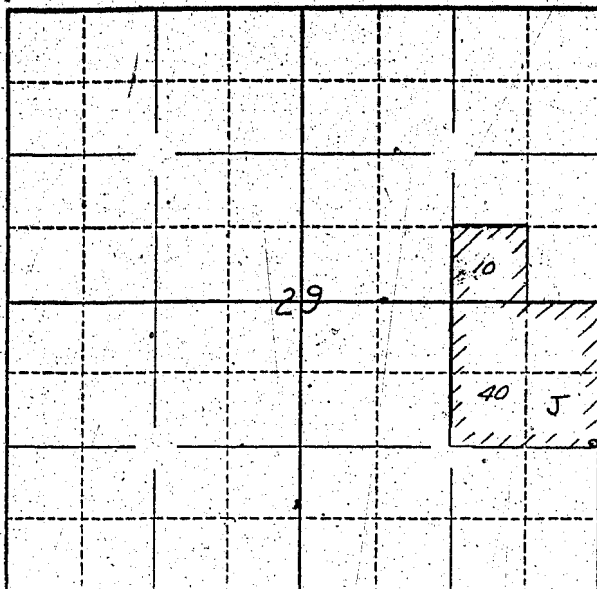

Locate well and acreage of irrigated land on plat.

Scale: 2" = 1 Mile

STATE OF OREGON

County of Umatilla

ss.

I, Ray E. Edwards, being first duly sworn, do hereby certify that I have read the foregoing Registration Statement and that all of the items therein contained are true to the best of my knowledge and belief.

Ray E. Edwards  
(Signature of Registrant)

Subscribed and sworn to before me this 20 day of March, 1958

My commission expires Sept. 8, 1960

Chas. L. ...  
(Notary Public)

(SEAL)

**CERTIFICATE OF REGISTRATION**

STATE OF OREGON

County of Marion

ss.

This is to certify that the foregoing Registration Statement was received in the office of the State Engineer on the 24<sup>th</sup> day of March, 1958, at 2:00 o'clock A.M. and has been duly recorded in said office in Book No. 6 of Registration Statements on page GR-1201

Witness my hand this 17 day of September, 1958

Lewis A. Stanley  
(State Engineer)

By

(Deputy)

GR-1201

#1800