

Registration No. GR - 1252

# Well # 1 Registration Statement

Certificate No. GR - 1208

## OF CLAIMANT OF RIGHT TO APPROPRIATE GROUND WATER

TO THE STATE ENGINEER OF OREGON:

I, LOUIS C. SCOFIELD

of Route 1, Box 148, Turner County of Marion  
(Mailing address)

State of Oregon, do hereby make application for a certificate of registration as evidence of a right to appropriate ground water.

1. Source from which water is withdrawn is Pump Well  
(Flowing well, pump well, infiltration trench, or tunnel)

2. Location is: 5 Miles Southwest of Stayton, Oregon  
(Approximate distance and direction from nearest city or town)

and is more particularly described as follows:

(a) North 3330 feet and West 882.1 to N.W. corner sec. 25 T. 9S. R. 2 W.  
(Give distance and bearing to corner of section or other legal subdivision)  
being within NW 1/4 SW 1/4 of Sec. 25 Twp. 9 S Rge. 2 W  
(Smallest legal subdivision) (N. or S.) (E. or W.)

or (b) within limits of recorded platted property, town or city:

in Lot \_\_\_\_\_, Block \_\_\_\_\_ of \_\_\_\_\_  
(Name of plat or addition)

County of \_\_\_\_\_  
(If within city or town, give name)

3. Construction Work was begun on December 1952, was completed on Dec. 1952  
(Date) (Date)

and the ground water claimed was first used for the purposes set out below on June 15, 1953  
(Date)

since which time the water has been used continuously  
(Continuously or intermittently)

from May 1 to October 1  
(Date) (Date)

4. Quantity of water claimed and used is 400 gallons per minute; 50 acre feet per year.

5. Purpose or Purposes for which water is used Irrigation

(Domestic, irrigation, municipal, manufacturing, industrial, etc.)

6. Description of Well: Depth 21 feet. Type Drilled  
(Dug or drilled)

diameter 8 inches. Elevation of ground at well site \_\_\_\_\_ feet; mean sea level.  
(As near as known)

Depth to water table 10 feet.

7. Capacity of Well: 400 g.p.m. with 30 feet drawdown.

\_\_\_\_\_ g.p.m. with \_\_\_\_\_ feet drawdown.

Date of test any time

If Flowing Well: Measured discharge \_\_\_\_\_ g.p.m. on \_\_\_\_\_  
(Date)

Shut-in pressure at ground surface \_\_\_\_\_ lbs. per sq. in. on \_\_\_\_\_  
(Date)

Water is controlled by \_\_\_\_\_  
(Cap. valve, etc.)



If log of well is not available, give name and address of driller. ....

11. Infiltration Trench: Covered or open .....  
 Dimensions: Length ..... ft. Minimum depth ..... ft. Maximum depth ..... ft.  
 Bottom width ..... ft. Discharge ..... g.p.m. Date of test .....

12. Tunnel: Type of lining .....  
 Dimensions: .....  
(Length, course, and cross sectional size)  
 Position of water bearing stratum with reference to portal of tunnel .....

Log of tunnel: (Preceding table for log of well may be used, if desired. Give footage from portal and character of materials, as pertinent.)

13. Pumping Equipment:  
 (a) Pump ..... 4 x 3 Pacific ..... Capacity 400 g.p.m.  
(Make, type and size)  
 (b) Motor ..... 15 H. P. Electric Motor ..... 3 Phase .....  
(Type and horsepower)

14. Location of area irrigated or to be irrigated, or place of use if for purposes other than irrigation.

Township North or South	Range E. or W. of Willamette Meridian	Section	Forty-acre Tract	Number Acres To Be Irrigated	Date of Reclamation
9 S.	2 W	25	NW $\frac{1}{4}$ of SW $\frac{1}{4}$	34.2	6/15/53
"	"	26	NE $\frac{1}{4}$ of SE $\frac{1}{4}$	1.25	"
				Total 35.45	

15. If the ground water supply is supplemental to an existing water supply, identification of any application for a permit, permit, certificate or adjudicated right to appropriate water made or held by the registrant.

Township 9.5 Range 2W, W.M.

North

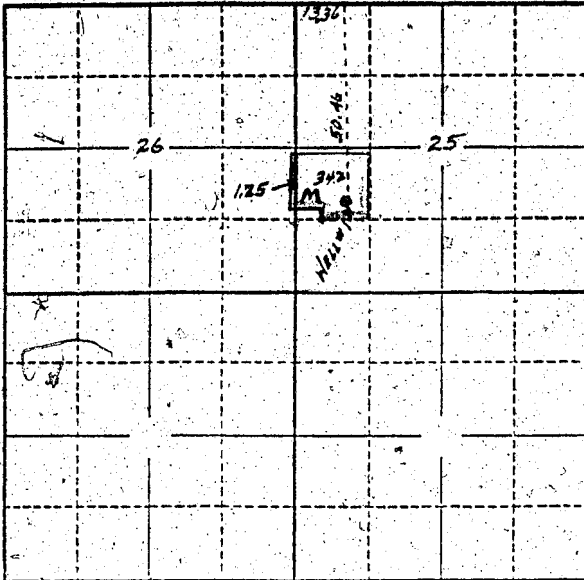

Locate well and acreage of irrigated land on plat.

Scale: 2" = 1 Mile

STATE OF OREGON

County of Marion } ss.

I, Louis Seefeld, being first duly sworn, do hereby certify that I have read the foregoing Registration Statement and that all of the items therein contained are true to the best of my knowledge and belief.

Louis Seefeld  
(Signature of Registrant)

Subscribed and sworn to before me this 25<sup>th</sup> day of March, 1958.

My commission expires Sept 9, 1960 Chas. [Signature]  
(Notary Public)

(SEAL)

**CERTIFICATE OF REGISTRATION**

STATE OF OREGON }  
County of Marion } ss.

This is to certify that the foregoing Registration Statement was received in the office of the State Engineer on the 25th day of March, 1958, at 8:00 o'clock A. M. and has been duly recorded in said office in Book No. 6 of Registration Statements on page GR 1208.

Witness my hand this 19 day of September, 1958

Lewis A. Stanley  
(State Engineer)

By \_\_\_\_\_  
(Deputy)

# 15.90

GR-1208