

RECEIVED
MAR 25 1958

STATE ENGINEER
SALEEM OREGON

Registration No. GR - 1255

Certificate No. GR - 1211

Registration Statement

OF CLAIMANT OF RIGHT TO APPROPRIATE GROUND WATER

TO THE STATE ENGINEER OF OREGON:

I, Curtis M. Snow + Blanche Snow
of Milton Freewater Pte 3 Box 330 County of Linn
(Mailing address)
State of Oregon do hereby make application for a certificate of registration as evidence of a right to appropriate ground water.

1. Source from which water is withdrawn is pump well
(Flowing well, pump well, infiltration trench, or tunnel)
2. Location is: 2 miles north of Milton Freewater
(Approximate distance and direction from nearest city or town)

and is more particularly described as follows:

(a) 25' N. 90' E. of the S 1/4 cor. Sec. 26
SW SE (Give distance and bearing to corner of section or other legal subdivision)
being within SE 1/4 of S 1/4 of Sec. 26, Twp. 6 N, Rge. 35 E
(Smallest legal subdivision) (N. or S.) (E. or W.)

or (b) within limits of recorded platted property, town or city:
in Lot _____, Block _____ of _____
(Name of plat or addition)

County of _____
(If within city or town, give name)

3. Construction Work was begun on 1910; was completed on 1910
(Date) (Date)

and the ground water claimed was first used for the purposes set out below on 1910
(Date)
since which time the water has been used continuously each irrigation season
(Continuously or intermittently)
from June to Sept
(Date) (Date)

4. Quantity of water claimed and used is 450 gallons per minute; 72 acre feet per year.

5. Purpose or Purposes for which water is used irrigation

(Domestic, irrigation, municipal, manufacturing, industrial, etc.)

6. Description of Well: Depth 8.5 feet. Type Dug 5.6 ft. Drilled 2.9 ft.
4' x 4' Dug (Dug or drilled)
diameter 8 inches. Elevation of ground at well site 9.75 feet, mean sea level.
(As near as known)
Depth to water table 1.5 feet.

7. Capacity of Well: _____ g.p.m. with _____ feet drawdown.
_____ g.p.m. with _____ feet drawdown.

Date of test never tested

If Flowing Well: Measured discharge _____ g.p.m. on _____
(Date)

Shut-in pressure at ground surface _____ lbs. per sq. in. on _____
(Date)

Water is controlled by _____
(Cap, valve, etc.)

8. Casing: (Give diameter, commercial specifications and depth below ground surface of each casing size.)

4.2' inch diameter Concrete Cuck from 0.0 to 1.4 feet
8 inch diameter steel from 5.6 to 8.5 feet
inch diameter from to feet
inch diameter from to feet

Describe and show depth of shoe, plug, adapter, liner or other details: _____

9. Perforated Casings or Screens:

(Number per foot and size of perforations, or describe screen)
from to
from to
from to
from to

10. Log of Well: (Describe each stratum or formation clearly, indicate if water bearing, and give thickness and depth as indicated.)

MATERIAL	Thickness (feet)	Depth to Bottom (feet)
<i>Not available</i>		

If log of well is not available, give name and address of driller. Bill James N. 1st St. Escalante

11. Infiltration Trench: Covered or open

Dimensions: Length ft. Minimum depth ft. Maximum depth ft.
Bottom width ft. Discharge g.p.m. Date of test

12. Tunnel: Type of lining

Dimensions:
(Length, course, and cross sectional size)

Position of water bearing stratum with reference to portal of tunnel

Log of tunnel: (Preceding table for log of well may be used, if desired. Give footage from portal and character of materials, as pertinent.)

13. Pumping Equipment:

(a) Pump La cuzzi Centrifugal 4" x 4" Capacity 450 g.p.m.
(Make, type and size)

(b) Motor 5 HP Electric motor
(Type and horsepower)

14. Location of area irrigated or to be irrigated, or place of use if for purposes other than irrigation.

Township North or South	Range E. or W. of Williams Meridian	Section	Forty-acre Tract	Number Acres To Be Irrigated	Date of Reclamation
<u>6 N</u>	<u>35</u>	<u>26</u>	<u>E 1/2 SW 1/4 SE 1/4</u>	<u>18 1/2</u>	<u>1910</u>

15. If the ground water supply is supplemental to an existing water supply, identification of any application for a permit, permit, certificate or adjudicated right to appropriate water made or held by the registrant.

Adj. West Branch of Crockett

Township 6 N. Range 35 E. W.M.
North

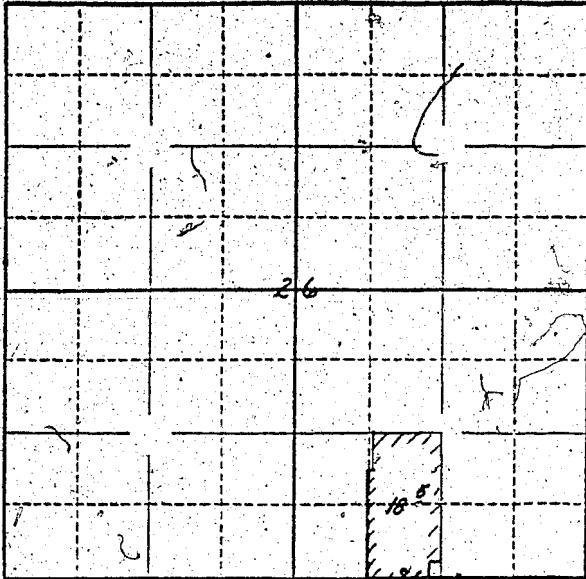

Locate well and acreage of irrigated land on plat.
Scale: 2" = 1 Mile

STATE OF OREGON

County of Umatilla

} ss.

I, Curtis M. Snow, being first duly sworn, do hereby certify that I have read the foregoing Registration Statement and that all of the items therein contained are true to the best of my knowledge and belief.

Curtis M. Snow
(Signature of Registrant)

Subscribed and sworn to before me this 20th day of March, 1958.

My commission expires Sept. 8, 1961

[Signature]
(Notary Public)

(SEAL)

CERTIFICATE OF REGISTRATION

STATE OF OREGON

County of Marion

} ss.

This is to certify that the foregoing Registration Statement was received in the office of the State Engineer on the 25th day of March, 1958, at 4:00 o'clock P. M. and has been duly recorded in said office in Book No. 6 of Registration Statements on page GR-1211

Witness my hand this 19 day of September, 1958

[Signature]
(State Engineer)

By _____ (Deputy)

GR. 1211

\$ 15.00