

Registration Statement

OF CLAIMANT OF RIGHT TO APPROPRIATE GROUND WATER

TO THE STATE ENGINEER OF OREGON:

I, Charles Orville Alexander
of Milton Fairwaters, Rt 2, Box 175, Oregon County of Umatilla
(Mailing address)

State of Oregon, do hereby make application for a certificate of registration as evidence of a right to appropriate ground water.

1. Source from which water is withdrawn is Pump well
(Flowing well, pump well, infiltration trench, or tunnel)

2. Location is: 1/2 mi. N.W. of Fairwaters
(Approximate distance and direction from nearest city or town)

and is more particularly described as follows:

(a) S.E. corner of S.W. 1/4 of section 20
(Give distance and bearing to corner of section or other legal subdivision)

being within S.E. 1/4 of S.W. 1/4 of Sec. 20, Twp. 6N, Rge. 35
(Smallest legal subdivision) (N. or S.) (E. or W.)

or (b) within limits of recorded-platted property, town or city:

in Lot _____, Block _____ of _____
(Name of plat or addition)

County of Umatilla
(If within city or town, give name)

3. Construction Work was begun on May 1924; was completed on June 1924
(Date) (Date)

and the ground water claimed was first used for the purposes set out below on June 1924
(Date)

since which time the water has been used intermittently
(Continuously or intermittently)

from June 1st to Sept 30 Hudson Bay watershed part of season
(Date) (Date)

4. Quantity of water claimed and used is 200 gallons per minute; 175 acre-feet per year.

5. Purpose or Purposes for which water is used irrigation

(Domestic, irrigation, municipal, manufacturing, industrial, etc.)

6. Description of Well: Depth 29 feet. Type dug
(Dug or drilled)

Diameter 6' X 6' inches. Elevation of ground at well site 895 feet, mean sea level.
(As near as known)

Depth to water table 15 feet.

7. Capacity of Well: 200 g.p.m. with 13 feet drawdown. in August

6 g.p.m. with 2 feet drawdown. in June

Date of test X

If Flowing Well: Measured discharge _____ g.p.m. on _____
(Date)

Shut-in pressure at ground surface _____ lbs. per sq. in. on _____
(Date)

Water is controlled by _____
(Cap, valve, etc.)

8. Casing: (Give diameter, commercial specifications and depth below ground surface of each casing size.)

6' x 6" inch diameter Concrete Curb from 0 to 14' feet
 inch diameter from to feet
 inch diameter from to feet
 inch diameter from to feet

Describe and show depth of shoe, plug, adapter, liner or other details:

9. Perforated Casings or Screens:

(Number per foot and size of perforations, or describe screen) from to
 from to
 from to
 from to

10. Log of Well: (Describe each stratum or formation clearly, indicate if water bearing, and give thickness and depth as indicated.)

MATERIAL	Thickness (Feet)	Depth to Bottom (Feet)
9ft Rock, dirt, + sand, and gravel 10ft into cement rock		

Township 6N Range 35, W.M.
North

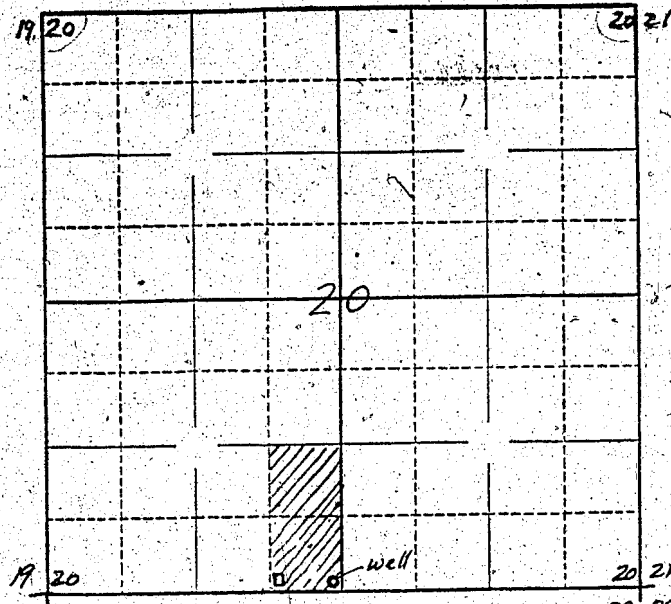

Locate well and acreage of irrigated land on plat. 29 28

Scale: 4" = 1 Mile

STATE OF OREGON

County of Umatilla } ss.

I, Charles Duille Alexander, being first duly sworn, do hereby certify that I have read the foregoing Registration Statement and that all of the items therein contained are true to the best of my knowledge and belief.

Charles Duille Alexander
(Signature of Registrant)

Subscribed and sworn to before me this 6th day of March, 1958

My commission expires Sept 30 1960 Charles H. [unclear]
(Notary Public)

(SEAL)

CERTIFICATE OF REGISTRATION

STATE OF OREGON } ss.
County of Marion

This is to certify that the foregoing Registration Statement was received in the office of the State Engineer on the 26th day of March, 1958, at 11.00 o'clock P.M. and has been duly recorded in said office in Book No. 6 of Registration Statements on page GR-1227

Witness my hand this 19 day of September, 1958

Luvis A. Stanley
(State Engineer)

By _____
(Deputy)

GR-1227

15.00