

Registration Statement

OF CLAIMANT OF RIGHT TO APPROPRIATE GROUND WATER

TO THE STATE ENGINEER OF OREGON:

I, ZEB E. MILLER
of 113 1/2 1st Ave. S.E. County of Polk
(Mailing address)

State of Oregon, do hereby make application for a certificate of registration as evidence of a right to appropriate ground water.

- 1. Source from which water is withdrawn is Pump Well #2
(Flowing well, pump well, infiltration trench, or tunnel)
- 2. Location is: 5 1/2 miles S.E. of Independence
(Approximate distance and direction from nearest city or town)

and is more particularly described as follows:

Well #2 (a) 1070 FT. S + 2800 FT. W From N.E. Corner Sec 19
(Give distance and bearing to corner of section or other legal subdivision)
being within N.E. 1/4 of NW 1/4 of Sec. 19, Twp. 25, Rge. 11 W
(Smallest legal subdivision) (N. or S.) (E. or W.)

or (b) within limits of recorded platted property, town or city:
in Lot _____, Block _____ of _____
(Name of plat or addition)
County of _____
(If within city or town, give name)

3. Construction Work was begun on 1951; was completed on 11-51
(Date) (Date)

and the ground water claimed was first used for the purposes set out below on Jan 1951
(Date)
since which time the water has been used intermittently
(Continuously or intermittently)
from 1950 to 1957
(Date) (Date)

4. Quantity of water claimed and used is 300 gallons per minute; 2.5 acre feet per year.

5. Purpose or Purposes for which water is used irrigation
(Domestic, irrigation, municipal, manufacturing, industrial, etc.)

6. Description of Well: Depth 25 feet, Type drilled
(Dug or drilled)
diameter _____ inches. Elevation of ground at well site Point Unknown feet, mean sea level.
(As near as known)
Depth to water table 12 feet.

7. Capacity of Well: 300 g.p.m. with _____ feet drawdown from ground level
_____ g.p.m. with _____ feet drawdown

Date of test 1955

If Flowing Well: Measured discharge _____ g.p.m. on _____
(Date)

Shut-in pressure at ground surface _____ lbs. per sq. in. on _____
(Date)

Water is controlled by _____
(Cap, valve, etc.)

Township 9S Range 4W, W.M.
North

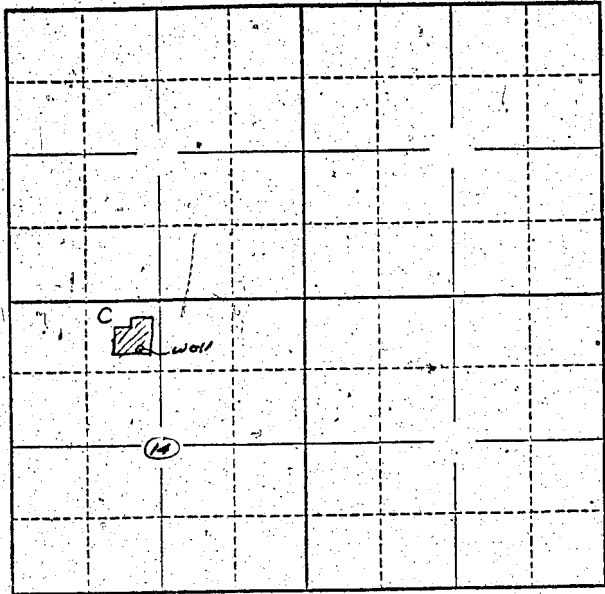

Locate well and acreage of irrigated land on plat.
Scale: 2" = 1 Mile

STATE OF OREGON }
County of Marion } ss.

I, _____, being first duly sworn, do hereby certify that I have read the foregoing Registration Statement and that all of the items therein contained are true to the best of my knowledge and belief.

Zeb E. Millhouser
(Signature of Registrant)

Subscribed and sworn to before me this 25th day of March, 1958.

My commission expires 12th June 1961 Wm. S. Bartholomew
(Notary Public)

(SEAL)

CERTIFICATE OF REGISTRATION

STATE OF OREGON }
County of Marion } ss.

This is to certify that the foregoing Registration Statement was received in the office of the State Engineer on the 27th day of March, 1958, at _____ o'clock _____ M. and has been duly recorded in said office in Book No. 6 of Registration Statements on page GR-1236.

Witness my hand this 19 day of September, 1958.

Lewis D. Stanley
(State Engineer)

By _____
(Deputy)