

15-25
STATE ENGINEER
SALEM, OREGON

Registration No. GR - 1295

Certificate No. GR - 1252

Registration Statement

OF CLAIMANT OF RIGHT TO APPROPRIATE GROUND WATER

TO THE STATE ENGINEER OF OREGON:

I, Earl Ransom

of MILTON FREEWATER P.O. Box 208 County of Umatilla
(Mailing address)

State of Oregon, do hereby make application for a certificate of registration as evidence of a right to appropriate ground water.

1. Source from which water is withdrawn is PUMP WELL
(Flowing well, pump well, infiltration trench, or tunnel)

2. Location is: 2 MILES NORTH OF MILTON FREEWATER
(Approximate distance and direction from nearest city or town)

and is more particularly described as follows:

290 feet West of SE corner of the NE⁴ of NW⁴ of Sec. 26
(Give distance and bearing to corner of section or other legal subdivision)

being within 1/4 Sec 26 NW-NE-NE-NE of Sec. 26, Twp. 21N, Rge. 30S
(Smallest legal subdivision) (N. or S.) (E. or W.)

or (b) within limits of recorded platted property, town or city:

in Lot _____, Block _____ of _____
(Name of plat or addition)

County of _____
(If within city or town, give name)

3. Construction Work was begun on prior 1922; was completed on SAME YEAR STARTED
(Date) (Date)

and the ground water claimed was first used for the purposes set out below on DATE COMPLETED
(Date)

since which time the water has been used CONTINUOUSLY
(Continuously or intermittently)

from COMPLETION to JAN 1 1958
(Date) (Date)

4. Quantity of water claimed and used is 18 gal. per day gallons per minute; _____ acre feet per year.
120 gal. in year 150 GPM.

5. Purpose or Purposes for which water is used IRRIGATION

(Domestic, irrigation, municipal, manufacturing, industrial, etc.)

6. Description of Well: Depth 110 feet. Type Dug 38 ft 72 ft casing
(Dug or drilled)

diameter 8" drilled inches. Elevation of ground at well site 900 ft feet, mean sea level.
(As near as known)

Depth to water table 20 feet. in July 1

7. Capacity of Well: 150 g.p.m. with 12 feet drawdown.

400 g.p.m. with 25 feet drawdown.

Date of test July 1

If Flowing Well: Measured discharge _____ g.p.m. on _____
(Date)

Shut-in pressure at ground surface _____ lbs. per sq. in. on _____
(Date)

Water is controlled by _____
(Cap, valve, etc.)

8. Casing: (Give diameter, commercial specifications and depth below ground surface of each casing size.)

8" inch diameter 8" casing in top of drill hole from 36 to 44 feet
8' x 8' inch diameter concrete from 0 to 10 feet
inch diameter from to feet
inch diameter from to feet

Describe and show depth of shoe, plug, adapter, liner or other details:
.....
.....

9. Perforated Casings or Screens:

..... from to
(Number per foot and size of perforations, or describe screen)
..... from to
..... from to
..... from to

10. Log of Well: (Describe each stratum or formation clearly, indicate if water bearing, and give thickness and depth as indicated.)

MATERIAL	Thickness (Feet)	Depth to Bottom (Feet)
10' dirt 4' cement gravel 4' water gravel 40' cement gravel 6' water gravel 4' cement gravel		

If log of well is not available, give name and address of driller:

11. Infiltration Trench: Covered or open

Dimensions: Length ft. Minimum depth ft. Maximum depth ft.

Bottom width ft. Discharge g.p.m. Date of test

12. Tunnel: Type of lining

Dimensions:
(Length, course, and cross sectional size)

Position of water bearing stratum with reference to portal of tunnel

Log of tunnel: (Preceding table for log of well may be used, if desired. Give footage from portal and character of materials, as pertinent.)

13. Pumping Equipment:

(a) Pump ~~1 1/2"~~ Centrifugal Pressure Capacity 150 g.p.m.
(Make, type and size)

(b) Motor 7 1/2 H.P. Electric
(Type and horsepower)

14. Location of area irrigated or to be irrigated, or place of use if for purposes other than irrigation.

Township North or South	Range E. or W. of Willamette Meridian	Section	Forty-acre Tract	Number Acres To Be Irrigated	Date of Reclamation
6N	E.W.M.	26	NE 1/4 NW 1/4 26 acres	26 acres	Before 1900
	35-				
6N	35-	26	NW 1/4 NW 1/4 5 acres	5-	
	9a			31 acres.	
Twp #9 Sec #9			less Twp #9a	} 26 acres.	
E 2 R 2 S 2 NW, NW					
E 2 R 2 S 2 NW, NW			} 5 acres.		

15. If the ground water supply is supplemental to an existing water supply, identification of any application for a permit, permit, certificate or adjudicated right to appropriate water made or held by the registrant.

Township 6N Range 35E, W.M.
North

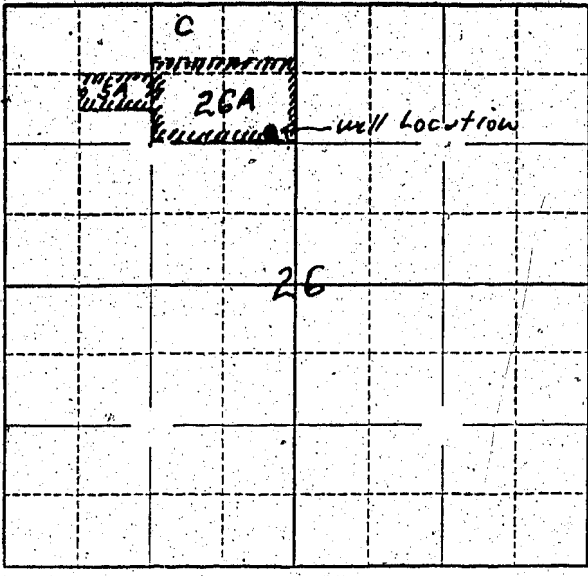

Locate well and acreage of irrigated land on plat.

Scale: $\frac{1}{4}$ " = 1 Mile

STATE OF OREGON

County of Umatilla } ss.

I, Earl Ransom, being first duly sworn, do hereby certify that I have read the foregoing Registration Statement and that all of the items therein contained are true to the best of my knowledge and belief.

Earl Ransom
(Signature of Registrant)

Subscribed and sworn to before me this 26 day of September, 1958.

My commission expires _____
(Notary Public)

(SEAL)

CERTIFICATE OF REGISTRATION

STATE OF OREGON

County of Marion } ss.

This is to certify that the foregoing Registration Statement was received in the office of the State Engineer on the 28th day of March, 1958, at 8:50 o'clock A. M. and has been duly recorded in said office in Book No. 6 of Registration Statements on page GR-1252

Witness my hand this 19 day of September

Lewis A. Stanley
(State Engineer)

By _____
(Deputy)

15.15