

RECEIVED  
APR 7 1958  
STATE ENGINEER  
SALEM OREGON

Registration No. GR - 1355

Certificate No. GR - 1310

### Registration Statement

#### OF CLAIMANT OF RIGHT TO APPROPRIATE GROUND WATER

TO THE STATE ENGINEER OF OREGON:

I, BRENTFORD MILLER, JR.  
of Route 1, Box 420, Woodburn, Oregon County of MARION  
State of OREGON, do hereby make application for a certificate of registration as evidence  
of a right to appropriate ground water.

1. Source from which water is withdrawn is PUMP WELL  
(Flowing well, pump well, infiltration trench, or tunnel)
2. Location is: 4 1/2 MILES WEST OF GERVAIS  
(Approximate distance and direction from nearest city or town)

and is more particularly described as follows:

(a) 495 ft N & 60 E from S.W. cor Sec 17  
(Give distance and bearing to corner of section or other legal subdivision)  
being within S.W. 1/4 S.W. 1/4 of Sec. 17, Twp. 5 S, Rge. 2 W  
(Smallest legal subdivision) (N. or S.) (E. or W.)

or (b) within limits of recorded platted property, town or city: \_\_\_\_\_  
in Lot \_\_\_\_\_, Block \_\_\_\_\_ of \_\_\_\_\_  
(Name of plat or addition)

County of \_\_\_\_\_  
(If within city or town, give name)

3. Construction Work was begun on OCTOBER 18-52, was completed on OCTOBER 26, 1952  
(Date) (Date)  
and the ground water claimed was first used for the purposes set out below on MAY 2, 1953  
(Date)  
since which time the water has been used INTERMITTENTLY  
(Continuously or Intermittently)  
from MAY to OCTOBER  
(Date) (Date)

4. Quantity of water claimed and used is 140 gallons per minute; 20 acre  
feet per year.

5. Purpose or Purposes for which water is used IRRIGATION

6. Description of Well: Depth 61 feet. Type DRILLED  
(Dug or drilled)  
diameter 12 inches. Elevation of ground at well site 186 feet, mean sea level.  
(As near as known)  
Depth to water table 13 feet.

7. Capacity of Well: 190 g.p.m. with 31 feet drawdown.  
\_\_\_\_\_ g.p.m. with \_\_\_\_\_ feet drawdown.

Date of test OCTOBER 24, 1952

If Flowing Well: Measured discharge \_\_\_\_\_ g.p.m. on \_\_\_\_\_  
(Date)

Shut-in pressure at ground surface \_\_\_\_\_ lbs. per sq. in. on \_\_\_\_\_  
(Date)

Water is controlled by \_\_\_\_\_  
(Cap, valve, etc.)

8. **Casing:** (Give diameter, commercial specifications and depth below ground surface of each casing size.)

12 inch diameter CONCRETE TILE from 0 to 60 feet  
inch diameter from to feet  
inch diameter from to feet  
inch diameter from to feet

Describe and show depth of shoe, plug, adapter, liner or other details:

9. **Perforated Casings or Screens:**

GRAVEL PACK from 0 to 60  
(Number per foot and size of perforations, or describe screen)  
from to  
from to  
from to

10. **Log of Well:** (Describe each stratum or formation clearly, indicate if water bearing, and give thickness and depth as indicated.)

MATERIAL	Thickness (Feet)	Depth to Bottom (Feet)

If log of well is not available, give name and address of driller. PERKINS WELL  
DRILLERS, SALEM, OREGON

11. Infiltration Trench: Covered or open \_\_\_\_\_  
 Dimensions: Length \_\_\_\_\_ ft. Minimum depth \_\_\_\_\_ ft. Maximum depth \_\_\_\_\_ ft.  
 Bottom width \_\_\_\_\_ ft. Discharge \_\_\_\_\_ g.p.m. Date of test \_\_\_\_\_

12. Tunnel: Type of lining \_\_\_\_\_  
 Dimensions: \_\_\_\_\_  
(Length, course, and cross sectional size)  
 Position of water bearing stratum with reference to portal of tunnel \_\_\_\_\_

\* Log of tunnel: (Preceding table for log of well may be used, if desired. Give footage from portal and character of materials, as pertinent.)

13. Pumping Equipment:  
 (a) Pump JACUSSI TURBINE / Capacity 140 g.p.m.  
(Make, type and size) <sup>4" DISCHARGE</sup>  
 (b) Motor 5 HORSE SINGLE PHASE  
(Type and horsepower)

14. Location of area irrigated or to be irrigated, or place of use if for purposes other than irrigation.

Township North or South	Range E. or W. of Willamette Meridian	Section	Forty-acre Tract	Number Acres To Be Irrigated	Date of Reclamation
5 S	2 W	17	S.W. 1/4 S.W. 1/4	19.8	1953

15. If the ground water supply is supplemental to an existing water supply, identification of any application for a permit, permit, certificate or adjudicated right to appropriate water made or held by the registrant.

Township 55 Range 2W, W.M.  
North

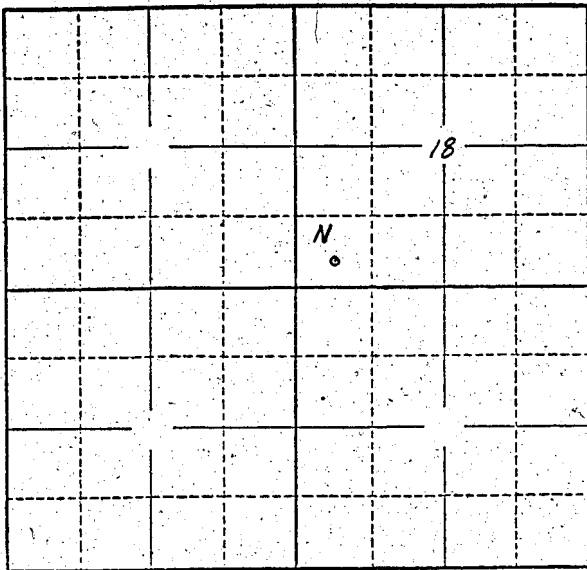

Locate well and acreage of irrigated land on plat.  
Scale: 2" = 1 Mile

STATE OF OREGON

County of Marion } ss.

I, Brentford Miller Jr., being first duly sworn, do hereby certify that I have read the foregoing Registration Statement and that all of the items therein contained are true to the best of my knowledge and belief.

Brentford Miller Jr.  
(Signature of Registrant)

Subscribed and sworn to before me this 20<sup>th</sup> day of FEBRUARY, 1958.

My commission expires Sept 8, 1960 Chas. T. Miller  
(Notary Public)

(SEAL)

**CERTIFICATE OF REGISTRATION**

STATE OF OREGON

County of Marion } ss.

This is to certify that the foregoing Registration Statement was received in the office of the State Engineer on the 7<sup>th</sup> day of April, 1958, at 5:00 o'clock A.M. and has been duly recorded in said office in Book No. 6 of Registration Statements on page GR-1310

Witness my hand this 20<sup>th</sup> day of October, 1958.

Lewis A. Stanley  
(State Engineer)

By \_\_\_\_\_  
(Deputy)