

Registration Statement

OF CLAIMANT OF RIGHT TO APPROPRIATE GROUND WATER

TO THE STATE ENGINEER OF OREGON:

I, JAMES L. GOSLER
of 1200 Weaver Lane County of Lane
(Mailing address)

State of Oregon, do hereby make application for a certificate of registration as evidence of a right to appropriate ground water.

1. Source from which water is withdrawn is Pump Well #2
(Flowing well, pump well, infiltration trench, or tunnel)
2. Location is: 7 miles E. of Springfield
(Approximate distance and direction from nearest city or town)

and is more particularly described as follows:

(a) 275' N. & 175' E. of SW Cor. Sec. 26
(Give distance and bearing to corner of section or other legal subdivision)
being within SW/SE of Sec. 26, Twp. 17S, Rge. 2W
(Smallest legal subdivision) (N. or S.) (E. or W.)
or (b) within limits of recorded platted property, town or city:
in Lot _____, Block _____ of _____
(Name of plat or addition)

County of _____
(If within city or town, give name)

3. Construction Work was begun on May 1952; was completed on June 1952
(Date) (Date)
and the ground water claimed was first used for the purposes set out below on June 1952
(Date)
since which time the water has been used continuously during summer
(Continuously or intermittently)
from June to Oct
(Date) (Date)

4. Quantity of water claimed and used is 450 gallons per minute; 70.0 acre feet per year.

5. Purpose or Purposes for which water is used irrigation of farm
(Domestic, irrigation, municipal, manufacturing, industrial, etc.)

6. Description of Well: Depth 21 feet. Type drilled
(Dug or drilled)
diameter 3-3/4 inches. Elevation of ground at well site 518 feet, mean sea level.
(As near as known)
Depth to water table 15' feet.

7. Capacity of Well: _____ g.p.m. with _____ feet drawdown.
_____ g.p.m. with _____ feet drawdown.

Date of test Not tested
If Flowing Well: Measured discharge _____ g.p.m. on _____ (Date)
Shut-in pressure at ground surface _____ lbs. per sq. in. on _____ (Date)
Water is controlled by _____
(Cap, valve, etc.)

Township 17.5 Range 24 W.M.
North

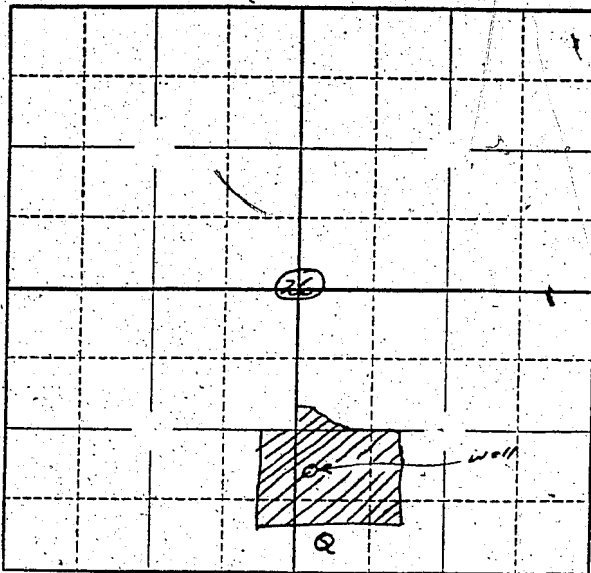

Locate well and acreage of irrigated land on plat.
Scale: 2" = 1 Mile

STATE OF OREGON

County of Marion } ss.

I, _____, being first duly sworn, do hereby certify that I have read the foregoing Registration Statement and that all of the items therein contained are true to the best of my knowledge and belief.

James G. Gessler
(Signature of Registrant)

Subscribed and sworn to before me this 1st day of April, 1958

My commission expires 12th June 1961 Wm. S. Bartholomew
(Notary Public)

(SEAL)

CERTIFICATE OF REGISTRATION

STATE OF OREGON

County of Marion } ss.

This is to certify that the foregoing Registration Statement was received in the office of the State Engineer on the 7th day of April, 1958, at 10:30 o'clock A.M. and has been duly recorded in said office in Book No. 6 of Registration Statements on page GR-1327

Witness my hand this 20th day of October, 1958

Luoro A. Stanley
(State Engineer)

By _____
(Deputy)