

Registration No. GR. - 1371

Certificate No. GR. - 1329

# Registration Statement

## OF CLAIMANT OF RIGHT TO APPROPRIATE GROUND WATER

TO THE STATE ENGINEER OF OREGON:

I, Bernard N. Miller

of 378 Montgomery St. Woodburn County of Marion

State of Oregon do hereby make application for a certificate of registration as evidence of a right to appropriate ground water.

1. Source from which water is withdrawn is Pump Well #1  
(Flowing well, pump well, infiltration trench, or tunnel)

2. Location is: 3 1/2 miles South East of Woodburn  
(Approximate distance and direction from nearest city or town)

and is more particularly described as follows:

(a) 900 feet west & 1800 feet south from NE corner Section 30  
(Give distance and bearing to corner of section or other legal subdivision)

being within SE 1/4 of NE 1/4 of Sec. 30, Twp. 5 S, Rge. 1 W  
(Smallest legal subdivision) (S. or W.)

or (b) within limits of recorded platted property, town, or city:

in Lot \_\_\_\_\_, Block \_\_\_\_\_ of \_\_\_\_\_  
(Name of plat or addition)

County of \_\_\_\_\_  
(If within city or town, give name)

3. Construction Work was begun on 1948; was completed on 1948  
(Date) (Date)

and the ground water claimed was first used for the purposes set out below on 1948  
(Date)

since which time the water has been used intermittently during season  
(Continuously or intermittently)

from May to Sept. 1957  
(Date) (Date)

4. Quantity of water claimed and used is 125 gallons per minute; \_\_\_\_\_ acre feet per year.

5. Purpose or Purposes for which water is used Irrigation

(Domestic, irrigation, municipal, manufacturing, industrial, etc.)

6. Description of Well: Depth 90 feet. Type Drilled  
(Dug or drilled)

diameter 8 inches. Elevation of ground at well site \_\_\_\_\_ feet, mean sea level.

Depth to water table 23 feet.  
(As near as known)

7. Capacity of Well: 125 g.p.m. with 65 feet drawdown.  
\_\_\_\_\_ g.p.m. with \_\_\_\_\_ feet drawdown.

Date of test \_\_\_\_\_

If Flowing Well: Measured discharge \_\_\_\_\_ g.p.m. on \_\_\_\_\_  
(Date)

Shut-in pressure at ground surface \_\_\_\_\_ lbs. per sq. in. on \_\_\_\_\_  
(Date)

Water is controlled by \_\_\_\_\_  
(Cap, valve, etc.)



If log of well is not available, give name and address of driller. Ballwater - Myron

11. Infiltration Trench: Covered or open .....

Dimensions: Length ..... ft. Minimum depth ..... ft. Maximum depth ..... ft.  
 Bottom width ..... ft. Discharge ..... g.p.m. Date of test .....

12. Tunnel: Type of lining .....

Dimensions: .....  
(Length, course, and cross sectional size)  
 Position of water bearing stratum with reference to portal of tunnel .....

Log of tunnel: (Preceding table for log of well may be used, if desired. Give footage from portal and character of materials, as pertinent.)

13. Pumping Equipment:

(a) Pump Turbine - set at 80 ft. Capacity 1.50 g.p.m.  
(Make, type and size)  
 (b) Motor 10 H.P. Electric  
(Type and horsepower)

14. Location of area irrigated or to be irrigated, or place of use if for purposes other than irrigation.

Township North or South	Range E. or W. of Willamette Meridian	Section	Forty-acre Tract	Number Acres To Be Irrigated	Date of Reclamation
<u>T5S</u>	<u>R1W</u>	<u>30</u>	<u>SW 1/4 of NE 1/4</u>	<u>6.8</u>	<u>1948</u>
<u>"</u>	<u>"</u>	<u>30</u>	<u>SE 1/4 of NE 1/4</u>	<u>21.0</u>	<u>"</u>
<u>"</u>	<u>"</u>	<u>"</u>	<u>NW 1/4 of SE 1/4</u>	<u>5.8</u>	<u>"</u>
<u>"</u>	<u>"</u>	<u>"</u>	<u>NE 1/4 of SE 1/4</u>	<u>10.4</u>	<u>"</u>
				<u>44.0 Ac</u>	<u>"</u>

15. If the ground water supply is supplemental to an existing water supply, identification of any application for a permit, permit, certificate or adjudicated right to appropriate water made or held by the registrant.

Township 5S Range 1W, W.M.  
North

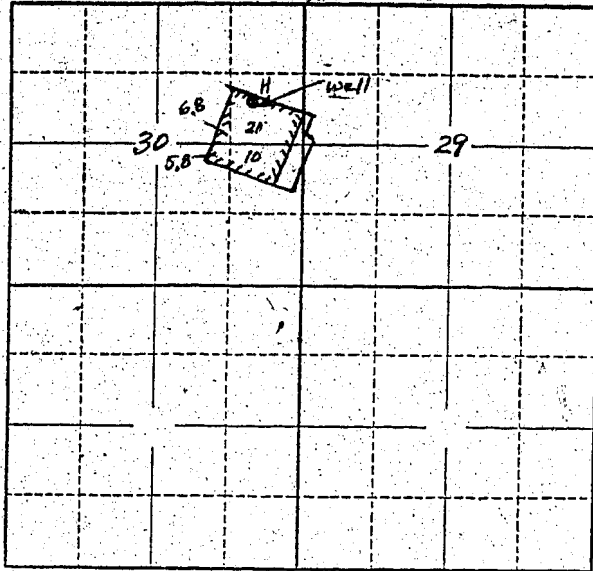

Locate well and acreage of irrigated land on plat.  
Scale: 2" = 1 Mile

STATE OF OREGON

County of Marion } ss.

I, \_\_\_\_\_, being first duly sworn, do hereby certify that I have read the foregoing Registration Statement and that all of the items therein contained are true to the best of my knowledge and belief.

Barnard J. Smith  
(Signature of Registrant)

Subscribed and sworn to before me this 7th day of April, 19 58

My commission expires 12th June 1961 Wm. S. Bartholomew  
(Notary Public)

(SEAL)

### CERTIFICATE OF REGISTRATION

STATE OF OREGON }  
County of Marion } ss.

This is to certify that the foregoing Registration Statement was received in the office of the State Engineer on the 7th day of April, 19 58, at 11:20 o'clock A. M. and has been duly recorded in said office in Book No. 6 of Registration Statements on page GR-1329

Witness my hand this 20th day of October, 19 58

Lewis A. Stanley  
(State Engineer)

By \_\_\_\_\_  
(Deputy)

GR - 1329