

RECEIVED
APR 8 1958
STATE ENGINEER
SALEM, OREGON

Registration No. GR-1376

Certificate No. GR-1333

Registration Statement

OF CLAIMANT OF RIGHT TO APPROPRIATE GROUND WATER

TO THE STATE ENGINEER OF OREGON:

I, William A. & Zelma L. Goracke

of Route 3, Junction City County of Benton
(Mailing address)

State of Oregon, do hereby make application for a certificate of registration as evidence of a right to appropriate ground water.

1. Source from which water is withdrawn is pump well
(Flowing well, pump well, infiltration trench, or tunnel)

2. Location is: 4 miles NE of Monroe
(Approximate distance and direction from nearest city or town)

and is more particularly described as follows:

(a) 2257' N 48° 15' E to ^{N 1/4} corner section 23
(Give distance and bearing to corner of section or other legal subdivision)

being within SW 1/4 NW 1/4 of Sec. 23, Twp. 11S, Rge. 5W, W.M.
(Smallest legal subdivision) (N. or S.) (E. or W.)

or (b) within limits of recorded platted property, town or city:

in Lot _____, Block _____ of _____
(Name of plat or addition)

County of _____
(If within city or town, give name)

3. Construction Work was begun on 1952; was completed on 1952
(Date) (Date)

and the ground water claimed was first used for the purposes set out below on 1952
(Date)

since which time the water has been used continuously
(Continuously or intermittently)

from 1952 to 1957
(Date) (Date)

4. Quantity of water claimed and used is 125 when pumping gallons per minute; 38 acre feet per year.

5. Purpose or Purposes for which water is used irrigation

(Domestic, irrigation, municipal, manufacturing, industrial, etc.)

6. Description of Well: Depth 21 feet. Type driven
(Dug or drilled)

diameter 4 inches. Elevation of ground at well site 210 feet, mean sea level.
(As near as known)

Depth to water table 9 feet.

7. Capacity of Well: 200 g.p.m. with 4 feet drawdown.

_____ g.p.m. with _____ feet drawdown.

Date of test 1952

If Flowing Well: Measured discharge _____ g.p.m. on _____
(Date)

Shut-in pressure at ground surface _____ lbs. per sq. in. on _____
(Date)

Water is controlled by _____
(Cap, valve, etc.)

8. Casing: (Give diameter, commercial specifications and depth below ground surface of each casing size)

4. inch diameter steel from surface to 21 feet
inch diameter from to feet
inch diameter from to feet
inch diameter from to feet

Describe and show depth of shoe, plug, adapter, liner or other details:

9. Perforated Casings or Screens:

slotted from 10' to 21'
(Number per foot and size of perforations, or describe screen)

from to

from to

from to

10. Log of Well: (Describe each stratum or formation clearly, indicate if water bearing, and give thickness and depth as indicated.)

MATERIAL	Thickness (Feet)	Depth to Bottom (Feet)
unknown		

If log of well is not available, give name and address of driller. unknown

11. Infiltration Trench: Covered or open _____

Dimensions: Length _____ ft. Minimum depth _____ ft. Maximum depth _____ ft.

Bottom width _____ ft. Discharge _____ g.p.m. Date of test _____

12. Tunnel: Type of lining _____

Dimensions: _____
(Length, course, and cross sectional size)

Position of water bearing stratum with reference to portal of tunnel _____

Log of tunnel: (Preceding table for log of well may be used, if desired. Give footage from portal and character of materials, as pertinent.)

13. Pumping Equipment:

(a) Pump 2 x 1 1/2 centrifugal Capacity 125 g.p.m.
(Make, type and size)

(b) Motor 5 hp single phase
(Type and horsepower)

14. Location of area irrigated or to be irrigated, or place of use if for purposes other than irrigation.

Township North or South	Range E. or W. of Williamsite Meridian	Section	Forty-acre Tract	Number Acres To Be Irrigated	Date of Reclamation
14S	5W	23	NW 1/4 NW 1/4	7.0	1952
14S	5W	23	SW 1/4 NW 1/4	8.0	1952
Total				15.0	

15. If the ground water supply is supplemental to an existing water supply, identification of any application for a permit, permit, certificate or adjudicated right to appropriate water made or held by the registrant.

Township 14 S Range 5 W, W.M.
North

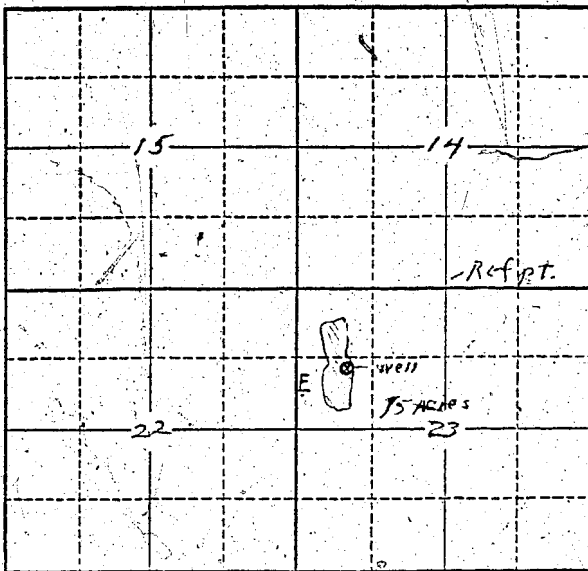

Locate well and acreage of irrigated land on plat.
Scale: 2" = 1 Mile

STATE OF OREGON

County of Benton } ss.

I, William A. Garada, being first duly sworn, do hereby certify that I have read the foregoing Registration Statement and that all of the items therein contained are true to the best of my knowledge and belief.

Wm. A. Garada
(Signature of Registrant)

Subscribed and sworn to before me this 29th day of March, 1958

My commission expires Dec 11, 1959

H. Turner
(Notary Public)

(SEAL)

CERTIFICATE OF REGISTRATION

STATE OF OREGON

County of Marion } ss.

This is to certify that the foregoing Registration Statement was received in the office of the State Engineer on the 2th day of April, 1958, at 8:00 o'clock A. M. and has been duly recorded in said office in Book No. 6 of Registration Statements on page GR-1333

Witness my hand this 20th day of October, 1958

Lewis A. Stanley
(State Engineer)

By _____ (Deputy)