

RECEIVED
APR 10 1958

STATE ENGINEER
SALEM, OREGON

Registration No. GR 1390

Certificate No. GR 1347

Registration Statement

OF CLAIMANT OF RIGHT TO APPROPRIATE GROUND WATER

TO THE STATE ENGINEER OF OREGON:

I, Roy C Sanborn
of R# - 1 Box 191 Eugene County of Lane
(Mailing address)

State of ore, do hereby make application for a certificate of registration as evidence of a right to appropriate ground water.

- Source from which water is withdrawn is Pump Well #1
(Flowing well, pump well, infiltration trench, or tunnel)
- Location is: 6 miles North Eugene
465' N. & 1100' W. from S.E. Cor. Sec. 32
(Approximate distance and direction from nearest city or town)

and is more particularly described as follows:

(a) 465' N. & 1100' W. from S.E. Cor. Sec. 32
(Give distance and bearing to corner of section or other legal subdivision)
being within SE/SE of Sec. 32, Twp. 16-S, Rge. 4-W
(Smallest legal subdivision) (N. or S.) (E. or W.)

or (b) within limits of recorded platted property, town or city:

in Lot _____, Block _____ of _____
(Name of plat or addition)
County of _____
(If within city or town, give name)

3. Construction Work was begun on 6-4-51; was completed on 6-7-51
(Date) (Date)

and the ground water claimed was first used for the purposes set out below on 6-15-51
(Date)
since which time the water has been used intermittently
(Continuously or intermittently)
from 7-10-51 to present
(Date) (Date)

4. Quantity of water claimed and used is 210 gallons per minute; 50.0 acre feet per year.

5. Purpose or Purposes for which water is used irrigation
(Domestic, irrigation, municipal, manufacturing, industrial, etc.)

6. Description of Well: Depth 18 feet. Type Dug
(Dug or drilled)
diameter 48 inches. Elevation of ground at well site 546 feet, mean sea level.
(As near as known)
Depth to water table 6 feet.

7. Capacity of Well: _____ g.p.m. with _____ feet drawdown.
_____ g.p.m. with _____ feet drawdown.

Date of test Not tested

If Flowing Well: Measured discharge _____ g.p.m. on _____
(Date)

Shut-in pressure at ground surface _____ lbs. per sq. in. on _____
(Date)

Water is controlled by _____
(Cap, valve, etc.)

If log of well is not available, give name and address of driller.

11. Infiltration Trench: Covered or open

Dimensions: Length ft. Minimum depth ft. Maximum depth ft.

Bottom width ft. Discharge g.p.m. Date of test

12. Tunnel: Type of lining

Dimensions:
(Length, course, and cross sectional size)

Position of water bearing stratum with reference to portal of tunnel

Log of tunnel: (Preceding table for log of well may be used, if desired. Give footage from portal and character of materials, as pertinent.)

13. Pumping Equipment: *Berkely 1 1/2" Centrifugal*
(a) Pump *1 1/2" Centrifugal* Capacity *250* g.p.m.
(b) Motor *Century 3 phase 7 1/2 H.P. electric*
(Make, type and size) (Type and horsepower)

14. Location of area irrigated or to be irrigated, or place of use if for purposes other than irrigation.

Township North or South	Range E. or W. of Willamette Meridian	Section	Forty-acre Tract	Number Acres To Be Irrigated	Date of Reclamation
16-5	4-W	32	S.E. 1/4 of S.E. 1/4	7.0	1951
"	"	"	S.W. 1/4 of S.E. 1/4	13.0	"
				20.0	

15. If the ground water supply is supplemental to an existing water supply, identification of any application for a permit, permit, certificate or adjudicated right to appropriate water made or held by the registrant.

Township 16 S Range 4 W, W.M.
North

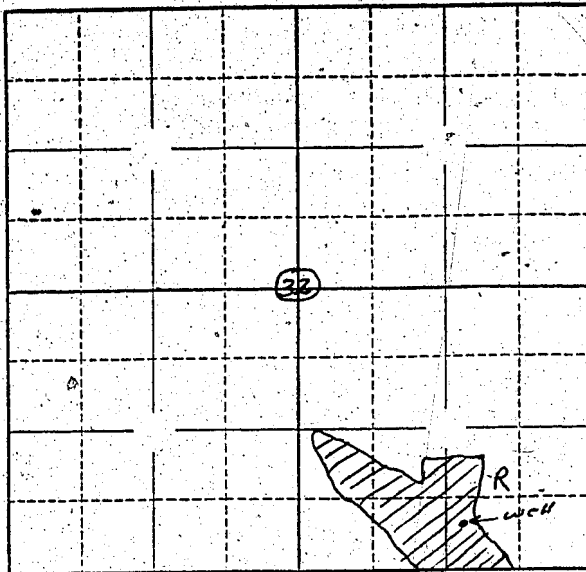

Locate well and acreage of irrigated land on plat.
Scale: 2" = 1 Mile

STATE OF OREGON

County of Marion

ss.

I, Ray C. Searborn, being first duly sworn, do hereby certify that I have read the foregoing Registration Statement and that all of the items therein contained are true to the best of my knowledge and belief.

Ray C. Searborn
(Signature of Registrant)

Subscribed and sworn to before me this 1st day of April, 19 58.

My commission expires 12th June 1961

Wm. S. Bartholomew
(Notary Public)

(SEAL)

CERTIFICATE OF REGISTRATION

STATE OF OREGON

County of Marion

ss.

This is to certify that the foregoing Registration Statement was received in the office of the State Engineer on the 10th day of April, 19 58, at 8:00 o'clock A. M. and has been duly recorded in said office in Book No. 7 of Registration Statements on page GR-1317

Witness my hand this 20th day of October, 19 58

Levin A. Stanley
(State Engineer)

By

(Deputy)

GR - 1317