

RECEIVED
WELL #156

STATE ENGINEER
SALEM, OREGON

Registration No. GR. 1393

Certificate No. GR. 1563

Registration Statement

OF CLAIMANT OF RIGHT TO APPROPRIATE GROUND WATER

TO THE STATE ENGINEER OF OREGON:

I, AARON M. FRANK

of Garden Home, Oregon County of Washington
(Mailing address)

State of Oregon, do hereby make application for a certificate of registration as evidence of a right to appropriate ground water.

1. Source from which water is withdrawn is WEST pump well #1
(Flowing well, pump well, infiltration trench, or tunnel)

2. Location is: 1/2 mile north Garden Home (school)
(Approximate distance and direction from nearest city or town)

and is more particularly described as follows:

(a) 250' south 2070' n. to 1/4 Sec corner on West Line of Sec. 24, T1S, R1W, WM.
(Give distance and bearing to corner of section or other legal subdivision)
SE 1/4 of NW 1/4
being within Garden Home of Sec. 24, Twp. T-1S, Rge. 1W
(Smallest legal subdivision) (N. or S.) (E. or W.)

or (b) within limits of recorded platted property, town or city:

in Lot _____, Block _____ of _____
(Name of plat or addition)

County of Washington
(If within city or town, give name)

3. Construction Work was begun on April 1927; was completed on June 1927
(Date) (Date)

and the ground water claimed was first used for the purposes set out below on June 1927
(Date)

since which time the water has been used continuously
(Continuously or intermittently)

from June 1927 to April 1958
(Date) (Date)

4. Quantity of water claimed and used is 160 gallons per minute; 47 acre feet per year.

5. Purpose or Purposes for which water is used irrigation

(Domestic, irrigation, municipal, manufacturing, industrial, etc.)

6. Description of Well: Depth 521 feet. Type Drilled
(Dug or drilled)

diameter 8 inches. Elevation of ground at well site 270 feet, mean sea level.
(As near as known)

Depth to water table 48 feet.

7. Capacity of Well: 160 g.p.m. with 3' feet drawdown.

380 g.p.m. with 5' feet drawdown.

Date of test July 1957

If Flowing Well: Measured discharge _____ g.p.m. on _____
(Date)

Shut-in pressure at ground surface _____ lbs. per sq. in. on _____
(Date)

Water is controlled by _____
(Cap, valve, etc.)

Township 1-5 Range 1-W, W.M.
North

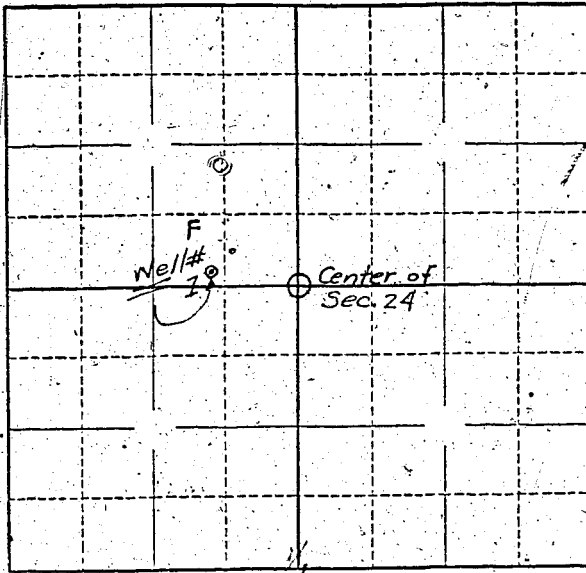

Locate well and acreage of irrigated land on plat.
Scale: 2" = 1 Mile

STATE OF OREGON }
County of Multnomah } ss.

I, John W. Frank, being first duly sworn, do hereby certify that I have read the foregoing Registration Statement and that all of the items therein contained are true to the best of my knowledge and belief.

John W. Frank
(Signature of Registrant)

Subscribed and sworn to before me this 7 day of April, 1958

My commission expires April 27, 1959
[Signature]
(Notary Public)

(SEAL)

CERTIFICATE OF REGISTRATION

STATE OF OREGON }
County of Marion } ss.

This is to certify that the foregoing Registration Statement was received in the office of the State Engineer on the 2th day of April, 1958, at 1:00 o'clock P. M. and has been duly recorded in said office in Book No. 7 of Registration Statements on page GR-1563

Witness my hand this 1st day of December, 1958

[Signature]
(State Engineer)

By _____ (Deputy)

\$15.00