

Well by barn

RECEIVED
APR 11 1958

STATE ENGINEER
SALEM, OREGON

Registration No. GR - 1399

Certificate No. GR - 1355

Registration Statement

OF CLAIMANT OF RIGHT TO APPROPRIATE GROUND WATER

TO THE STATE ENGINEER OF OREGON:

I, Isom Cox
of Rt. #1 Harrisburg County of Lane
(Mailing address)

State of Oregon, do hereby make application for a certificate of registration as evidence of a right to appropriate ground water.

1. Source from which water is withdrawn is pump well #3
(Flowing well, pump well, infiltration trench, or tunnel)
2. Location is: 5 3/4 mile N.W. Coburg
(Approximate distance and direction from nearest city or town)

and is more particularly described as follows:

(a) 310' s & 465' w of center sec. 11
(Give distance and bearing to corner of section or other legal subdivision)
being within n.e. 1 s.w. 1 of Sec. 11, Twp. 16s, Rge. 4w
(Smallest legal subdivision) (N. or S.) (E. or W.)

or (b) within limits of recorded platted property, town or city:

in Lot _____, Block _____ of _____
(Name of plat or addition)
County of Lane
(If within city or town, give name)

3. Construction Work was begun on May 1951; was completed on same
(Date) (Date)

and the ground water claimed was first used for the purposes set out below on same
(Date)
since which time the water has been used continuously
(Continuously or intermittently)

from May to October
(Date) (Date)

4. Quantity of water claimed and used is 200 gallons per minute; 22.25 acre feet per year.

5. Purpose or Purposes for which water is used irrigation
(Domestic, irrigation, municipal, manufacturing, industrial, etc.)

6. Description of Wells: Depth 20 feet. Type DRIVEN
(Dug or drilled)
diameter 4 inches. Elevation of ground at well site 340 feet, mean sea level.
(As near as known)
Depth to water table 12 feet.

7. Capacity of Well: _____ g.p.m. with _____ feet drawdown.
_____ g.p.m. with _____ feet drawdown.

Date of test _____

If Flowing Well: Measured discharge _____ g.p.m. on _____
(Date)

Shut-in pressure at ground surface _____ lbs. per sq. in. on _____
(Date)

Water is controlled by _____
(Cap, valve, etc.)

Township 16-5 Range 4-W, W.M.

North

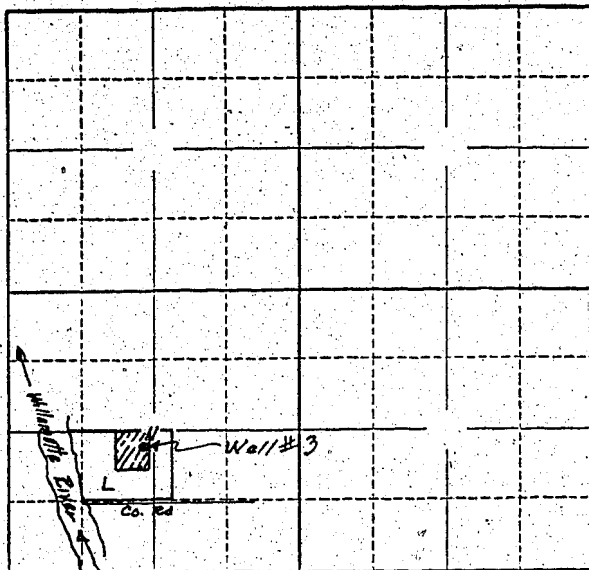

Locate well and acreage of irrigated land on plat.

Scale: 2" = 1 Mile.

STATE OF OREGON

County of Lane

} ss.

I, Isom Cox, being first duly sworn, do hereby certify that I have read the foregoing Registration Statement and that all of the items therein contained are true to the best of my knowledge and belief.

Isom Cox

(Signature of Registrant)

Subscribed and sworn to before me this 10th day of April, 1958

My commission expires Jan. 12, 1960

Phyllis Young

(Notary Public)

(SEAL)

CERTIFICATE OF REGISTRATION

STATE OF OREGON

County of Marion

} ss.

This is to certify that the foregoing Registration Statement was received in the office of the State Engineer on the 11th day of April, 1958, at 8:00 o'clock A. M. and has been duly recorded in said office in Book No. 7 of Registration Statements on page GR-1355

Witness my hand this 20th day of October, 1958.

Lewis A. Stanley

(State Engineer)

By

(Deputy)

GR - 1355

\$ 15.00