

# Registration Statement

## OF CLAIMANT OF RIGHT TO APPROPRIATE GROUND WATER

TO THE STATE ENGINEER OF OREGON:

I, Elyde Rungel 3225 Chemawa Rd  
of 3225 Chemawa Rd, Salem County of Marion  
(Mailing address)

State of Ore do hereby make application for a certificate of registration as evidence of a right to appropriate ground water.

- 1. Source from which water is withdrawn is XX Pump Well #1  
(Flowing well, pump well, infiltration trench, or tunnel)
- 2. Location is: Salem  
(Approximate distance and direction from nearest city or town)

and is more particularly described as follows:

(a) 1500 feet east & 400 feet south from W/4 corner  
(Give distance and bearing to corner of section or other legal subdivision)

being within NE 1/4 of Sec. 31 of Sec. 31; Twp. 6 S Rge. 2 W  
(Smallest legal subdivision) (N or S) (E or W)

or (b) within limits of recorded platted property, town or city:

in Lot \_\_\_\_\_ Block \_\_\_\_\_ of \_\_\_\_\_  
(Name of plat or addition)

County of Marion  
(If within city or town, give name)

3. Construction Work was begun on 1949; was completed on 1949  
(Date) (Date)

and the ground water claimed was first used for the purposes set out below on 1949  
(Date)

since which time the water has been used no X intermittently  
(Continuously or intermittently)

from 1949 to 57  
(Date) (Date)

4. Quantity of water claimed and used is 360 gallons per minute; \_\_\_\_\_ acre feet per year.

5. Purpose or Purposes for which water is used Irrigation & for distilling  
(Domestic, irrigation, municipal, manufacturing, industrial, etc.)

6. Description of Well: Depth 120 feet. Type \_\_\_\_\_  
(Dug or drilled)

diameter 12 inches. Elevation of ground at well site \_\_\_\_\_ feet, mean sea level.  
(As near as known)

Depth to water table 11 feet.

7. Capacity of Well: 360 g.p.m. with 27 feet drawdown.  
\_\_\_\_\_ g.p.m. with \_\_\_\_\_ feet drawdown.

Date of test \_\_\_\_\_

If Flowing Well: Measured discharge \_\_\_\_\_ g.p.m. on \_\_\_\_\_  
(Date)

Shut-in pressure at ground surface \_\_\_\_\_ lbs. per sq. in. on \_\_\_\_\_  
(Date)

Water is controlled by \_\_\_\_\_  
(Cap, valve, etc.)





Township 6S Range 2W, W.M.  
North

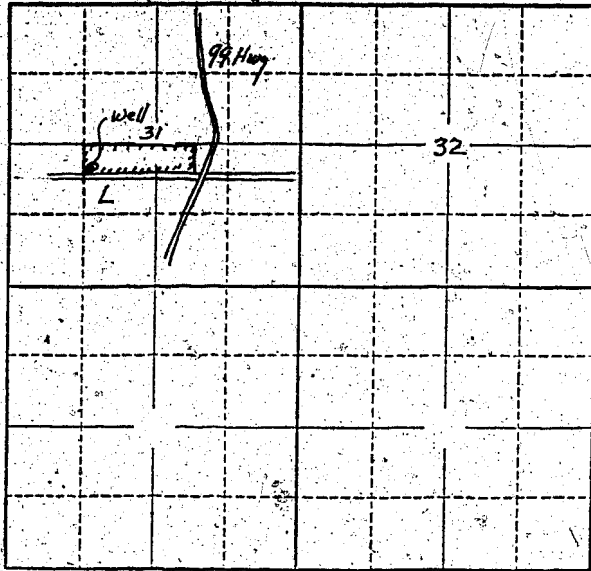

Locate well and acreage of irrigated land on plat.  
Scale: 2" = 1 Mile

STATE OF OREGON

County of Marion } ss.

I, B. Lytle Runge being first duly sworn, do hereby certify that I have read the foregoing Registration Statement and that all of the items therein contained are true to the best of my knowledge and belief.

B. Lytle Runge  
(Signature of Registrant)

Subscribed and sworn to before me this 16th day of April, 1958

My commission expires 12th June 1961 Wm. S. Bartholomew  
(Notary Public)

(SEAL)

**CERTIFICATE OF REGISTRATION**

STATE OF OREGON

County of Marion } ss.

This is to certify that the foregoing Registration Statement was received in the office of the State Engineer on the 16th day of April, 1958, at 9:45 o'clock A. M. and has been duly recorded in said office in Book No. 7 of Registration Statements on page GR-1365

Witness my hand this 20th day of October, 1958

Lewis A. Stanley  
(State Engineer)

By \_\_\_\_\_  
(Deputy)