

RECEIVED
MAR 28 1958
STATE ENGINEER
SALEM, OREGON

Registration No. GR. - 1440
Certificate No. GR. - 1586

Registration Statement

OF CLAIMANT OF RIGHT TO APPROPRIATE GROUND WATER

TO THE STATE ENGINEER OF OREGON:

I, FAIRVIEW FARMS INC

of Rt. 2 BOYHO TRAILDALE

County of MULT.

State of OREGON

do hereby make application for a certificate of registration as evidence of a right to appropriate ground water.

1. Source from which water is withdrawn is PUMP WELL #3
(Flowing well, pump well, infiltration trench, or tunnel)

2. Location is: 1/2 MILE WEST OF CITY OF FAIRVIEW
(Approximate distance and direction from nearest city or town)

and is more particularly described as follows:

(a) 3000 FT SW 1/4 INTERSECTION OF SEC 21-22-27-28
(Give distance and bearing to corner of section or other legal subdivision)

being within SW 1/4 of NE 1/4 of Sec. 28, Twp. 1N Rge. 3E
(Smallest legal subdivision) (N. or S.) (E. or W.)

or (b) within limits of recorded platted property, town or city:

in Lot _____, Block _____ of _____
(Name of plat or addition)

County of Multnomah
(If within city or town, give name)

3. Construction Work was begun on AUGUST 1954; was completed on AUG 2 - 1954
(Date) (Date)

and the ground water claimed was first used for the purposes set out below on SEPT 1954
(Date)

since which time the water has been used DOMESTIC AND IRRIGATION CONTINUOUSLY
(Continuously or intermittently) & MANUFACTURING
from SEPT 1954 to JAN 1958
(Date) (Date)

4. Quantity of water claimed and used is 200 gallons per minute; _____ acre feet per year.

5. Purpose or Purposes for which water is used
DOMESTIC AND IRRIGATION
(Domestic, irrigation, municipal, manufacturing, industrial, etc.)

6. Description of Well: Depth 151 feet. Type DRAINED
(Dug or drilled)
diameter 8" inches. Elevation of ground at well site 15 feet, mean sea level.
(As near as known)
Depth to water table 68 feet.

7. Capacity of Well: 200 g.p.m. with 9 feet drawdown.
300 g.p.m. with 16 feet drawdown.

Date of test AUG - 1958

If Flowing Well: Measured discharge _____ g.p.m. on _____
(Date)

Shut-in pressure at ground surface _____ lbs. per sq. in. on _____
(Date)

Water is controlled by _____
(Cap, valve, etc.)

8. Casing: (Give diameter, commercial specifications and depth below ground surface of each casing size.)

8 inch diameter from SURFACE to 151 feet
 inch diameter from to feet
 inch diameter from to feet
 inch diameter from to feet

Describe and show depth of shoe, plug, adapter, liner or other details:

9. Perforated Casings or Screens:

10 Rows PERFORATED from 139' to 149.75'
 (Number per foot and size of perforations, or describe screen)
 from to
 from to
 from to

10. Log of Well: (Describe each stratum or formation clearly, indicate if water bearing, and give thickness and depth as indicated.)

MATERIAL	Thickness (Feet)	Depth to Bottom (Feet)
CLAY & BOULDER	SURFACE	14
LARGE CEMENTED GRAVEL	14	30
GRAVEL WITH CLAY BINDER	30	52
CEMENTED GRAVEL & SAND & GRAVEL & CLAY	52	80
CEMENTED GRAVEL	80	139
LOOSE GRAVEL & SAND WATER BEARING	139	151

Township 1N Range 3E W.M.
North

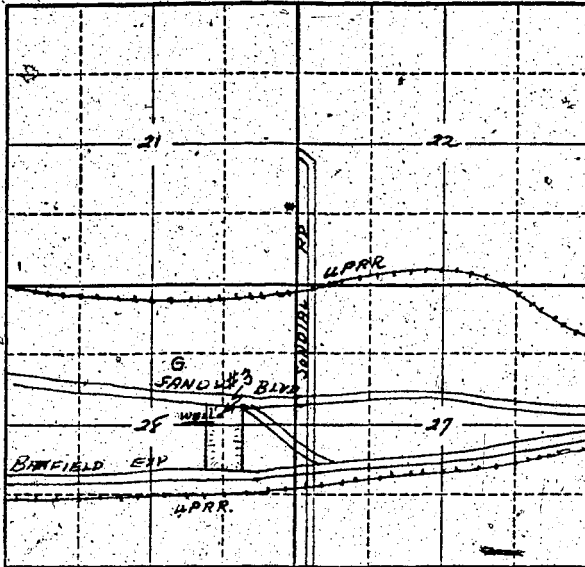

Locate well and acreage of irrigated land on plat.

Scale: 2" = 1 Mile

STATE OF OREGON

County of Multnomah } ss.

I, Sophie George, being first duly sworn, do hereby certify that I have read the foregoing Registration Statement and that all of the items therein contained are true to the best of my knowledge and belief.

Fairview Farms, Inc.
Secretary
(Signature of Registrant)

Subscribed and sworn to before me this 21st day of March, 1955

My commission expires 3-7-62 P. H. James
(Notary Public)

(SEAL)

CERTIFICATE OF REGISTRATION

STATE OF OREGON } ss.
County of Marion

This is to certify that the foregoing Registration Statement was received in the office of the State Engineer on the 18th day of April, 1958, at 4:00 o'clock P. M. and has been duly recorded in said office in Book No. 7 of Registration Statements on page GR-1586

Witness my hand this 1st day of December, 1958

Lewis A. Stanley
(State Engineer)

By _____ (Deputy)

GR-1586

\$25.00