

APR 18 1958
STATE ENGINEER
SALEM, OREGON

Registration Statement

OF CLAIMANT OF RIGHT TO APPROPRIATE GROUND WATER

TO THE STATE ENGINEER OF OREGON:

I, Clude Bradford
of Rt 2 Box 351 Milton-Freewater County of Grant
(Mailing address)

State of Oregon, do hereby make application for a certificate of registration as evidence of a right to appropriate ground water.

1. Source from which water is withdrawn is Pump Well #3
(Flowing well, pump well, infiltration trench, or tunnel)

2. Location is: 1/2 mile North West of Milton-Freewater
(Approximate distance and direction from nearest city or town)

and is more particularly described as follows:

(a) 345 feet North & 10 feet West of SE Corner of SW 1/4 of NW 1/4
(Give distance and bearing to corner of section or other legal subdivision)
being within SW 1/4 of NW 1/4 of Sec. 35, Twp. 6N, Rge. 35E
(Smallest legal subdivision) (N. or S.) (E. or W.)

or (b) within limits of recorded platted property, town or city:

in Lot _____, Block _____ of _____
(Name of plat or addition)

County of _____
(If within city or town, give name)

3. Construction Work was begun on 1909; was completed on 1909
(Date) (Date)

and the ground water claimed was first used for the purposes set out below on 1909
(Date)

since which time the water has been used Continuously
(Continuously or intermittently)

from June to October
(Date) (Date)

4. Quantity of water claimed and used is 350 gallons per minute; 1.2 acre feet per year.

5. Purpose or Purposes for which water is used Irrigation
(Domestic, irrigation, municipal, manufacturing, industrial, etc.)

6. Description of Well: Depth 40 feet. Type Dug
(Dug or drilled)
diameter 8'x8' inches. Elevation of ground at well site 900 feet, mean sea level.
(As near as known)
Depth to water table 20 feet.

7. Capacity of Well: _____ g.p.m. with _____ feet drawdown.
_____ g.p.m. with _____ feet drawdown.

Date of test _____

If Flowing Well: Measured discharge _____ g.p.m. on _____
(Date)

Shut-in pressure at ground surface _____ lbs. per sq. in. on _____
(Date)

Water is controlled by _____
(Cap, valve, etc.)

8. Casing: (Give diameter, commercial specifications and depth below ground surface of each casing size.)

8' x 8' inch diameter Concrete from 0 to 12 feet
 inch diameter from to feet
 inch diameter from to feet
 inch diameter from to feet

Describe and show depth of shoe, plug, adapter, liner or other details:

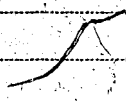

9. Perforated Casings or Screens:

(Number per foot and size of perforations, or describe screen)
 from to
 from to
 from to
 from to

10. Log of Well: (Describe each stratum or formation clearly, indicate if water bearing, and give thickness and depth as indicated.)

MATERIAL	Thickness (Feet)	Depth to Bottom (Feet)
top Soil	2'	2'
Gravel	12'	14'
Cement Gravel	26'	40'

If log of well is not available, give name and address of driller.

11. Infiltration Trench: Covered or open
Dimensions: Length ft. Minimum depth ft. Maximum depth ft.

Bottom width ft. Discharge g.p.m. Date of test

12. Tunnel: Type of lining

Dimensions:
(Length, course, and cross sectional size)

Position of water bearing stratum with reference to portal of tunnel

Log of tunnel: (Preceding table for log of well may be used, if desired. Give footage from portal and character of materials, as pertinent.)

13. Pumping Equipment:

(a) Pump 3" Pacific Cent Capacity 450 g.p.m.
(Make, type and size)

(b) Motor 5HP Electric
(Type and horsepower)

14. Location of area irrigated or to be irrigated, or place of use if for purposes other than irrigation.

Township North or South	Range E. or W. of Willamette Meridian	Section	Forty-acre Tract	Number Acres To Be Irrigated	Date of Reclamation
6N	35E	35	SW 1/4 - NW 1/4	10A	1909

15. If the ground water supply is supplemental to an existing water supply, identification of any application for a permit, permit, certificate or adjudicated right to appropriate water made or held by the registrant.

2 Acres Water right & Surplus Water

Township 6 N Range 35 E, W.M.
North

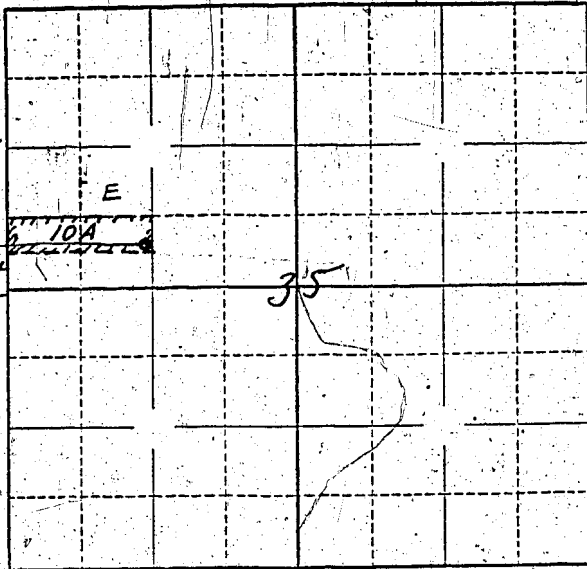

Well location
345 feet North & 100 feet
West of SE Corner
of SW 1/4 of NW 1/4
of Sec 35

Locate well and acreage of irrigated land on plat.

Scale: $\frac{1}{4}$ inch = 1 Mile

STATE OF OREGON

County of Marion } ss.

I, Blaine Bradfield, being first duly sworn, do hereby certify that I have read the foregoing Registration Statement and that all of the items therein contained are true to the best of my knowledge and belief.

Blaine Bradfield
(Signature of Registrant)

Subscribed and sworn to before me this 7 day of October, 1958.

My commission expires 1959 (Notary Public)

(SEAL)

CERTIFICATE OF REGISTRATION

STATE OF OREGON

County of Marion } ss.

This is to certify that the foregoing Registration Statement was received in the office of the State Engineer on the 26th day of April, 1958, at 5:00 o'clock P.M. and has been duly recorded in said office in Book No. 7 of Registration Statements on page GR-1295.

Witness my hand this 20th day of October, 1958.

Leuro A. Stanley
(State Engineer)

By _____ (Deputy)